



## Haydons Road, SW19

### £299,950

A one double bedroom ground floor Victorian conversion. The flat has a private rear garden, potential to further extend, subject to consent and is sold with no onward chain.

Located on the edge of South Park Gardens area, with nearby transport links to London from the Thames Link, District Line in Wimbledon town centre and Northern Line within a short distance away.

### Features

- One Double Bedroom
- Ground Floor
- Victorian Conversion
- Private Rear Garden
- Over 44 Square Meters
- No Onward Chain

# Haydons Road, London, SW19

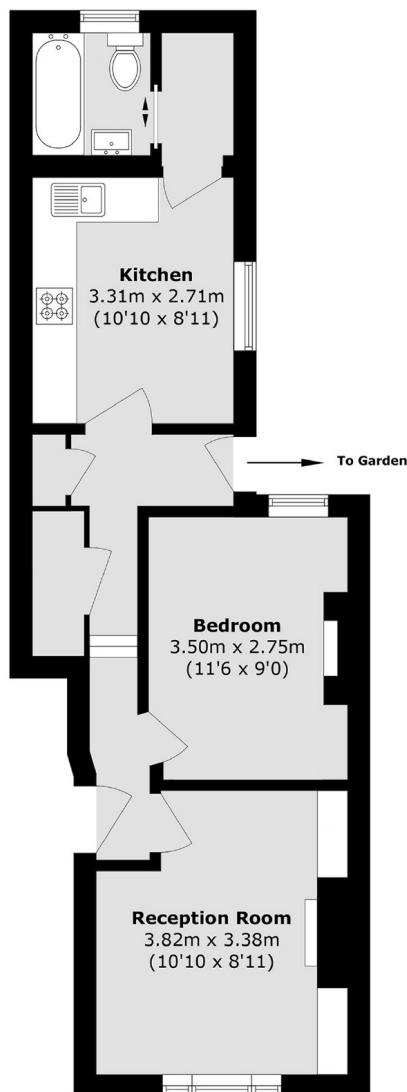

Total area (approx.): 44.8 sq. m (482.2 sq. ft)

## Dexters

Wimbledon  
12 The Broadway  
London  
SW19 1RF  
Sales  
020 8545 8580

Energy Rating: C. We aim to make our particulars both accurate and reliable. However they are not guaranteed; nor do they form part of an offer or contract. If you require clarification on any points then please contact us, especially if you're traveling some distance to view. Please note that appliances and heating systems have not been tested and therefore no warranties can be given as to their good working order.

 **RICS** | Regulated  
Estate Agent  
and Letting Agent

[dexters.co.uk](https://www.dexters.co.uk)