



Kirkwood Grove Medbourne, Milton Keynes, MK5
Milton Keynes

Offers Over
£210,000

Bedrooms: | Bathrooms: | Receptions:
2 | 1 | 1

Council Tax Band: B

Tenure: Leasehold

Property Type: Duplex Flat

- OPEN DAY 06/06/2026 - 1PM-3PM BY APPOINTMENT ONLY
- Spacious two bedroom duplex ground floor apartment
- Approx. 807 sq ft of accommodation across two floors
- Large and naturally bright living room
- Well proportioned kitchen diner
- Convenient downstairs WC plus family bathroom
- Allocated parking within a modern residential development
- Approx. 3 minute drive to Hazeley Academy and 2 minute drive to local Co op
- Approx. 9 minute drive to Milton Keynes Central railway station with direct London links
- EG1332



ETHAN GAULTER

exp

ex

ex

EG1332

OPEN DAY 06/06/2026 - 1PM-3PM BY APPOINTMENT ONLY

A spacious and well presented two bedroom duplex ground floor apartment located in the highly sought after Medbourne area of Milton Keynes, offering generous proportions, practical living space and excellent convenience for commuters and local amenities alike.

Set across two levels and offering approximately 807 sq ft of accommodation, this bright and versatile home feels far more substantial than many typical apartments, making it an excellent choice for first time buyers, downsizers, investors or those seeking extra space to work from home.

The accommodation comprises an impressive living room filled with natural light, a well proportioned kitchen diner with plenty of storage and workspace, a convenient downstairs WC, two excellent sized double bedrooms, and a family bathroom. The main bedroom is particularly spacious, whilst the second bedroom also offers comfortable double proportions, providing flexibility for guests, children or home working.

Positioned within a modern residential development with allocated parking, the property enjoys a peaceful setting whilst remaining exceptionally well connected. Hazeley Academy is approximately a 3 minute drive away, the local Co op is reachable within around 2 minutes by car, and Milton Keynes Central railway station is just a 9 minute drive away, ideal for commuters needing direct links into London and beyond.

A fantastic opportunity to secure a spacious home in one of Milton Keynes' most desirable locations.

Please note: some sellers may require an agreed sale protection product to provide greater certainty for both parties once a sale is agreed. Full details are available from the agent via the virtual tour link (orange button, top right), QR code, business card or email signature.

Photo Disclaimer:

Please note that some images have been digitally enhanced and may include virtual staging, edited finishes, or improvements such as changes to furniture layout, flooring, carpets, and landscaping to demonstrate how the property could look when fully furnished or presented. These images are for illustration purposes only and do not represent items included in the sale. If you are travelling from a distance, we recommend arranging a virtual viewing or contacting us prior to your journey to ensure everything is arranged for your visit

Early viewing is highly recommended to fully appreciate the space, character, and location on offer.



Approx Gross Internal Area
75 sq m / 807 sq ft

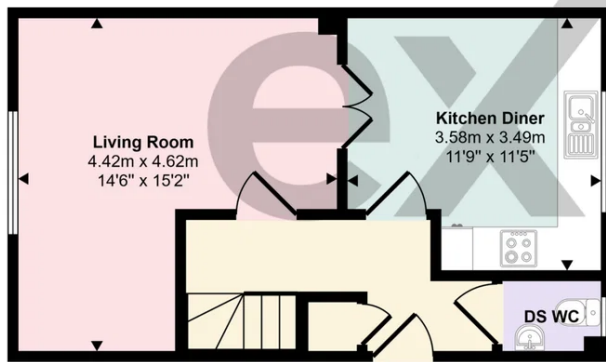

Ground Floor
Approx 37 sq m / 403 sq ft

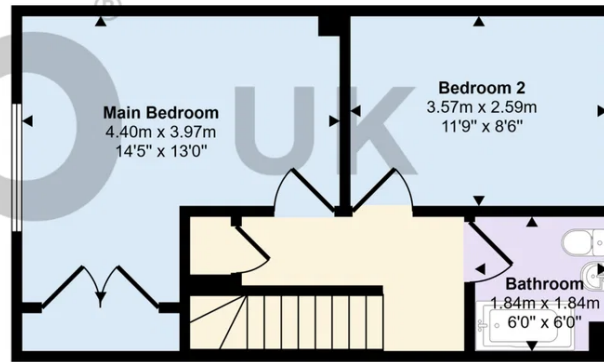

First Floor
Approx 37 sq m / 403 sq ft

This floorplan is only for illustrative purposes and is not to scale. Measurements of rooms, doors, windows, and any items are approximate and no responsibility is taken for any error, omission or mis-statement. Icons of items such as bathroom suites are representations only and may not look like the real items. Made with Made Snappy 360.



Ethan Gaulter
Local Estate Agent
01908 464 950
Ethan.Gaulter@exp.uk.com
<https://ethangaulter.exp.uk.com>

ETHAN GAULTER

