

100 Whipsnade Park Homes, Whipsnade, Dunstable, LU6 2LP
Asking Price £260,000



PRESTIGE MODEL PARK HOME, APPROX. 16 YEARS OLD, SET WITHIN THE SOUGHT AFTER VILLAGE OF WHIPSNADE | TWO BEDROOMS | OVER 50s SITE | OFF ROAD PARKING.

Positioned within the charming village of Whipsnade, on the Bedfordshire and Hertfordshire borders, this beautifully presented two bedroom Prestige model park home offers peaceful countryside living within an established and friendly over 50s community.

Whipsnade is renowned for its picturesque setting on the edge of the stunning Chiltern Hills, with the breathtaking Dunstable Downs just moments away, offering scenic walking routes, panoramic views and an abundance of open countryside. The village is also home to the world famous Whipsnade Zoo, one of the largest conservation zoos in the UK.

Entering through the front door, you are welcomed into a well equipped kitchen featuring integrated appliances including a fridge, washing machine and dishwasher. The property then opens into a bright and spacious living and dining area, thoughtfully designed to create a welcoming central space for relaxing and entertaining, with access to the front via french doors. Additional features include an electric fireplace, newly fitted wooden flooring, double glazing and fibre broadband availability. The kitchen also benefits from a gas stove and side access leading to the garden via steps with a handrail.

GROUND FLOOR
58.3 sq.m. (628 sq.ft.) approx.

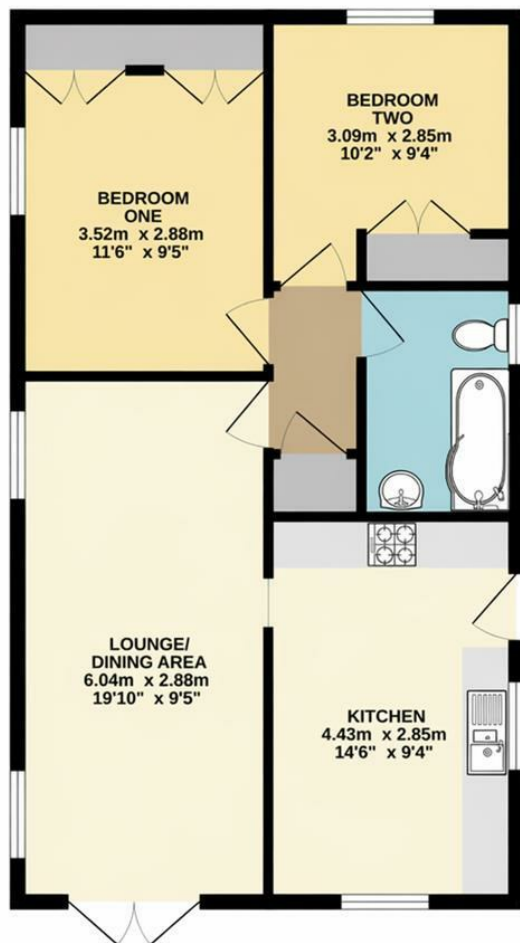

TOTAL FLOOR AREA : 58.3 sq.m. (628 sq.ft.) approx.

Whilst every attempt has been made to ensure the accuracy of the floorplan contained here, measurements of doors, windows, rooms and any other items are approximate and no responsibility is taken for any error, omission or mis-statement. This plan is for illustrative purposes only and should be used as such by any prospective purchaser. The services, systems and appliances shown have not been tested and no guarantee as to their operability or efficiency can be given.
Made with Metropix 6/2025



20 West Street
Dunstable
Bedfordshire
LU6 1SX
01582 661112
sales@robinsons-estates.co.uk
<https://www.robinsons-estates.co.uk>

