



Connells

Ramsthorn Close
Swindon



Property Description

Attractive and well-presented four-bedroom detached home, set within the ever-popular Woodhall Park area of North Swindon. Ideally positioned for local amenities, well-regarded schools and the Orbital Shopping Centre, the location offers both convenience and everyday comfort.

The accommodation begins with a welcoming entrance hall leading to a cloakroom and a spacious lounge, ideal for relaxing or entertaining. To the rear is a newly fitted high-gloss kitchen, complete with integrated appliances and finished to a modern standard.

Upstairs, there are four well-proportioned bedrooms, three of which are doubles, complemented by a stylish contemporary family bathroom.

Externally, the property benefits from a front garden, driveway and garage, while to the rear is a generous, private garden enjoying open outlooks and pleasant views – ideal for outdoor use throughout the year.

Ground Floor Accommodation Entrance Hall

Double glazed door to side aspect. Door to kitchen, cloakroom, lounge diner and garage. Radiator

Cloakroom

Obscure double glazed window to front aspect. Two piece suite comprising of, wash hand basin and low level WC. Partially tiled to water sensitive areas. Radiator.

Lounge/Diner

17' x 17' (5.18m x 5.18m)

Double glazed window to rear aspect. Double glazed sliding doors to rear garden. Stairs rising to the first floor accommodation. Radiator.

Kitchen

13' 11" x 6' (4.24m x 1.83m)

Double glazed window to the front aspect. Double glazed door to side aspect. Fully fitted modern kitchen with a range of wall and base units with work surfaces over, sink with drainer, tiled splashbacks, integrated under counter fridge freezer, oven, four ring electric hob and cooker hood, boiler

First Floor Accommodation First Floor Landing

Double glazed window to side aspect, loft access, airing cupboard. Access to all bedrooms and family bathroom

Bedroom One

11' x 8' (3.35m x 2.44m)

Double glazed window to rear, built in wardrobes, radiator

Bedroom Two

9' x 10' (2.74m x 3.05m)

Double glazed bay window to front, radiator

Bedroom Three

11' x 7' (3.35m x 2.13m)

Double glazed window to rear, built in wardrobes, radiator

Bedroom Four

6' x 5' (1.83m x 1.52m)

Double glazed window to front, radiator

Bathroom

Double glazed window to side, panelled bath with mixer taps, wash hand basin with vanity unit, tiled walls, shave point, radiator

External Features

Garden

Fenced and walled boundaries. Laid to lawn. Shed.

Parking

Parking to the front of the property.

Garage

16' 11" x 8' 3" (5.16m x 2.51m)

Up and over door. Power and light.







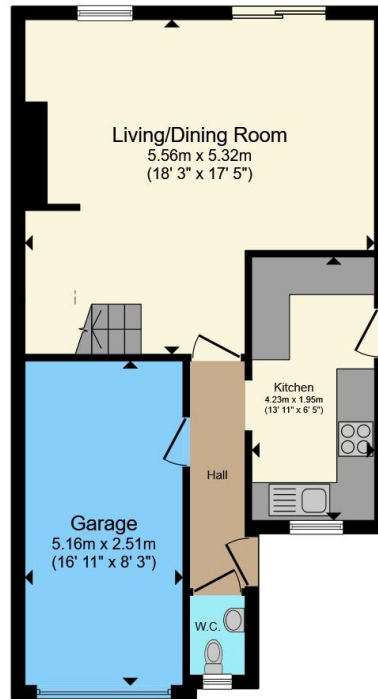

Ground Floor

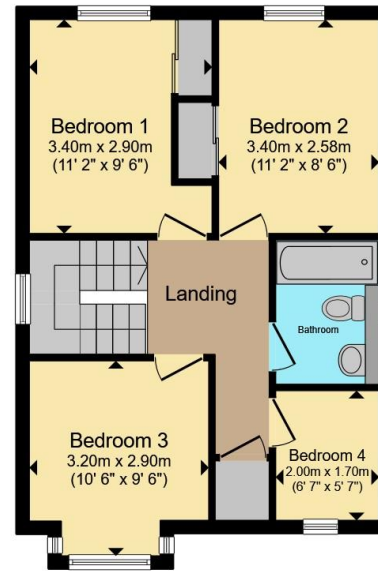

First Floor

Total floor area 98.2 m² (1,057 sq.ft.) approx

This floor plan is for illustrative purposes only. It is not drawn to scale. Any measurements, floor areas (including any total floor area), openings and orientation are approximate. No details are guaranteed, they cannot be relied upon for any purpose and they do not form part of any agreement. No liability is taken for any error, omission or misstatement. A party must rely upon its own inspection(s). Powered by www.propertybox.io



To view this property please contact Connells on

T 01793 708050
E swindonnorth@connells.co.uk

Unit B11 North Swindon District Centre Thamesdown Drive
 SWINDON SN25 4AN

EPC Rating: E Council Tax
 Band: D

Tenure: Freehold

view this property online connells.co.uk/Property/SDN314513



1. MONEY LAUNDERING REGULATIONS Intending purchasers will be asked to produce identification documentation at a later stage and we would ask for your co-operation in order that there will be no delay in agreeing the sale. 2. These particulars do not constitute part or all of an offer or contract. 3. The measurements indicated are supplied for guidance only and as such must be considered incorrect. Potential buyers are advised to recheck measurements before committing to any expense. 4. We have not tested any apparatus, equipment, fixtures, fittings or services and it is in the buyers interest to check the working condition of any appliances.

Connells Residential is registered in England and Wales under company number 1489613, Registered Office is Cumbria House, 16-20 Hockliffe Street, Leighton Buzzard, Bedfordshire, LU7 1GN. VAT Registration Number is 500 2481 05.

See all our properties at www.connells.co.uk | www.rightmove.co.uk | www.zoopla.co.uk

Property Ref: SDN314513 - 0002