



CAMBERWELL NEW ROAD, SE5

£525,000

Private entrance
Split-level
Newly renovated throughout
Share of freehold
No onward chain
Excellent transport links



ABOUT THE PROPERTY

This beautifully renovated split-level home offers three spacious double bedrooms and stylish contemporary living throughout. Flooded with natural light, the impressive open plan reception room features a modern shaker-style kitchen and striking floor-to-ceiling windows. The property also benefits from a luxurious family bathroom, private entrance, a brand new 999 year lease, and is offered to the market with no onward chain.

Ideally located on Camberwell New Road and moments from Kennington Park and Myatt's Fields Park. Oval underground station provides excellent transport links into central London and the City. Camberwell's vibrant restaurants, cafés, and pubs are also nearby.



STEP INSIDE CAMBERWELL NEW ROAD

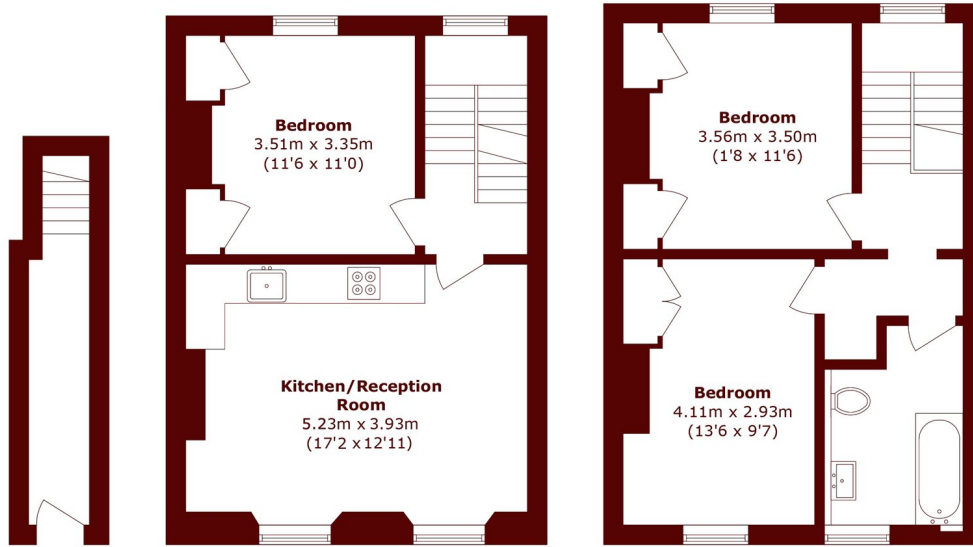

Ground Floor

First Floor

Second Floor

Total area (approx.): 84.0 sq. m (904.1 sq. ft)

Kennington
020 7587 1533

Energy Rating: D We aim to make our particulars both accurate and reliable. However, they are not guaranteed; nor do they form part of an offer or contract. If you require clarification on any points then please contact us, especially if you're traveling some distance to view. Please note that appliances and heating systems have not been tested and therefore no warranties can be given as to their good working order

**MARSH &
PARSONS**