

FOR SALE

By Auction £50,000

Isambard Brunel Road, Portsmouth PO1 2RX

bernards THE ESTATE AGENTS

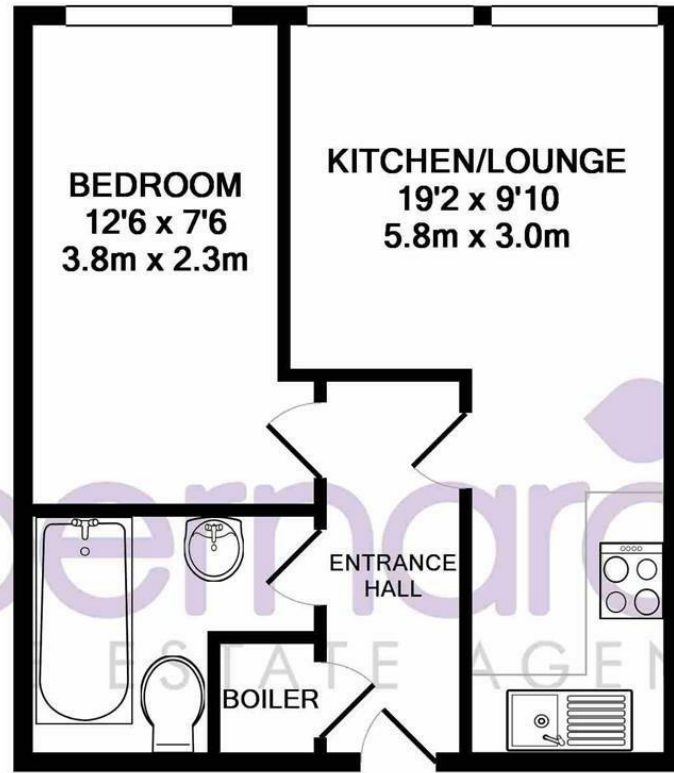

Whilst every attempt has been made to ensure the accuracy of the floor plan contained here, measurements of doors, windows, rooms and any other items are approximate and no responsibility is taken for any error, omission, or mis-statement. This plan is for illustrative purposes only and should be used as such by any prospective purchaser. The services, systems and appliances shown have not been tested and no guarantee as to their operability or efficiency can be given
Made with Metropix ©2016

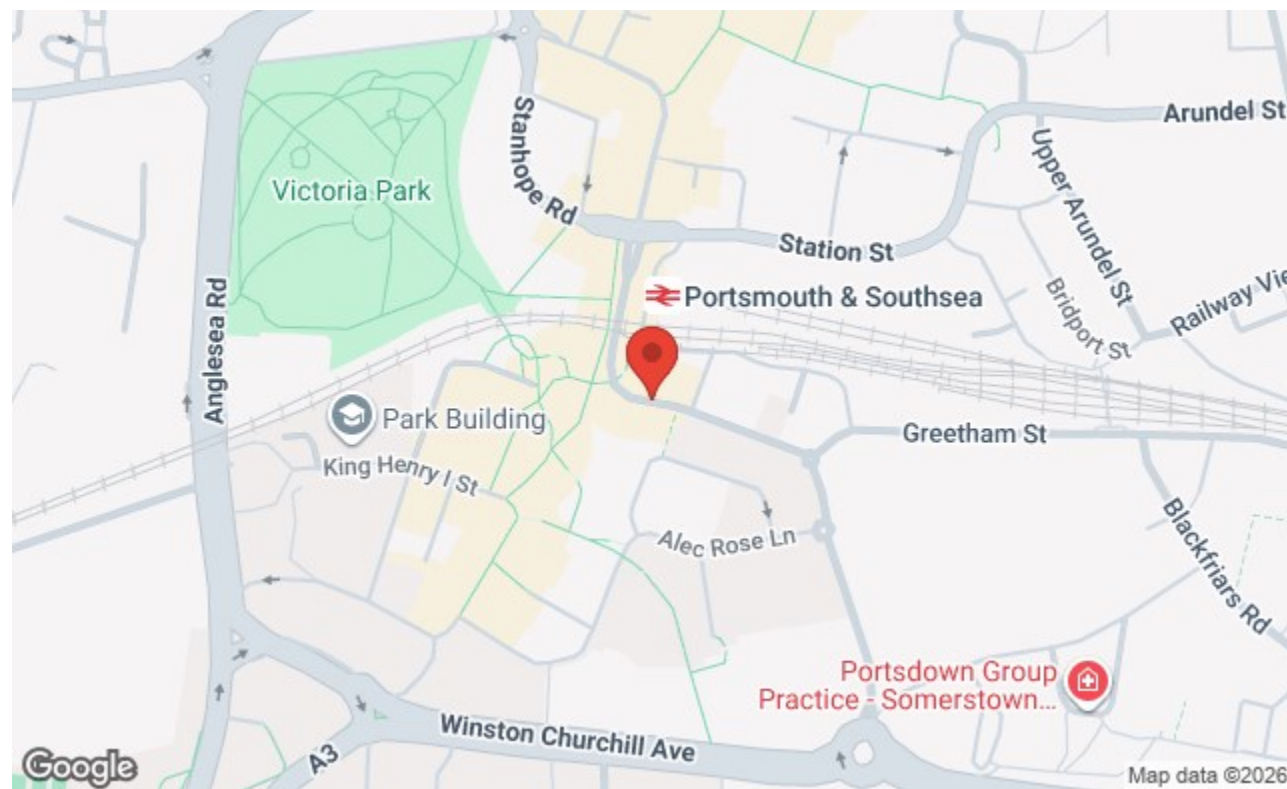

129 London Road, Portsmouth, Hampshire, PO2 9AA
t: 02392 728090

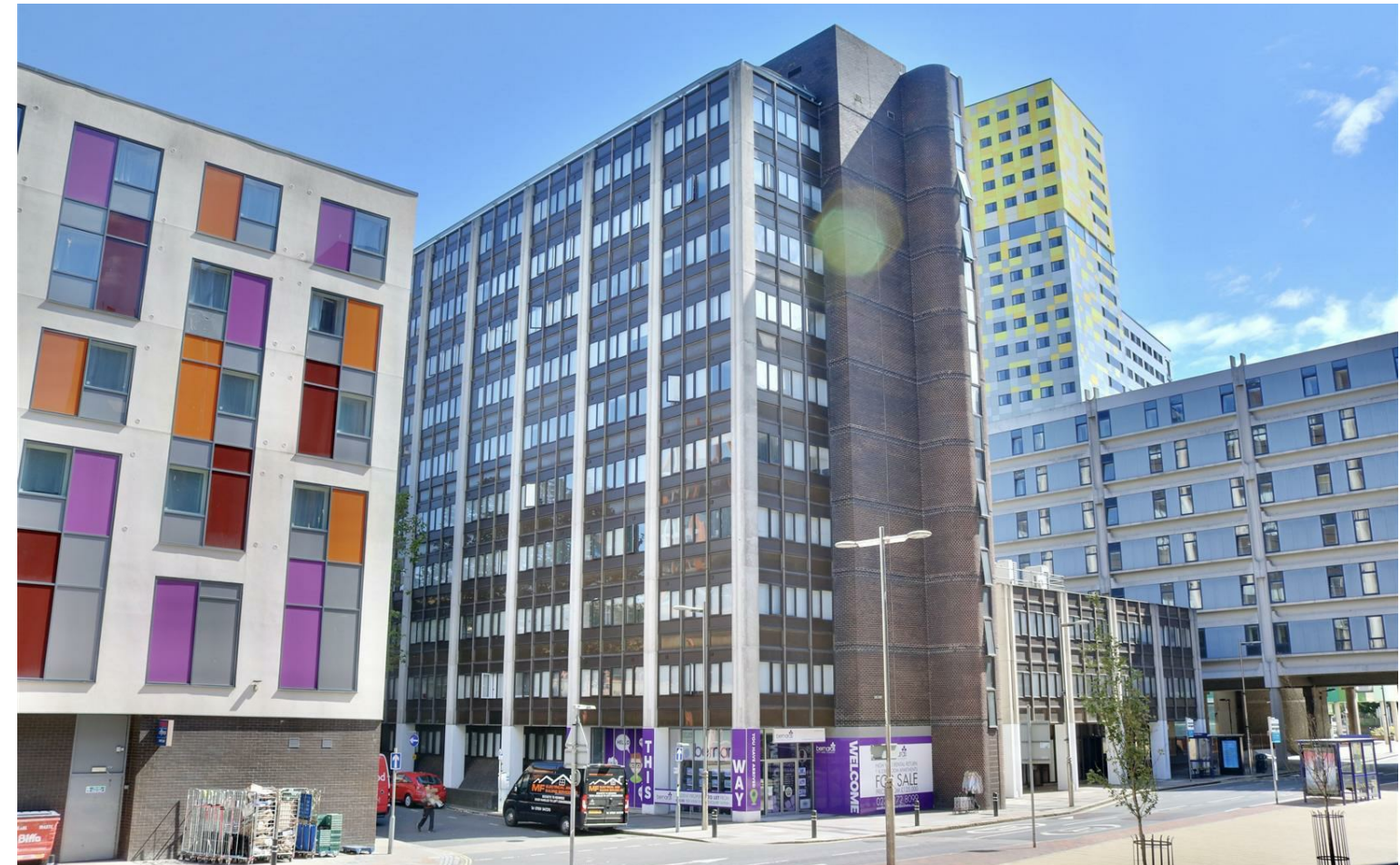

1 bed 1 bath 1 living area

HIGHLIGHTS

- ONE BEDROOM APARTMENT
- CENTRAL LOCATION
- NO FORWARD CHAIN
- EXCELLENT INVESTMENT
- MODERN KITCHEN
- SUBJECT TO RESERVE PRICE
- LIFT ACCESS
- CLOSE TO TRAIN STATION
- T&C's APPLY
- LONG LEASE REMAINING

Sold via Secure Sale online bidding. Terms & Conditions apply. Starting Bid £50,000

We are delighted to welcome to the market this modern one bedroom flat in the sought after location of Central Portsmouth. Enterprise House is a development of apartments which boast a high quality modern finish throughout, with high gloss kitchens and contemporary bathrooms.

The location is a stones throw from Portsmouth's main train station and

is in walking distance to the University of Portsmouth, city centre and the popular Guildhall Walk strip of bars and restaurants.

Situated perfectly for students or professionals making it the ideal investment opportunity.

Call today to arrange a viewing

02392 728090

www.bernardsestates.co.uk



PROPERTY INFORMATION

KITCHEN/LOUNGE

19'2" x 9'10" (5.84m x 3.00m)
Lounge space with kitchenette area consisting of a range of matching, high gloss wall and base units with plumbing for washing machine, hob and oven, extractor fan overhead, stainless steel sink and drainer unit, space for fridge freezer.

BEDROOM

12'6" x 7'6" (3.81m x 2.29m)
Bedroom consisting of carpet flooring, matte painted walls, radiator to wall, double glazed windows

BATHROOM

High quality modern bathroom suite comprising of low level w/c and hand wash basin, bath with shower over and glass shower screen, splash-back tiling to walls, chrome heated towel rail.

PORTSMOUTH COUNCIL TAX

The local authority is Portsmouth City Council.

BAND : A £1,453.95

LEASEHOLD INFORMATION

Lease Length: Circa 117 Years
Ground Rent : £250 p/a
Service Charge : £1,716 p/a
Please note that Bernard's Estate Agents have not checked or verified the lease terms or the service charge/ground rent costs. The information provided above has been provided to us from the Seller. Your solicitor will check all of the above during the conveyancing process and you should only rely on information provided by them when making the final decision as to whether to buy any leasehold property.

CONVEYANCING

Choosing the right conveyancing solicitor is extremely important to ensure that you obtain an effective yet cost-efficient solution. The lure of supposedly cheaper on-line "conveyancing warehouse" style services can be very difficult to ignore but this is a route fraught with problems that we strongly urge you to avoid. A local, established and experienced conveyance will safeguard your interests and get the job done in a timely manner. Bernard's can recommend several local firms of solicitors who have the necessary local knowledge and will provide a personable service. Please ask a member of our sales team for further details.

MORTGAGE ADVISOR

We offer financial services here at Bernard's. If you would like to review your current Agreement In Principle or are yet to source a lender, we have a number of experienced Financial Advisors who will be happy to help.

ANTI-MONEY LAUNDERING

Bernard's Estate agents have a legal obligation to complete anti-money laundering checks. The AML check should be completed in branch. Please call the office to book an AML check if you would like to make an offer on this property. Please note the AML check includes taking a copy of the two forms of identification for each purchaser. A proof of address and proof of name document is required. Please note we cannot put forward an offer without the AML check being completed

AUCTIONEER'S COMMENTS

Pattinson Auction are working in Partnership with the marketing agent on this online auction sale and are referred to below as 'The Auctioneer'.

This auction lot is being sold either under conditional (Modern) or unconditional (Traditional) auction terms and overseen by the auctioneer in partnership with the marketing agent.

The property is available to be viewed strictly by appointment only via the Marketing Agent or The Auctioneer. Bids can be made via the Marketing Agents or via The Auctioneers website.

Please be aware that any enquiry, bid or viewing of the subject property will require your details being shared between both any marketing agent and The Auctioneer in order that all matters can be dealt with effectively.

The property is being sold via a transparent online auction.

In order to submit a bid upon any property being marketed by The Auctioneer, all bidders/buyers will be required to adhere to a verification of identity process in accordance with Anti Money Laundering procedures. Bids can be submitted at any time and from anywhere.

Our verification process is in place to ensure that AML procedure are carried out in accordance with the law.

A Legal Pack associated with this particular property is available to view upon request and contains details relevant to the legal documentation enabling all interested parties to make an informed decision prior to bidding. The Legal Pack will also outline the buyers' obligations and sellers' commitments. It is strongly advised that you seek the counsel of a solicitor prior to proceeding with any property and/or Land Title purchase.

Auctioneers Additional Comments

In order to secure the property and ensure commitment from the seller, upon exchange of contracts the successful bidder will be expected to pay a non-refundable deposit equivalent to 5% of the purchase price of the property. The deposit will be a contribution to the purchase price. A non-refundable reservation fee of up to 6% inc VAT (subject to a minimum of 6,000 inc VAT) is also required to be paid upon agreement of sale. The Reservation Fee is in addition to the agreed purchase price and consideration should be made by the purchaser in relation to any Stamp Duty Land Tax liability associated with overall purchase costs.

Both the Marketing Agent and The Auctioneer may believe necessary or beneficial to the customer to pass their details to third party service suppliers, from which a referral fee may be obtained. There is no requirement or indeed obligation to use these recommended suppliers or services.



Energy Efficiency Rating		Current	Potential
Very energy efficient - lower running costs			
(92-100) A			
(81-91) B			
(69-80) C			
(55-68) D		59	59
(39-54) E			
(21-38) F			
(1-20) G			
Not energy efficient - higher running costs			
England & Wales		EU Directive 2002/91/EC	



Call today to arrange a viewing
02392 728090
www.bernardsestates.co.uk

