

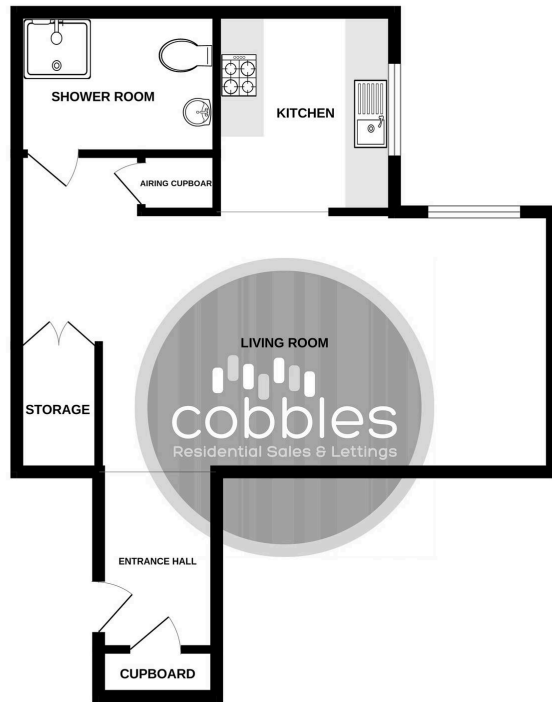

GROUND FLOOR
215 sq.ft. (20.0 sq.m.) approx.



69 York Road, Guildford

Studio apartment on York Road, Guildford. Open-plan living/bedroom, separate kitchen and bathroom. Strong rental history. Close to town centre, amenities and transport. Great investment opportunity.

Council Tax band: B

Tenure: Leasehold

EPC Energy Efficiency Rating: E

EPC Environmental Impact Rating: E

- Studio Apartment
- Chain Free
- Prime Investment Opportunity
- Town Centre Location

FOR ILLUSTRATIVE PURPOSES ONLY:

TOTAL FLOOR AREA: 215 sq.ft. (20.0 sq.m.) approx.

Whilst every attempt has been made to ensure the accuracy of the floorplan contained here, measurements of doors, windows, rooms and any other items are approximate and no responsibility is taken for any error, omission or mis-statement. This plan is for illustrative purposes only and should be used as such by any prospective purchaser. The services, systems and appliances shown have not been tested and no guarantee as to their operability or efficiency can be given.
Made with Metropix ©2026

