



Price

£220,000

Leasehold

2x  1x  1x 

**Patricia Gardens, Sutton,
Surrey, SM2**

OVER 60?

Secure this property
for up to **59% less!**

cubitt & west
Helping you move forwards



Main features

- Chain free retirement flat
- Recently refurbished kitchen and living areas
- Private patio area
- Lovely communal gardens, great for socialising with other residents
- Residents off road parking



Accommodation

GROUND FLOOR

Entrance Hall

Lounge: 13'9 x 12'7 (4.19m x 3.84m)

Kitchen: 13'0 x 6'3 (3.97m x 1.91m)

Bedroom 1: 14'1 x 10'7 (4.30m x 3.23m)

Bedroom 2: 13'3 x 7'8 (4.04m x 2.34m)

Bathroom: 7'0 x 6'6 (2.14m x 1.98m)

OUTSIDE

- Private Patio Area
- Communal Gardens
- Off Road Parking



Ground Floor
Approx. 59.7 sq. metres (642.8 sq. feet)

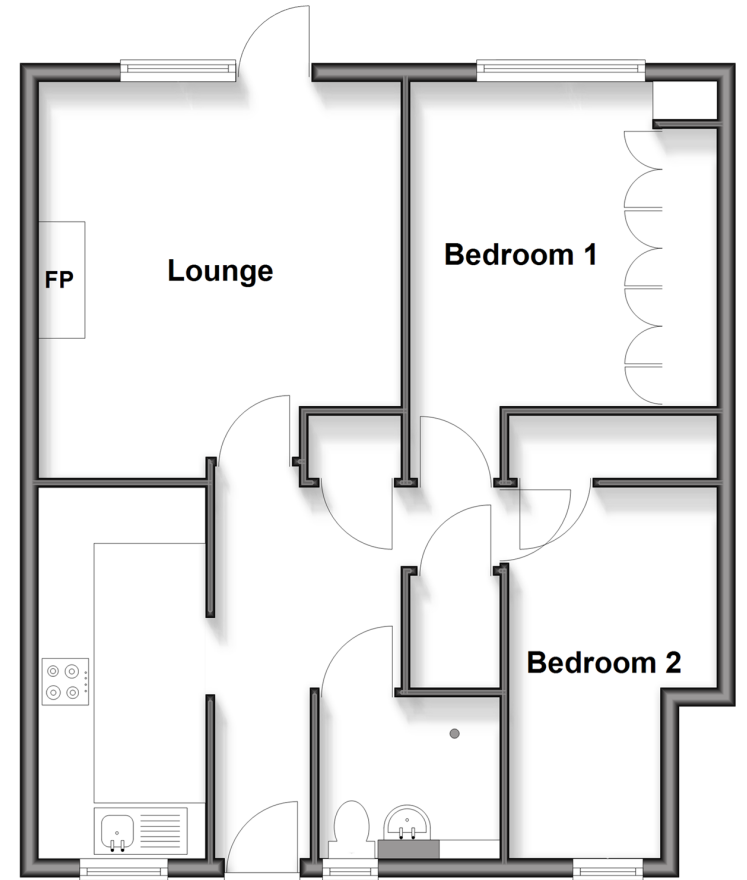

Call Sutton - 020 8661 0330 ■ cubittandwest.co.uk

- Legal advice should be taken to verify fixtures/fittings, planning, alterations and/or lease details
- Appliances & services are untested, dimensions are approximate and floor plans are not to scale
- Through a Homewise Home For Life Plan people aged 60+ can secure this property for up to 50% less, by purchasing a Lifetime Lease.



22018270/20250925/KWK/JB