



# READINGS

www.readingspropertygroup.com



Armson Avenue  
Kirby Muxloe, Leicester, LE9 2DB

**£375,000**



## Armson Avenue

Kirby Muxloe, Leicester, LE9 2DB

Situated in the heart of this highly sought-after village, this spacious detached bungalow occupies a generous plot and offers flexible living accommodation with two or three bedrooms.

The property has been well maintained over the years and provides an excellent opportunity for a new owner to modernise and make it their own. Offered for sale with no onward chain, the accommodation comprises an entrance hall, spacious lounge, kitchen, dining room, two bedrooms and a shower room. The property benefits from a driveway, garage, front garden and an attractive rear garden.

Properties in this location are always in demand, so early viewing is highly recommended to avoid disappointment.

### Property Information

Tenure: Freehold

Local Authority: Blaby

Council Tax Band: D

Services: The property is offered to the market with all mains services and gas-fired central heating.

Multiple Options for Broadband/mobile phone signal.

Flood Risk: None

Annual Estate Management Charge If Applicable: n/a

The property is being sold with Vacant Possession upon completion. **FIXTURES AND FITTINGS** - All the items mentioned in these sales details are to be included within the purchase price. **SERVICES** - None of the services, fitting or appliances (if any) heating installations, plumbing or electrical systems have been tested by the selling agents, neither have the telephone or television points.





### Anti Money Laundering

By law, we are required to carry out Anti-Money Laundering checks for all buyers and sellers. Once you instruct us to market your property, or once your offer has been accepted, a fee of £18 (including VAT) per person is payable to complete these checks.

For sellers, this fee must be paid before we can publish your property for sale, and for buyers, it's required before we can issue the memorandum of sale.

The fee is non-refundable and is paid directly to Landmark Information Group. We receive a portion of this fee for facilitating the verification process.

### Consumer Protection Legislation

These sales details have been written to conform to Consumer Protection Legislation. Whilst we endeavour to make our sales details accurate and reliable, if there is any point of particular importance to you, please contact the office and we will check the information for you, particularly if contemplating travelling some distance to view. Measurements are given in good faith and whilst believed to be accurate these should be checked by the purchaser for verification. The measurements are carried out in accordance with the RICS and ISVA code of measuring practice.



## Floor Plan

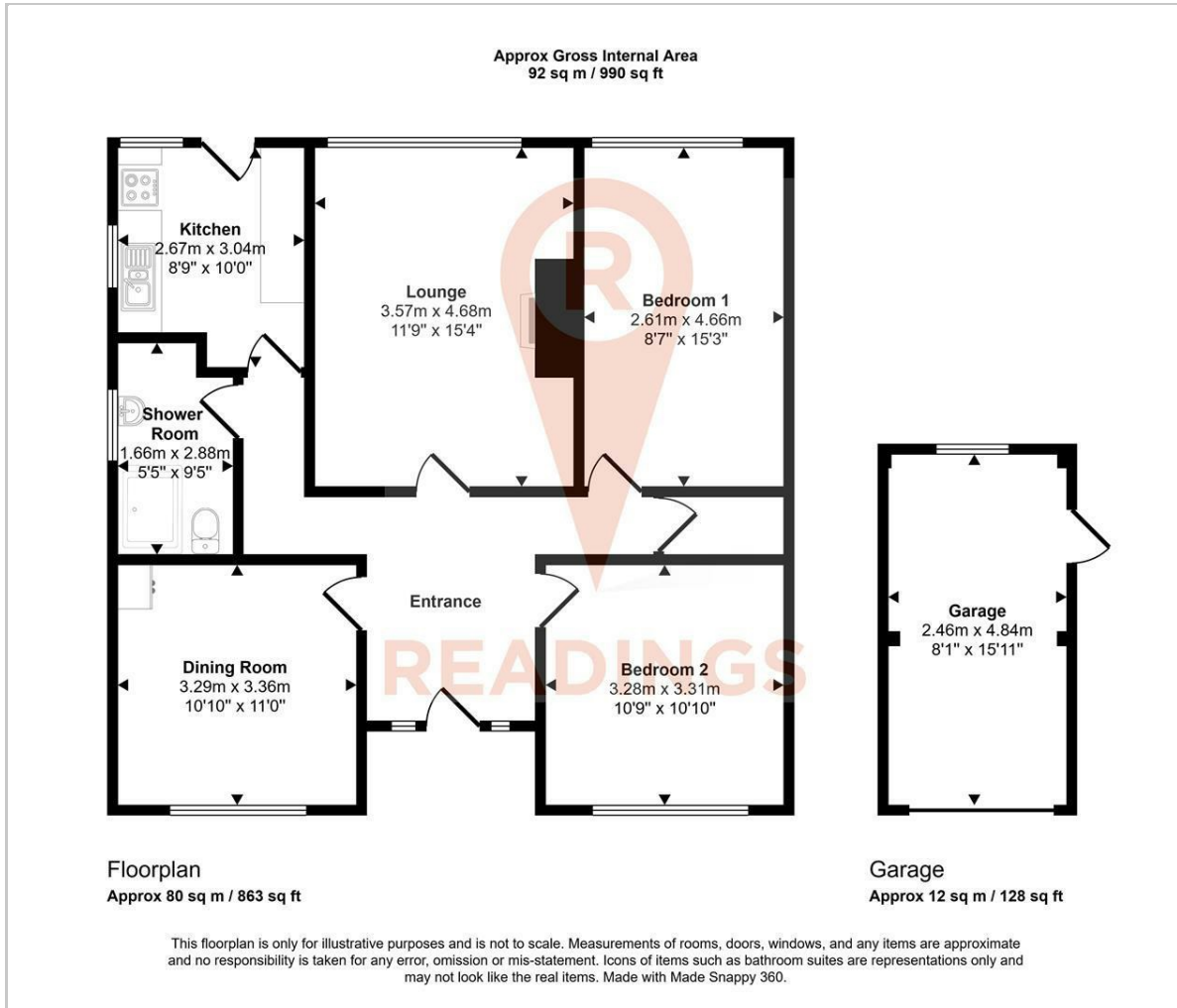

## Area Map

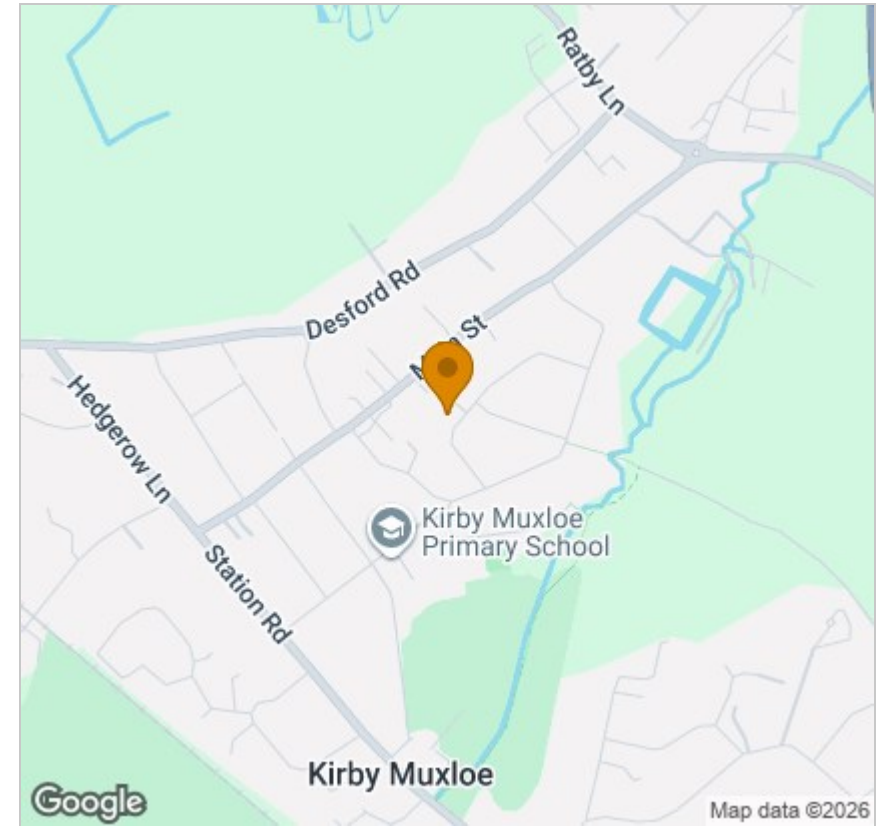

## Energy Efficiency Graph

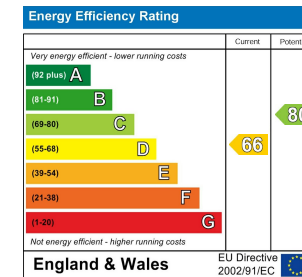

## Viewing

Please contact our Readings Sales Office on 0116 2227575 if you wish to arrange a viewing appointment for this property or require further information.