

## Seymour Road, Chiswick, W4

£5,000PCM (Deposit: £5,769)

4 3 2



Tax Band: F Furnished: Furnished Optional

Quote MG1175 for all enquiries

- 4 Double Bedrooms

3 Bathrooms (2 En-Suite)

- 2 Reception

Private Courtyard Garden

- Quiet Cul-de-Sac Location

Close to Chiswick High Road

- Underfloor Heating on ground floor

Ample storage throughout

- Short walk to Chiswick Park Underground & South Acton Overground

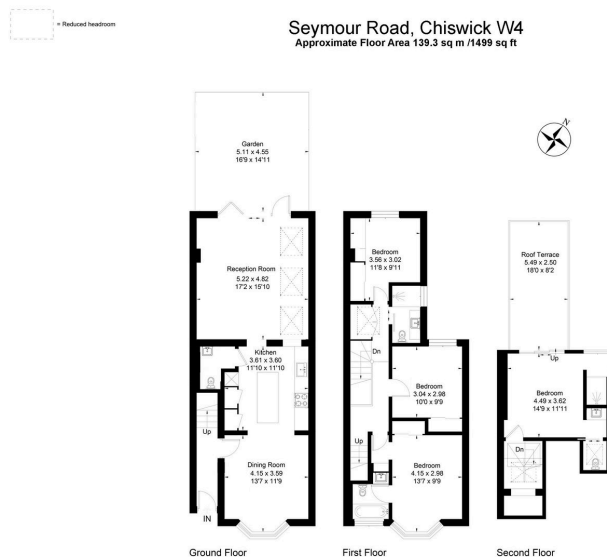

This plan has been created as a guide for layout purposes only. It is not drawn to scale unless specified. The locations of windows and doors are approximate. While every effort has been made to ensure the accuracy of this plan, please verify all dimensions, shapes, and compass bearings before making any decisions based on this information.

Beautifully presented throughout and measuring approximately 1,499 SqFt, this impressive four bedroom family home perfectly combines character features with modern living, positioned on a quiet residential non-through road moments from Chiswick High Road.

Arranged over three floors, the ground floor offers a separate dining room, stunning open-plan kitchen with central island, and an impressive 18ft x 15ft reception room with bi-fold doors leading onto a private decked garden. The first floor comprises three well-proportioned bedrooms, one with en suite facilities, alongside a modern family shower room and separate laundry area. Occupying the top floor is a superb principal suite with Juliet balcony, excellent storage and en suite shower room.