



JR
JOSHUA REED



JR
JOSHUA REED



JR
JOSHUA REED



JR
JOSHUA REED

2 Bed House - Terraced
located in

JR
JOSHUA REED
Estate Agents

59 Olvega Drive
 Buntingford
 SG9 9FJ

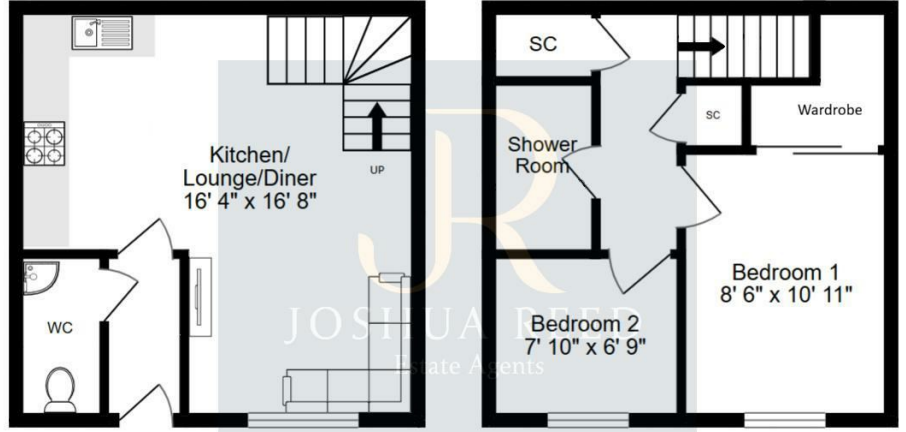

Total Floor Area: 529 Sqft
 All measurements are approximate and for display purposes only

Offers in excess of
£270,000
 CONTACT

23-27 Maidenhead Street
 Hertford
 Hertfordshire
 SG14 1DW

EMAIL

josh@joshua-reed.co.uk

TELEPHONE

01992 917388

www.joshua-reed.co.uk

SUMMARY

A beautifully presented, modern two bedroom cluster home nicely positioned in this cul-de-sac within walking distance to the Town Centre which offers an array of amenities. Finished to a high standard throughout, the accommodation offers an entrance porch, downstairs WC, modern gloss kitchen with integrated appliances that is open plan to the living and dining space. To the first floor are two good size bedrooms with built in wardrobes to the master, contemporary shower room, storage cupboard on the landing and access to loft space.

Additionally, the property benefits from gas central heating, UPVC double glazing, allocated parking space, secure residents bike store and children's play area nearby.

Contact Joshua Reed Estate Agents for more information and to arrange a viewing.

DIRECTIONS

Energy Efficiency Rating		Current	Potential
Very energy efficient - lower running costs			
(92 plus) A			
(81-91) B			
(69-80) C			
(55-68) D			
(39-54) E			
(21-38) F			
(1-20) G			
Not energy efficient - higher running costs			
England & Wales		EU Directive 2002/91/EC	