



jordan fishwick

Apt 602 Jefferson Place, Fernie Street, Manchester, M4 4BL

Tenanted @ £875pcm. Gross Yield 7.7%.

This 6th floor STUDIO apartment which is located in The Green Quarter close to Victoria Station is a great first time buyer or investment purchase, Entrance hall with deep storage cupboard, luxury bathroom with shower attachment and tiled walls and floor, the main reception room has laminate flooring, bed area and kitchen space with hob and sink unit. This room has a double glazed window and Juliet balcony doors. No Chain. MORTGAGE BUYERS WELCOME due to mortgage companies lending criteria amendments following the Building Safety Act 2022. Full Funding from Developer in Place.

Price £135,000

Viewing arrangements

Viewing strictly by appointment through the agent

245 Deansgate, Manchester, M3 4EN 0161 833 9499 opt 3

Entrance Hall

Deep storage cupboard housing hot water system and plumbing for washing machine

Bathroom

7'0" x 8'11"

A luxury bathroom with tiled walls and floor, chrome heated towel rail. The bath has a shower over it, wash hand basin and w.c

The Studio

this opeplan room has laminate flooring and electric heaters.

Kitchen

7'3" x 12'2"

double glazed window, wall and base units, sink, hob, dishwasher and fridge.

Bed Area

8'1" x 6'9"

recessed in the corner

Living Area

12'11" x 10'9"

Juliet balcony and T.V points

Additional Information

Service Charge £1,308.84 pa

Buildings Insurance £333.54p pa

Lease 150 Years from 2005

Ground Rent £250 pa

Agents Notes

To be able to purchase a property in the United Kingdom all agents have a legal requirement to conduct Identity checks on all customers involved in the transaction to fulfil their obligations under Anti Money Laundering regulations. We outsource this check to a third party and a charge will apply. Ask the branch for further details.

Disclaimer

IMPORTANT NOTE TO PURCHASERS: The lease, ground rent and service charges should all be checked via the solicitors for clarification. We endeavour to make our sales particulars accurate and reliable, however, they do not constitute or form part of an offer or any contract and none is to be relied upon as statements of representation or fact. The services, systems and appliances listed in this specification have not been tested by us and no guarantee as to their operating ability or efficiency is given. All measurements have been taken as guide to prospective buyers only, and are not precise. If floor plans were included, these may not be to scale and accuracy is not guaranteed. If you require clarification or further information on any points, please contact us.

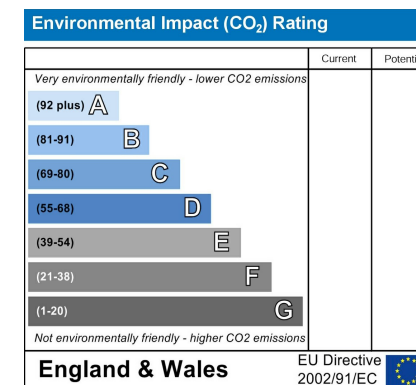
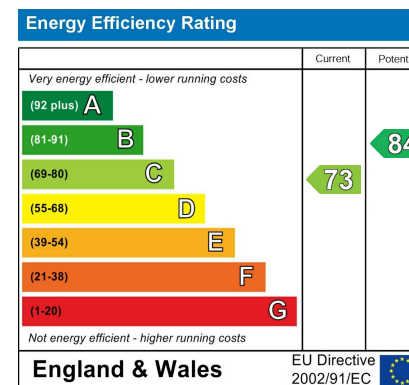



GROUND FLOOR

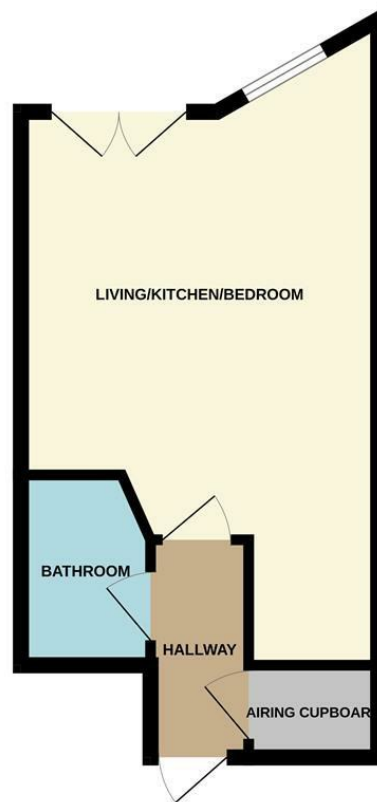

Measurements are approximate. Not to scale. Illustrative purposes only.
Made with Metropix ©2025



These particulars are believed to be accurate but they are not guaranteed and do not form a contract. Neither Jordan Fishwick nor the vendor or lessor accept any responsibility in respect of these particulars, which are not intended to be statements or representations of fact and any intending purchaser or lessee must satisfy himself by inspection or otherwise as to the correctness of each of the statements contained in these particulars. Any floorplans on this brochure are for illustrative purposes only and are not necessarily to scale.

Offices at: Chorlton, Didsbury, Disley, Hale, Glossop, Macclesfield, Manchester Deansgate, Manchester Whitworth Street, New Mills, Sale, Wilmslow and Withington

245 Deansgate, Manchester, M3 4EN

0161 833 9499 opt 3

manchester@jordanfishwick.co.uk

www.jordanfishwick.co.uk

