



 paulwallace

Montgomery Drive, Cheshunt, EN8 0LB |  
£385,000 | Freehold

## Montgomery Drive, Cheshunt, EN8 0LB

**\*\*CHAIN-FREE\*\*** A THREE-BEDROOM MID-TERRACED home, offering EXCELLENT POTENTIAL FOR MODERNISATION AND PERSONALISATION. The property features a spacious through lounge with large windows providing plenty of natural light, a fitted kitchen, three well-proportioned bedrooms and a family bathroom. To the rear is a generous mature garden with outbuilding, while the front offers OFF-STREET PARKING. Conveniently located close to local shops, schools, transport links and amenities, this property would make an ideal family home or investment opportunity.

### Key features

- **\*\*CHAIN-FREE\*\***
- Lounge
- Bathroom/WC
- Rear Garden
- 3 Bedrooms
- Kitchen
- Gas Central Heating
- Front Driveway

### Property Information

Tenure

Freehold

Council Tax

D

EPC Rating

D

Local Authority

Broxbourne Borough Council



**Paul Wallace Estate Agents**  
Brookfield Centre  
Cheshunt  
Hertfordshire  
EN8 0NN

01992 781100

cheshunt@paulwallace.co.uk

www.paulwallace.co.uk

Opening Times

Mon - Fri	9 am to 6:30 pm
Sat	9 am to 5:30 pm
Sun	Closed
Bank Hols	Closed

**paulwallace**  
estate agents

Cheshunts leading estate agent.  
Please get in touch for your free  
property valuation.







GROUND FLOOR  
414 sq.ft. (38.4 sq.m.) approx.

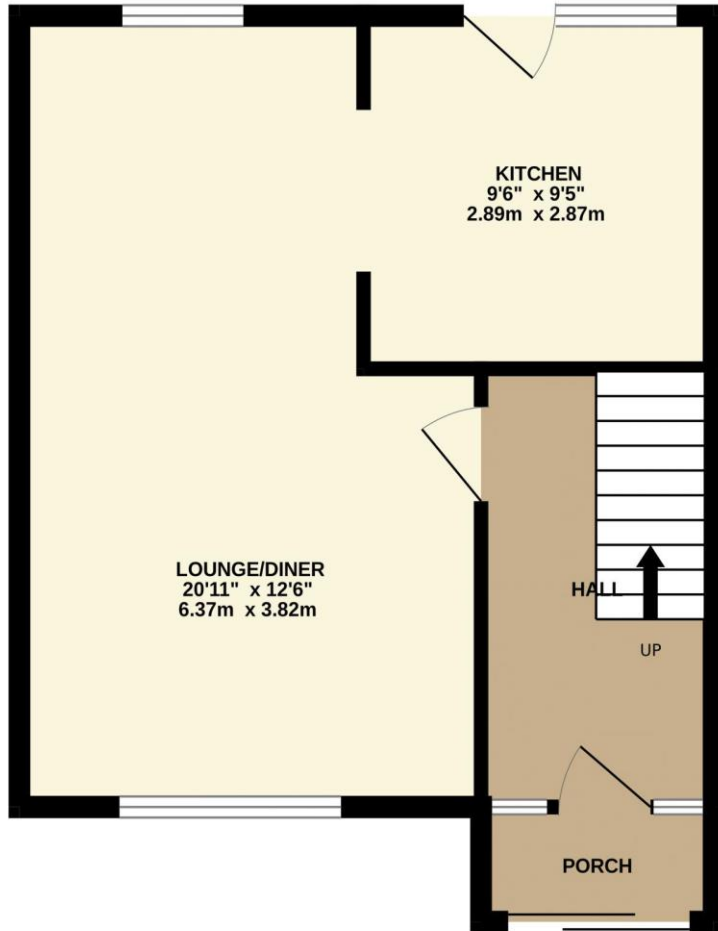

1ST FLOOR  
395 sq.ft. (36.7 sq.m.) approx.

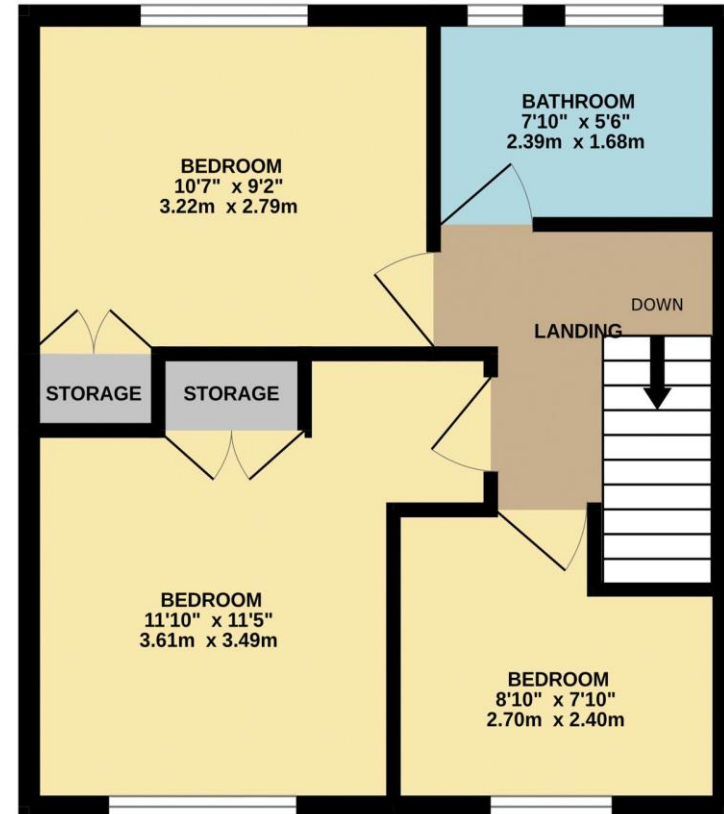

TOTAL FLOOR AREA : 808 sq.ft. (75.1 sq.m.) approx.

Whilst every attempt has been made to ensure the accuracy of the floorplan contained here, measurements of doors, windows, rooms and any other items are approximate and no responsibility is taken for any error, omission or mis-statement. This plan is for illustrative purposes only and should be used as such by any prospective purchaser. The services, systems and appliances shown have not been tested and no guarantee as to their operability or efficiency can be given.

Made with Metropix ©2026

