



## LISMORE BOULEVARD, NW9

£2,900 pcm

This large three bedroom apartment is situated on the upper floor of a well maintained development in the heart of Colindale. The property has wood flooring, two bathrooms and 24 hour concierge.

- Three Double Bedrooms
- Two Bathrooms
- Private Balcony
- 24 Hour Concierge
- Open Plan Kitchen
- Secure Parking

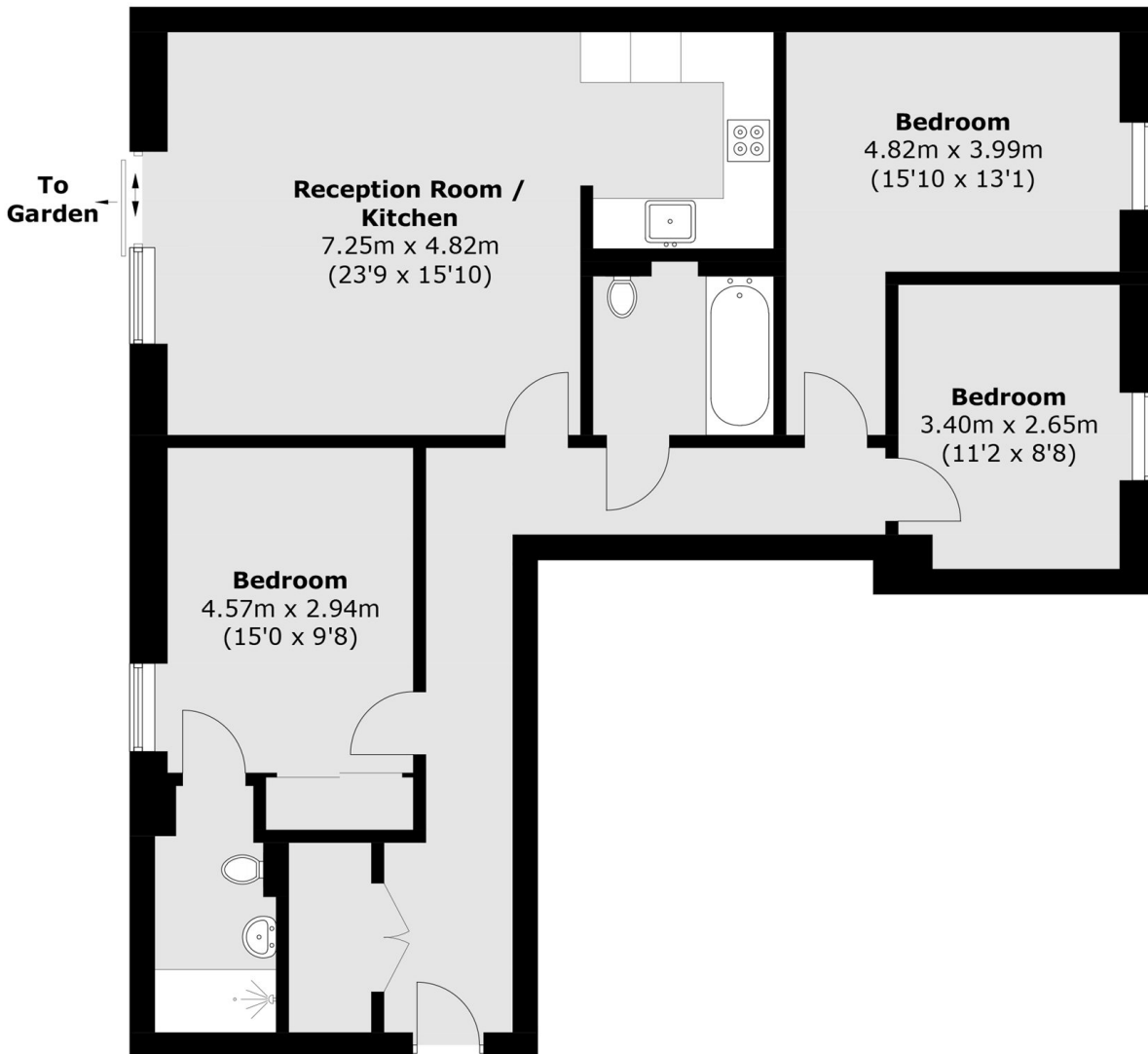

## First Floor

Total area (approx.): 95.7 sq. m (1030.1 sq. ft)

### LiFE RESIDENTIAL

203 Trentham Court, Victoria  
Road, London, W3 6BT  
Sales: 020 3668 1112  
Lettings: 020 3668 1111

Energy Rating: . We aim to make our particulars both accurate and reliable. However they are not guaranteed; nor do they form part of an offer or contract. If you require clarification on any points then please contact us, especially if you're traveling some distance to view. Please note that appliances and heating systems have not been tested and therefore no warranties can be given as to their good working order.