

RAINBOW REID



ESTATE AGENTS || LETTING AGENTS || PROPERTY MANAGEMENT



6 Cygnet Close , London, NW10 8TP

Located on the first floor of this modern purpose built block is this well presented two bedroom first floor apartment with parking that is being offered with no upper chain.

The property in full comprises: welcoming entrance hall, spacious living/dining room which is open plan to the kitchen. Two good size bedrooms, modern bathroom and a allocated off street parking.

Conveniently positioned within easy reach of both Neasden Station (Jubilee Line) and Stonebridge Park Station (Bakerloo Line), the property enjoys excellent transport links into central London, along with local amenities nearby.

The property has 93 years left on the lease.
Service charge: £195 per month
Council tax band C

£260,000

6 Cygnet Close

, London, NW10 8TP

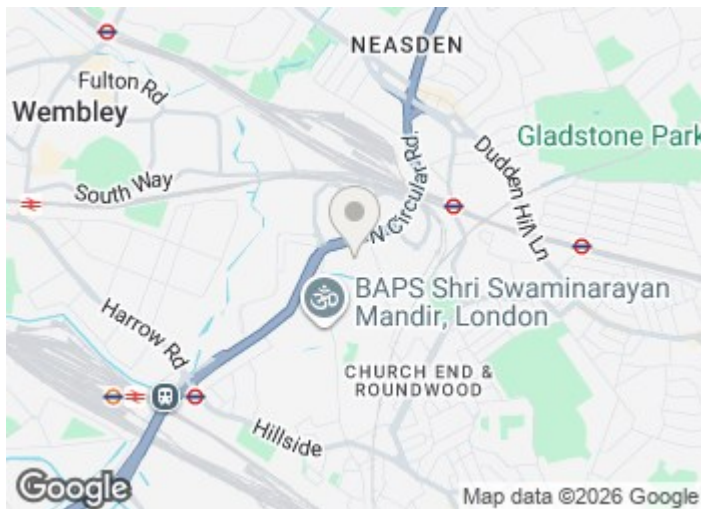

Directions



Floor Plan

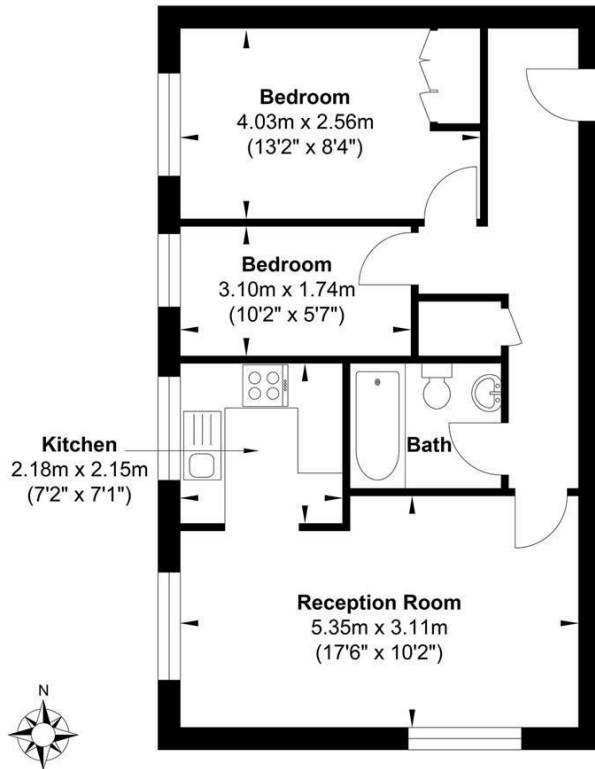

First Floor

Gross Internal Floor Area : 50.93 m2 ... 548.0 ft2

Whilst every attempt has been made to ensure the accuracy of the floor plan contained here, measurements of doors, windows, rooms and any other items are approximate and no responsibility is taken for any error, omission, or mis-statement. This plan is for illustrative purposes only and should be used as such by any prospective purchaser. The services, systems and appliances shown have not been tested and no guarantee as to their operability or efficiency can be given.

These particulars, whilst believed to be accurate are set out as a general outline only for guidance and do not constitute any part of an offer or contract. Intending purchasers should not rely on them as statements of representation of fact, but must satisfy themselves by inspection or otherwise as to their accuracy. No person in this firm's employment has the authority to make or give any representation or warranty in respect of the property.

