



## MOSTYN ROAD, SW9

£375,000

One Bedroom  
Third Floor  
Private Balcony  
Well Lit  
Bike storage  
Modern Build

@marshandparsons  
marshandparsons.co.uk

MARSH &  
PARSONS



# ABOUT THE PROPERTY

Positioned on the third floor of the popular Oval Quarter development, this large one bedroom apartment is well lit, attributed to its floor to ceiling windows, and access to a private balcony.

Located just a short walk from the beautiful Myatt's Field Park, this property is perfect for those who enjoy being surrounded by greenery and nature. With easy access to Brixton station (Victoria line), Oval station (Northern line), Loughborough Junction (Thameslink services) and Stockwell (Northern and Victoria lines) as well as a multitude of local bus services.



# STEP INSIDE MOSTYN ROAD

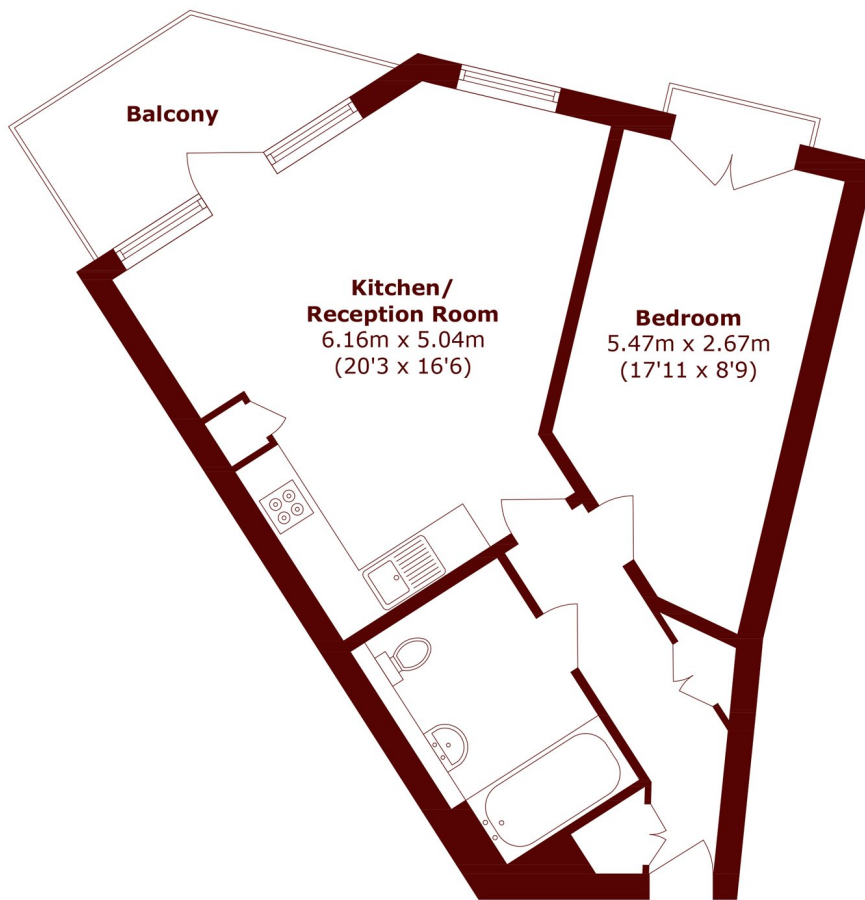

Total area (approx.): 50.1 sq. m (539.3 sq. ft)  
Balcony area (approx.): 6.0 sq. m (64.6 sq. ft)

**Kennington**  
020 7587 1533

Energy Rating: C We aim to make our particulars both accurate and reliable. However, they are not guaranteed; nor do they form part of an offer or contract. If you require clarification on any points then please contact us, especially if you're traveling some distance to view. Please note that appliances and heating systems have not been tested and therefore no warranties can be given as to their good working order

**MARSH &  
PARSONS**