



Union Street, Maidstone, , ME14 1EE

Price £235,000



**** A TWO-BEDROOM OLDER STYLE TERRACED PROPERTY SITUATED WITHIN WALKING DISTANCE OF MAIDSTONE TOWN CENTRE ****

Page & Wells are delighted to bring to the market this two-bedroom home which offers potential for improvement. The ground floor accommodation features a living room, kitchen and bathroom. Whilst, on the first floor, will be found two bedrooms. Salient features to note include a long rear garden, no forward chain implications and on-road permit parking. The property is well-placed for all of the town centre amenities. An internal viewing is recommended. Contact PAGE & WELLS King Street Office on 01622 756703. Tenure: Freehold. EPC Rating: C. Council Tax Band: B.



KEY FEATURES

- No forward chain
- Two bedrooms
- Long rear garden
- Permit parking
- Some modernisation required

ACCOMMODATION

Ground Floor:

Living Room

Kitchen

Rear Lobby

Bathroom

First Floor:

Bedroom

Bedroom

EXTERNALLY

There is a long garden to the rear.

VIEWING

Viewing strictly by arrangements with the Agent's Head
Office: 52-54 King Street, Maidstone, Kent ME14 1DB.
Tel: 01622 756703.

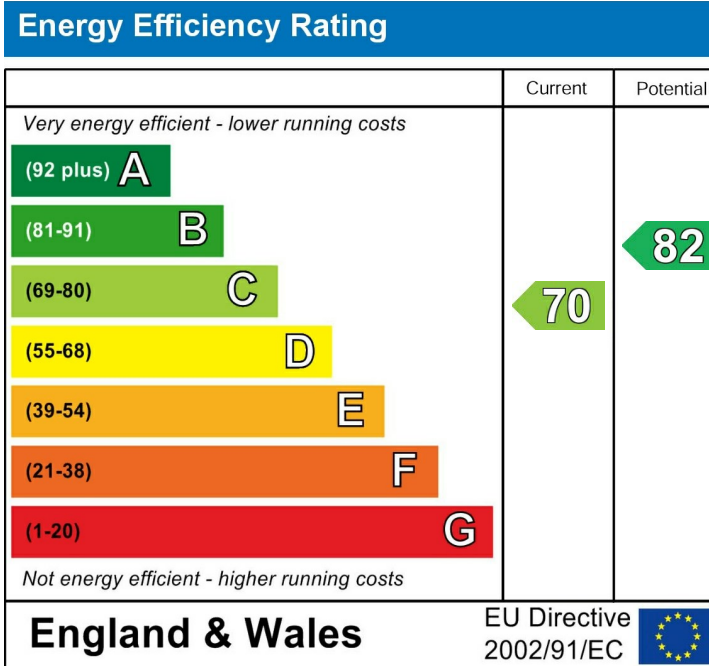

Page & Wells limited for themselves and for the vendors of this property whose agents they are give notice that: 1. These particulars do not constitute any part of, an offer or a contract. 2. All statements contained in these particulars as to this property are made without responsibility on the part of Page & Wells Limited or the Vendor. 3. None of the statements contained in these particulars as to the property is to be relied on as statements or representations of fact. 4. Any intending purchaser must satisfy himself by inspection or otherwise as to the correctness of each of the statements contained in these particulars. 5. The vendor does not make or give, and neither Page & Wells Limited nor any person in their employment has any authority to make or give any representation whatsoever in relation to this property. These particulars are supplied on the understanding that all negotiations are carried out throughout Page & Wells Limited. Properties with a reference prefixes EAA are those which Page & Wells Limited disclose an interest in accordance with the provisions of the Estates Agents Act 1979

Ground Floor

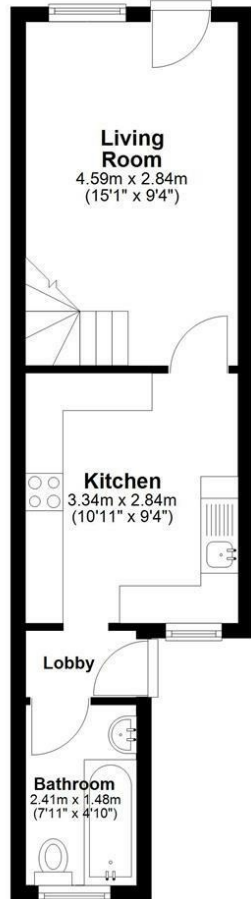

First Floor

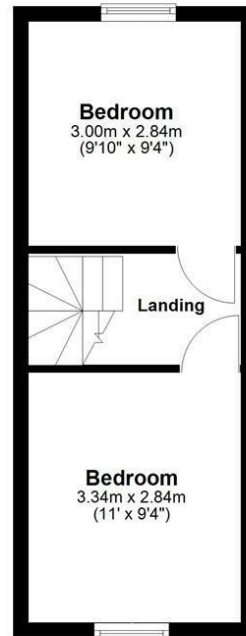

Total area: approx. 50.8 sq. metres (546.9 sq. feet)

