



Rowle Close, Stantonbury, Milton Keynes, MK14 6BJ

welcome to

Rowle Close, Stantonbury, Milton Keynes

Located in the popular and well-established area of Stantonbury, Milton Keynes, this well-presented, two-bedroom, one-bathroom maisonette offers comfortable and practical living, ideal for first-time buyers, downsizers, or investors.

Entrance Hall

Double-glazed door to the front and stairs to the first floor. Storage cupboard and doors to the bedrooms bathroom and lounge.

Lounge

Electric heater and double-glazed window to the front. Arch into the kitchen.

Kitchen

Partially tiled, fitted kitchen, with a mix of wall and base units with work surface over, sink with mixer tap and drainer, cooker hood extractor fan and space for a cooker. Space for a washing machine and a fridge/freezer. Double-glazed window to the rear.

Bedroom One

Electric heater and double-glazed window to the front.

Bedroom Two

Electric heater and double-glazed window to the rear.

Bathroom

Tiled with a pedestal wash hand basin, low-level WC and a bath. Double-glazed obscured window to the rear.

Outside

Garage

Agents Note

The term of the lease is 99 years from the 29/09/1974, which means there are currently 51 years remaining. This may impact on mortgage lending requirements. Interested parties should make further enquiries.

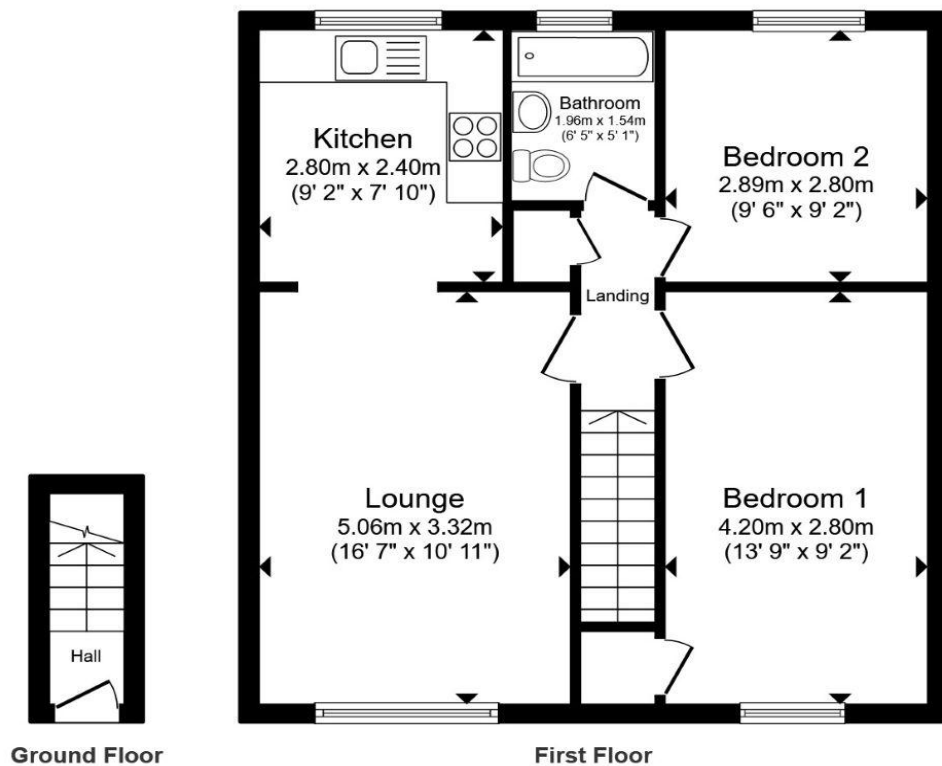

Total floor area 56.8 m² (612 sq.ft.) approx

This floor plan is for illustrative purposes only. It is not drawn to scale. Any measurements, floor areas (including any total floor area), openings and orientation are approximate. No details are guaranteed, they cannot be relied upon for any purpose and they do not form part of any agreement. No liability is taken for any error, omission or misstatement. A party must rely upon its own inspection(s). Powered by www.propertybox.io

**brown
& merry**



welcome to
Rowle Close,
Stantonbury, Milton Keynes

- TWO-BED MAISONETTE
- PRIVATE ENTRANCE
- SPACIOUS LIVING AREA
- FITTED KITCHEN WITH AMPLE STORAGE
- WELL-PROPORTIONED BEDROOMS

Tenure: Leasehold EPC Rating: Awaited

Council Tax Band: A Service Charge: 120.00

Ground Rent: 45.00

This is a Leasehold property with details as follows; Term of Lease 99 years from 29 Sep 1974. Should you require further information please contact the branch. Please Note additional fees could be incurred for items such as Leasehold packs.

fixed price

£120,000



view this property online [brownandmerry.co.uk/Property/NPL107943](https://www.brownandmerry.co.uk/Property/NPL107943)



Property Ref:
NPL107943 - 0002

1. MONEY LAUNDERING REGULATIONS Intending purchasers will be asked to produce identification documentation at a later stage and we would ask for your co-operation in order that there is no delay in agreeing the sale. 2. These particulars do not constitute part or all of an offer or contract. 3. The measurements indicated are supplied for guidance only and as such must be considered incorrect. Potential buyers are advised to recheck measurements before committing to any expense. 4. We have not tested any apparatus, equipment, fixtures or services and it is in the buyers interest to check the working condition of any appliances. 5. Where an EPC, or a Home Report (Scotland only) is held for this property, it is available for inspection at the branch by appointment. If you require a printed version of a Home Report, you will need to pay a reasonable production charge reflecting printing and other costs. 6. We are not able to offer an opinion either written or verbal on the content of these reports and this must be obtained from your legal representative. 7. Whilst we take care in preparing these reports, a buyer should ensure that his/her legal representative confirms as soon as possible all matters relating to title including the extent and boundaries of the property and other important matters before exchange of contracts.

Brown & Merry is a trading name of Sequence (UK) Limited which is registered in England and Wales under company number 4268443, Registered Office is Cumbria House, 16-20 Hockliffe Street, Leighton Buzzard, Bedfordshire, LU7 1GN. VAT Registration Number is 500 2481 05.

brown & merry



01908 611242



newportpagnell@brownandmerry.co.uk



74A High Street, Newport Pagnell, MILTON
KEYNES, Buckinghamshire, MK16 8AQ



[brownandmerry.co.uk](https://www.brownandmerry.co.uk)