



SAB
ESTATES

Greenway Gardens, Greenford
£695,000

SAB
ESTATES



Greenway Gardens

Greenford

- Chain-Free
- Four-Bedroom Semi-Detached House
- Generous Corner Plot
- Two Reception Rooms
- Spacious Kitchen/Dining Room
- Ground Floor WC
- Outbuilding
- Off-Street Parking
- Close to Schools, Shops & Transport Links

Council Tax band: E

Tenure: Freehold



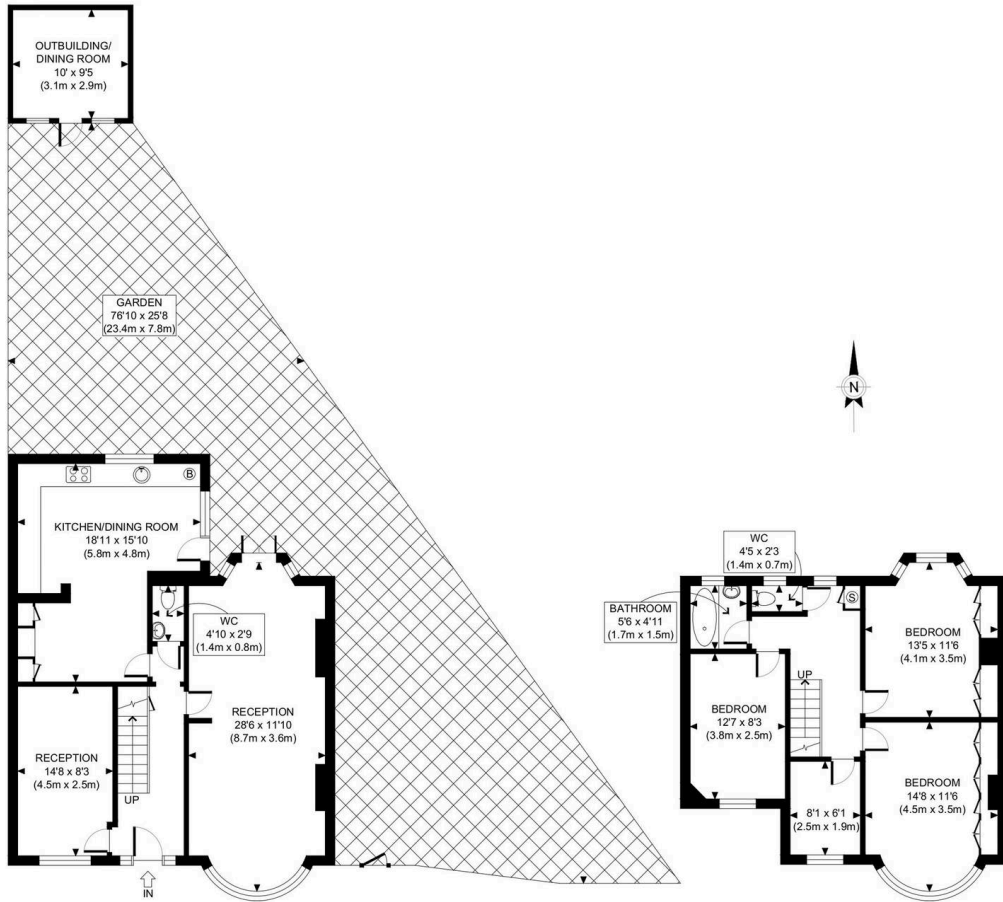

GROUND FLOOR
GROSS INTERNAL
FLOOR AREA 821 SQ FT

FIRST FLOOR
GROSS INTERNAL
FLOOR AREA 610 SQ FT

APPROX. GROSS INTERNAL FLOOR AREA WITH OUTBUILDING/DINING ROOM: 1525 SQ FT/ 142 SQM
APPROX. GROSS INTERNAL FLOOR AREA WITHOUT OUTBUILDING/DINING ROOM: 1431 SQ FT/ 133 SQM

This plan is for illustrative purposes only and should be used as such by any prospective client. Whilst every attempt has been made to ensure the accuracy of the Floor Plan contained here, measurements of the doors, windows, rooms and any other items are approximate and no responsibility is taken for any errors, omissions, or misstatement. The services, systems and appliances shown have not been tested and no guarantee as to the operability or efficiency can be given.





SAB Estates

236-238 Ruislip Road, Greenford - UB6 9RS

020 8575 2929 • info@sabestates.com • www.sabestates.com/