



Nether Street, N3

£400,000

A well presented two bedroom apartment set within this small purpose built block. This property has a modern, open-plan kitchen/ reception room, a designated parking space and a share of the freehold.

Nether Street is conveniently located near a wide range of local amenities along Ballards Lane in Finchley Central. It also offers excellent links to the Northern Line (West Finchley) and falls within the catchment area for several highly regarded schools.

Features

- Two Double Bedrooms
- Share of Freehold
- Modern Interior
- Allocated Parking Space
- Excellent Transport Links
- Close To Amenities

Nether Street, London, N3

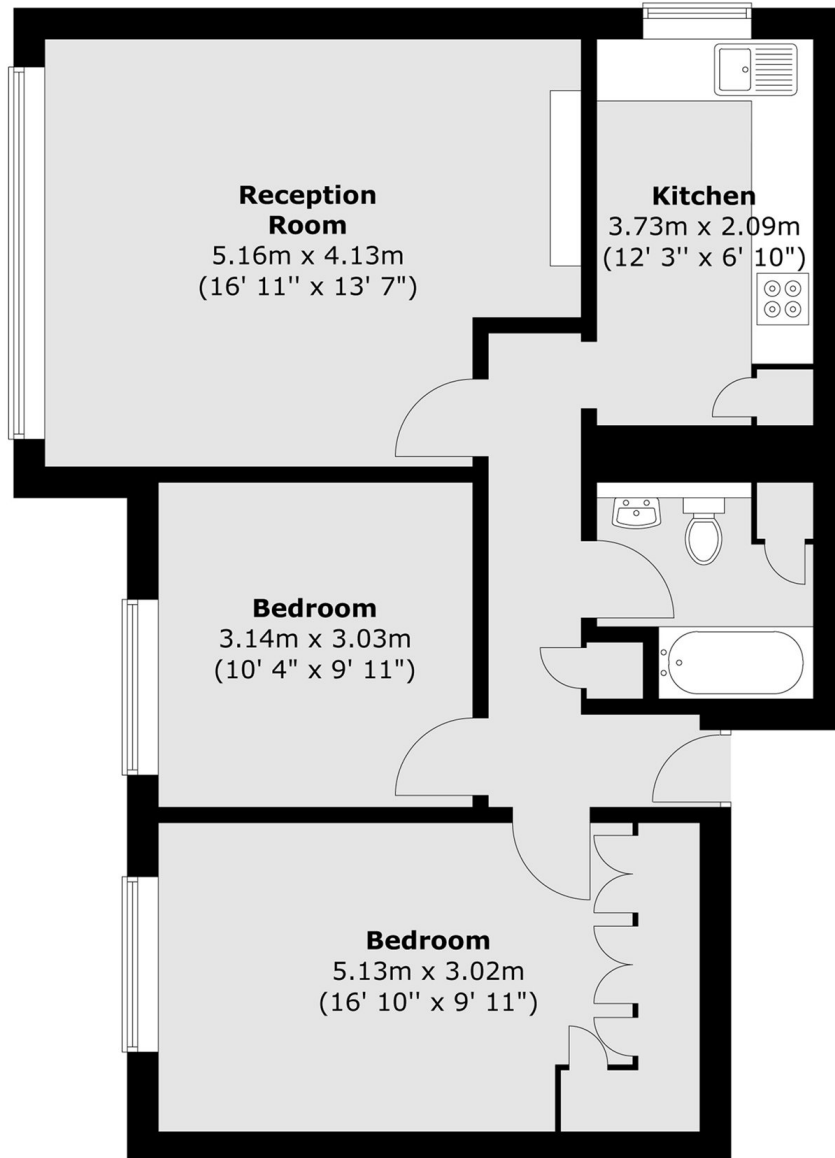

Total area (approx.) : 67.4 sq. m (725 sq. ft)