

HJC

ESTATE AGENCY

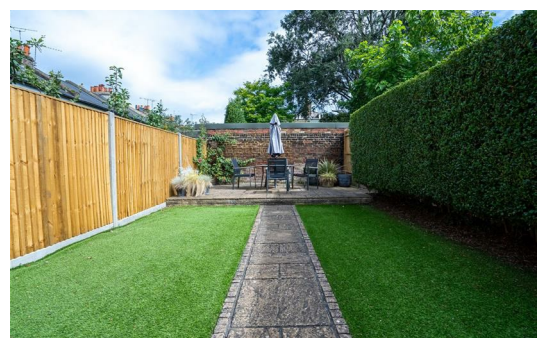

Cleaveland Road

Surbiton, KT6 4AJ

An outstanding home, located on one of Surbiton's popular river roads. Downstairs, the property benefits from a double reception room and a modern eat-in kitchen with doors onto a lovely low maintenance garden. Upstairs, there are two double bedrooms, a single bedroom/office and a family bathroom. There is also off-street parking and the potential to extend subject to the usual consents. Surbiton Town Centre and mainline station with its fast service to Waterloo is minutes away along with an abundance of local amenities all close by. Council Tax Band E. No onward chain.

Material Info: Brick Walls and Roof Tiles. Water / Electricity / Sewerage: Mains. Heating: Gas Mains. Broadband: Fibre (FTTC). Mobile Coverage: Indoor: Variable Outdoor: Good.

- River Road Location
- Kitchen/breakfast Room
- Upstairs Bathroom
- Potential to extend (STPP)
- Close to local schools
- 3 Bedrooms
- Living/Dining Room
- Off Street Parking
- No Onward Chain
- River Thames, Town Centre and Train Station Minutes Away

Guide Price £950,000

Floor Plan

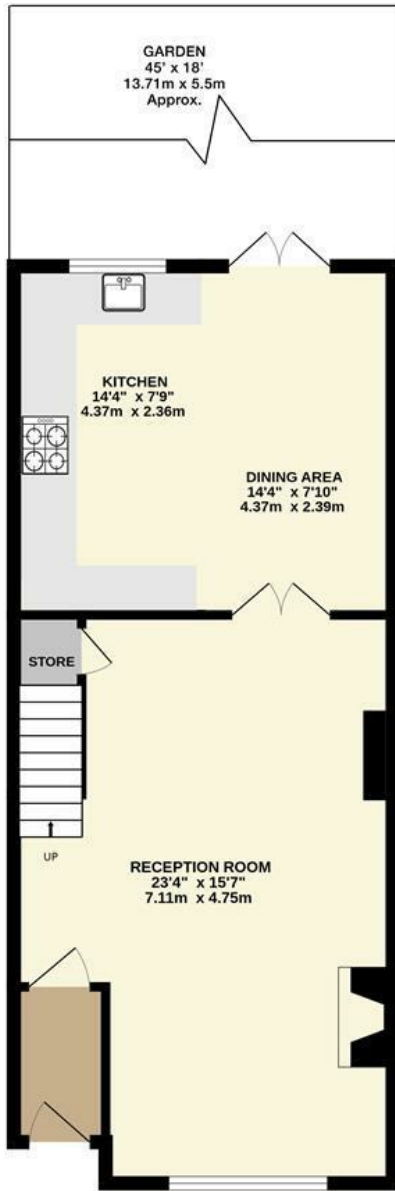

GROUND FLOOR



FIRST FLOOR

Whilst every attempt has been made to ensure the accuracy of this floor plan, measurement of doors, windows, rooms and any other items are approximate and no responsibility is taken for any error, omission or mis-statement. Made with Metropix © 2025.

CLEAVELAND ROAD, SURBITON
INTERNAL FLOOR AREA
(APPROX.) 1082 sq ft/ 101.0 sq m

Energy Efficiency Graph

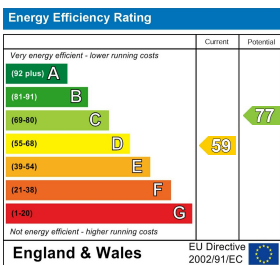

These particulars, whilst believed to be accurate are set out as a general outline only for guidance and do not constitute any part of an offer or contract. Intending purchasers should not rely on them as statements of representation of fact, but must satisfy themselves by inspection or otherwise as to their accuracy. No person in this firm's employment has the authority to make or give any representation or warranty in respect of the property.