

## The Crescent, Shirley, Solihull, B90 2ES

Offers In Region Of £350,000

3 1 2



Beautifully Presented Three-Storey Chain-Free Family Home in a Prime Shirley Location. CHAIN FREE

**Shirley Office:**  
Black and Golds Estate Agents  
117 Stratford Road, Shirley, Solihull, B90 3ND

**Wythall Office:**  
Black and Golds Mortgages  
The Old Bakery House, Becketts Farm, Alcester Road, Wythall, B47 6AJ

Black and Golds Letting Agents Limited, Company Registration Number: 10398851. Black and Golds Estate Agents, Company Registration Number: 57939519. Registered Office: 117 Stratford Road, Solihull B90 3ND.  
© 2023 Black and Golds Letting Agents Limited, Company Registration Number: 10398851. Black and Golds Estate Agents Copyright: All rights reserved. No content can be reproduced without our prior written consent.  
While we as Estate Agents on behalf of the vendors endeavour to ensure the accuracy of property details provided and displayed, we have not tested any appliances, equipment, fixtures and fittings or services and do not warrant that they are connected, in working order or fit for the purpose. Neither have we had sight of the legal documents to verify the freehold or leasehold status of any property. A Buyer is advised to obtain verification from their Solicitor and/or Surveyor. A Buyer must check the availability of any property and make an appointment to view before embarking on any journey to see a property. The Vendors have checked and approved these particulars. These particulars are intended to give a fair description, but their accuracy cannot be guaranteed, and are not to be taken as forming any part of a resulting contract. They are issued on the basis the property is still available and on the understanding that all registrations are conducted through the agents.

## Key Features

- Situated in the highly desirable and well-connected area of Shirley, Solihull
- Welcoming entrance hallway with access to two generous reception rooms
- Comfortable rear lounge with direct access into the conservatory
- Well-appointed fitted kitchen with good storage and worktop space
- Family bathroom with modern fittings
- Set across three spacious floors offering approx. 1,422 sq. ft. of accommodation
- Bright front dining room, ideal for family meals and entertaining
- Conservatory providing additional living space overlooking the garden
- First floor offering three well-proportioned bedrooms
- Second-floor loft room offering excellent flexibility as a bedroom, home office or hobby space

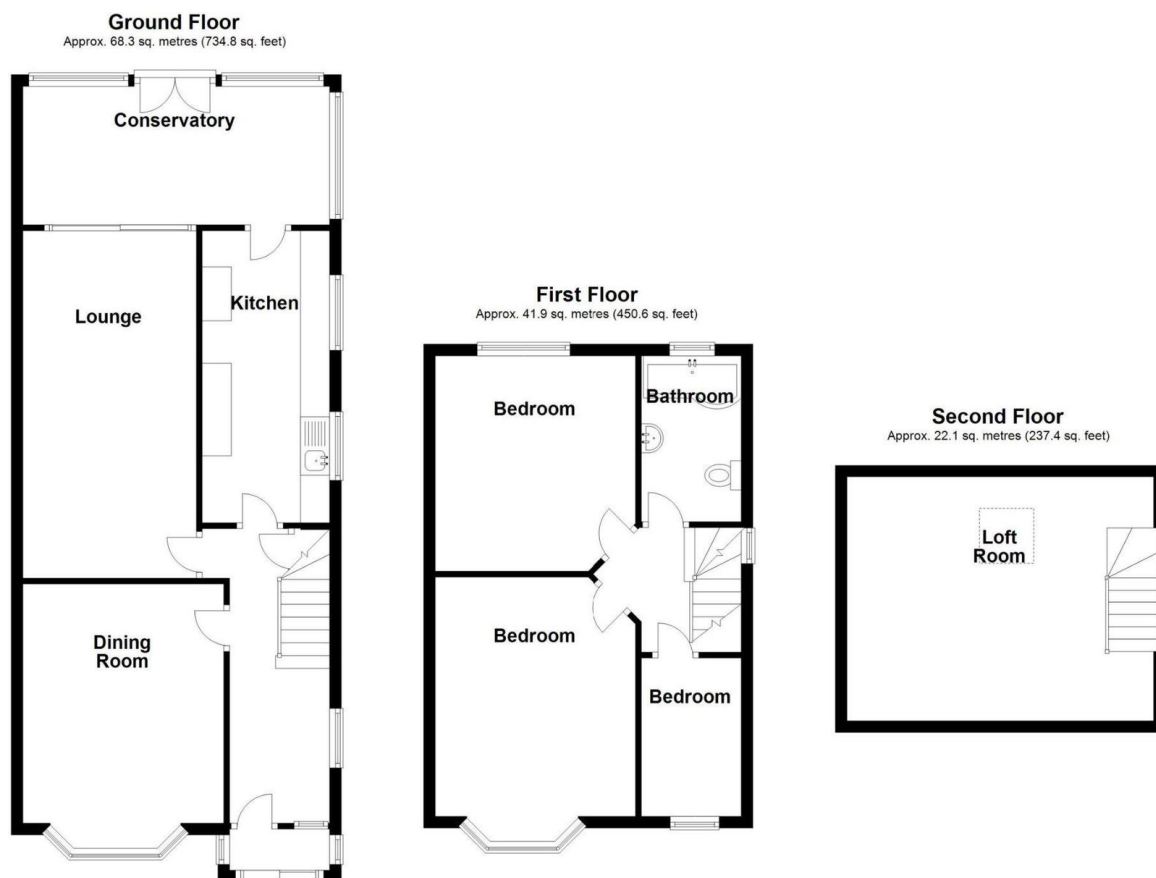

Total area: approx. 132.2 sq. metres (1422.8 sq. feet)