



Byron Mews, London NW3 2NQ

---

WAYNE  
& SILVER

## Byron Mews, London NW3 2NQ

An exceptionally well-positioned modern four-bedroom townhouse set within a secure, private gated development, complete with allocated parking, a landscaped garden, and a generous balcony.

Designed for contemporary living, the property features a light-filled reception room with balcony access and a modern kitchen/dining area. The layout includes two bedrooms with en-suite bathrooms, two additional bedrooms supported by a family bathroom, along with a guest WC and a separate utility room.

Located moments from Hampstead Heath and the many amenities of South End Green.

Council Tax: Camden, band G.

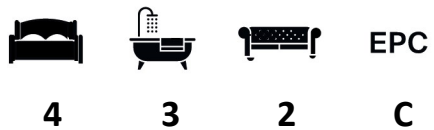

**Guide price:** £6,750 Per Month

**Tenure:**

**Service Charge:** Add text here

**Local Authority:**

**Council Tax Band:**













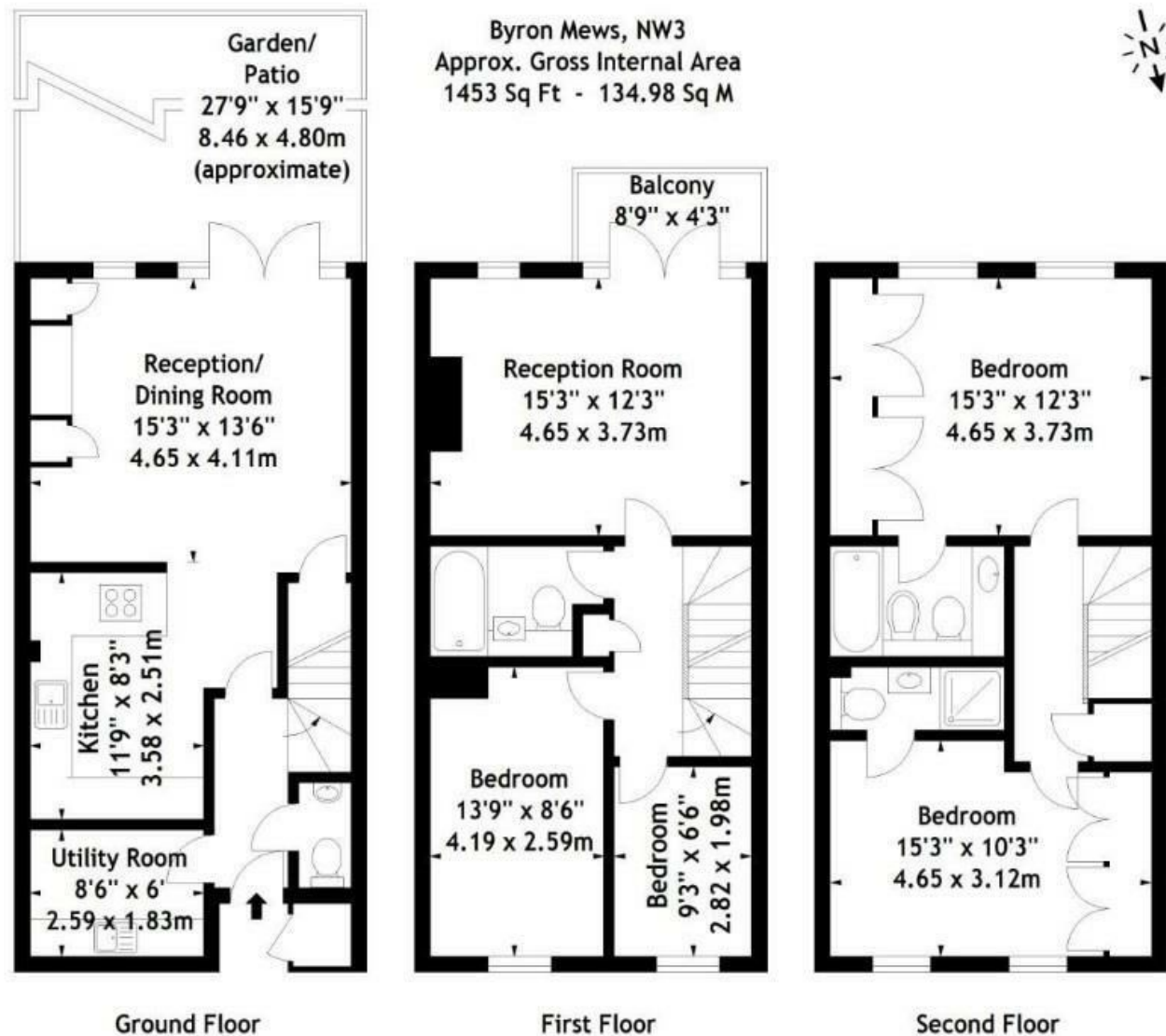

41 Heath Street  
Hampstead  
London  
NW3 6UA

We would be delighted to tell you more  
020 7431 4488  
[info@wayne-silver.com](mailto:info@wayne-silver.com)

[wayne-silver.com](http://wayne-silver.com)

**Important Notice:** Wayne & Silver, its clients and any joint agents give notice that 1: They are not authorised to make or give any representations or warranties in relation to the property either here or elsewhere, either on their own behalf or on behalf of their client or otherwise. They assume no responsibility for any statement that may be made in these particulars. These particulars do not form part of any offer or contract and must not be relied upon as statements or representations of fact. 2: Any areas, measurements or distances are approximate. The text, photographs and plans are for guidance only and are not necessarily comprehensive. It should not be assumed that the property has all necessary planning, building regulation or other consents and Wayne & Silver have not tested any services, equipment or facilities. Purchasers must satisfy themselves by inspection or otherwise.