

Hartington Court, Lansdowne Way, SW8

Guide Price £325,000 to £350,000

2 1 1



- Quote MG1175 for all enquiries.
- 2 Bedrooms
- Duplex Flat over 3rd & 4th Floors
- Far reaching views
- Short walk to Battersea Power Station
- Guide Price £325,000 to £350,000
- Large Reception Room
- Renovation Opportunity
- Close to Stockwell & Nine Elms Tube Stations
- Next to Larkhall Park

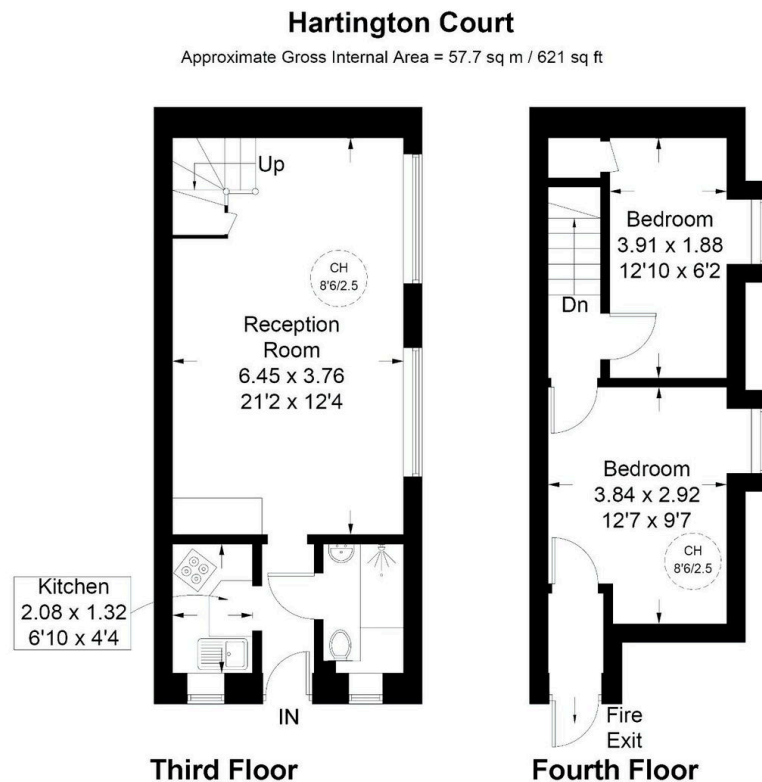

Illustration for identification purposes only, not for valuation purposes, measurements are approximate, not to scale.

Set across the top 2 floors of Nightingale Court, this 2-bedroom duplex apartment offers an exciting chance to create a truly bespoke home in one of SW8's most convenient neighbourhoods. Positioned within a secure, gated development with well-kept communal gardens, the property enjoys peace, privacy and impressive far-reaching views towards Battersea Power Station.

