



47, Fulmer Road, Sheffield, S11 8UF

47, Fulmer Road

Sheffield, S11 8UF

Description

The Hunters Bar hill is such a great place to live. Sharrowvale is possibly one of the most visited parts of the south west sector of the city. The neighbourhood is home to a cluster of superb pubs, restaurants and cafes and the schooling is also very well regarded. It is also situated close to fashionable Nether Edge Village and within walking distance of town which can also be approached via regular bus services along Ecclesall Road. With over 100 square feet of accommodation and the potential to create a third bedroom on the first floor, this charming Edwardian terrace represents excellent value in one of the city's most desirable locations. With an end of run, landscaped, low maintenance south facing garden to the rear and a super finish throughout this one is perfect for first time buyers or investors and is well worth checking out.

- Two good double bedrooms.
- Particularly large bathroom on the first floor, offering potential to split or form an additional bedroom if preferred.
- Versatile home office/utility room in the offshot providing the potential to create a ground floor bathroom to enable the above.
- Sitting room with bay window and attractive coving.
- Low maintenance, landscaped south facing garden.
- Dining kitchen.
- 800 year lease from 1908 with a £2 annual ground rent.
- Council Tax Band B and no onward chain.
- Gas central heating and UPVC double glazing combining to create an EPC rating of D66.
- Superb location, close to plentiful amenities and providing a fine lifestyle choice.





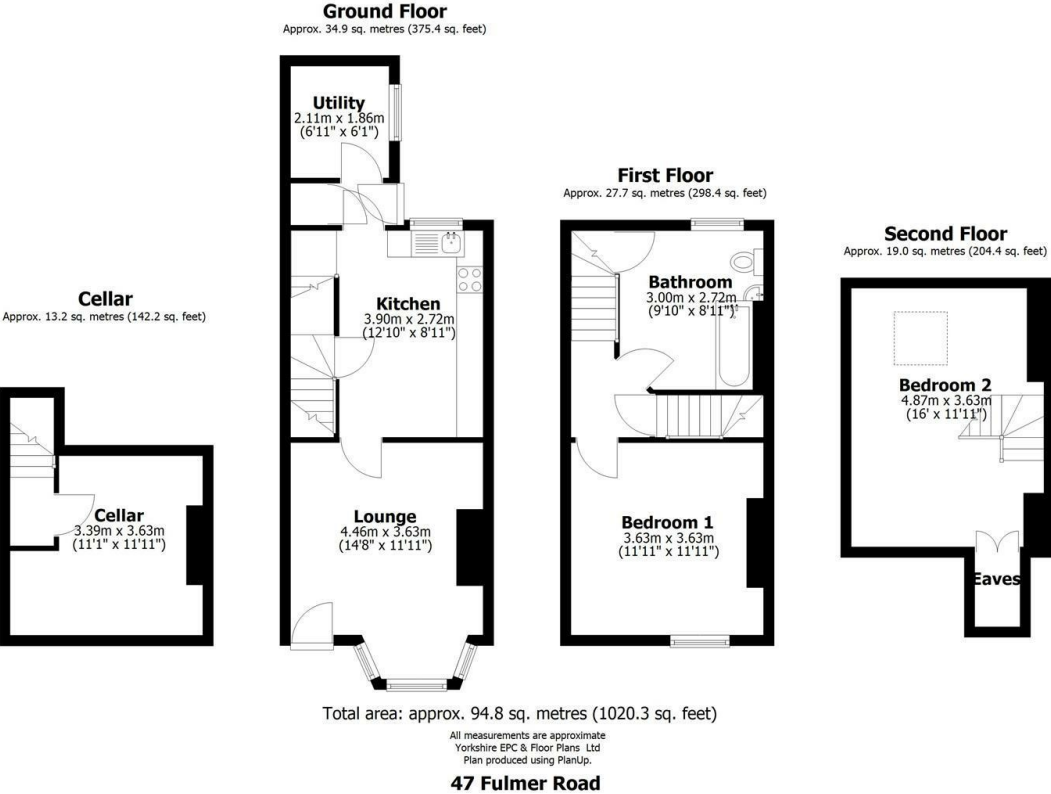

Bakewell
3 Royal Oak Place
Matlock Street
Bakewell DE45 1HD
T: 01629 700699
E: bakewell@elr.co.uk

Banner Cross
888 Ecclesall Road
Banner Cross
Sheffield S11 8TP
T: 01142 683388
E: bannercross@elr.co.uk

Dore
33 Townhead Road
Sheffield
S17 3GD
T: 0114 2362420
E: dore@elr.co.uk

Hathersage
Main Road, Hathersage
Hope Valley
Derbyshire S32 1BB
T: 01433 651888
E: peakdistrict@elr.co.uk

Rotherham
149 Bawtry Road
Wickersley
Rotherham S66 2BW
T: 01709 917676
E: wickersley@elr.co.uk

**EADON
LOCKWOOD
& RIDDLE**
ESTD 1840

All rooms have been measured with electronic laser and are approximate measurements only. None of the services to the above property have been tested by ourselves, and we cannot guarantee that the installations described in the details are in perfect working order. Eadon Lockwood & Riddle for themselves, and for the vendors or lessors, produce these brochures in good faith, and are a guideline only. They do not constitute any part of a contract and are correct to the best of our knowledge at the time of going to press.