



Kent Avenue, W13

£425,000

A well presented top floor one-bedroom apartment in a popular residential development. This bright and spacious home features a dual aspect open plan reception and kitchen, a modern bathroom, and is offered to the market chain free.



A beautifully presented top-floor one-bedroom apartment in West Ealing, with a dual-aspect open-plan reception/kitchen, spacious double bedroom, and modern bathroom.

Located on Kent Avenue within easy reach of transport links, shops, and local amenities of West Ealing and Ealing Broadway.

- One Bedroom • Top Floor • No Onward Chain •
- Modern Kitchen • Spacious Reception • Residential Development •



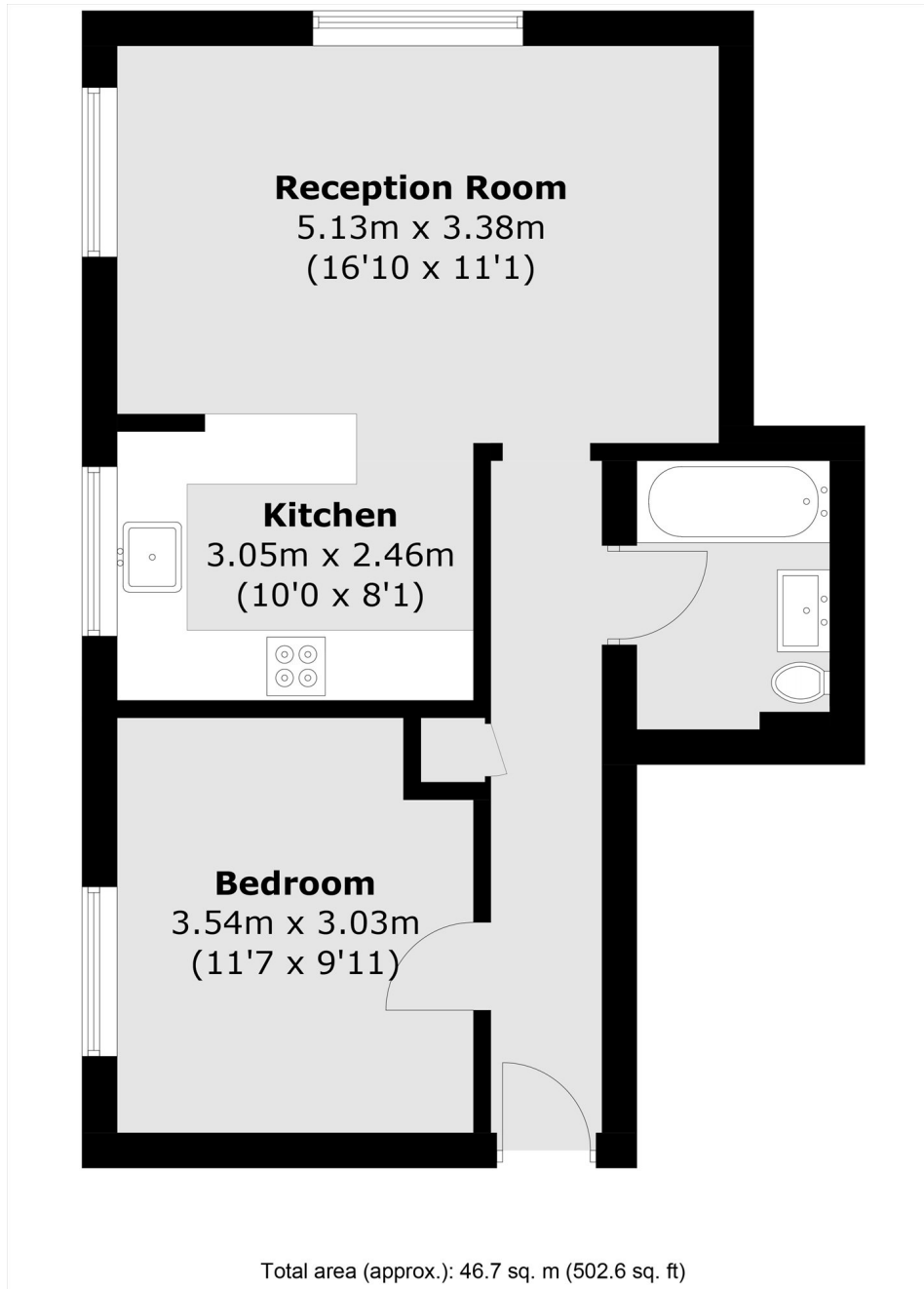

Robertson Smith & Kempson Ealing Sales
1 The Broadway, London,
W5 2NT
020 8840 7677
ealingsales@robertsonsmithandkempson.co.uk

Energy Rating: D. We aim to make our particulars both accurate and reliable. However they are not guaranteed; nor do they form part of an offer or contract. If you require clarification on any points then please contact us, especially if you're traveling some distance to view. Please note that appliances and heating systems have not been tested and therefore no warranties can be given as to their good working order.