



Mulburries

TO LET



39 Langley Avenue, Hemel Hempstead, Hertfordshire, HP3 9NS  
£2,200 Per month

- Semi-detached home
- Family bathroom
- Large living/dining room
- Double glazing
- Good locals Schools
- Two bedrooms
- Downstairs W/C
- Two/three off street parking spaces
- Gas central heating
- Approximately 0.9 miles to Apsley train station

## THE PROPERTY

Welcome to Langley Avenue, Hemel Hempstead, HP3 - a charming semi-detached house that is sure to capture your heart! This delightful property boasts 2 reception rooms, 2 cosy bedrooms, and a modern bathroom, providing ample space for comfortable living.

Situated in a sought-after location, this house offers parking for 2 vehicles, making it convenient for you and your guests. The property has been fully renovated to a high spec finish throughout, ensuring a stylish and contemporary living environment that is ready to impress.

With a move-in date available from the 11th of December, this home is perfect for those looking to settle in quickly. Additionally, the house comes part-furnished, saving you the hassle of furnishing the entire property yourself.

Benefitting from off-street parking and located in Council Tax Band C, this property not only offers convenience but also practicality. Don't miss out on the opportunity to make this house your home - book a viewing today and experience the charm of Langley Avenue for yourself!

## SITUATION

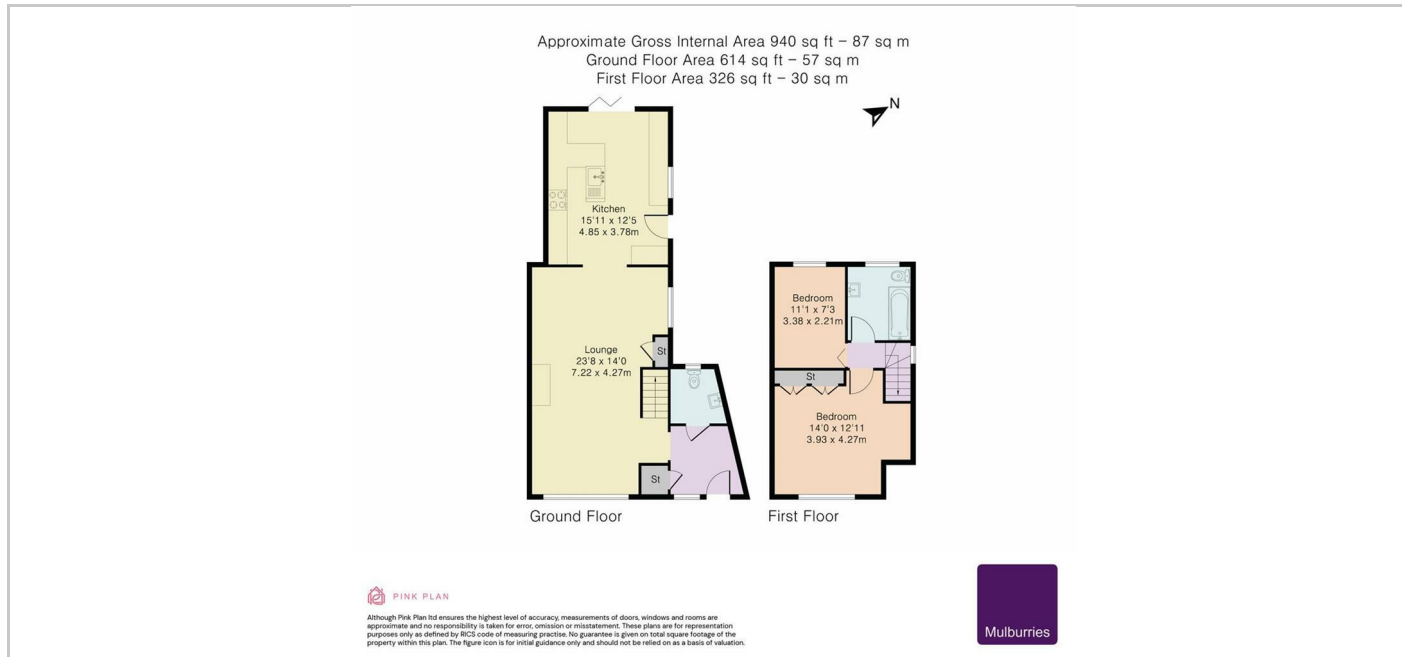

## Directions

31 Lawn Lane, Hemel Hempstead, Hertfordshire, HP3 9HH  
 Tel: 01442 732362 Email: [contact@mulburries.co.uk](mailto:contact@mulburries.co.uk) [ryan.green@mulburries.co.uk](mailto:ryan.green@mulburries.co.uk)