

Emmanuel Road, SW12

£3,400 Per calendar month

An attractive three bedroom maisonette located in the Hyde Farm conservation area. Set on the ground floor, this property offers a spacious reception room, an eat-in kitchen and a private rear garden.

Situated on the doorstep of Tooting Bec Common and close to the many shops, restaurants, bars and leisure facilities of central Balham. Also nearby Balham overground/underground.

Features

- Three Double Bedrooms
- Spacious Reception Room
- Eat in Kitchen
- Private Garden
- Neutral Interior
- Close To Transport

Emmanuel Road, London, SW12

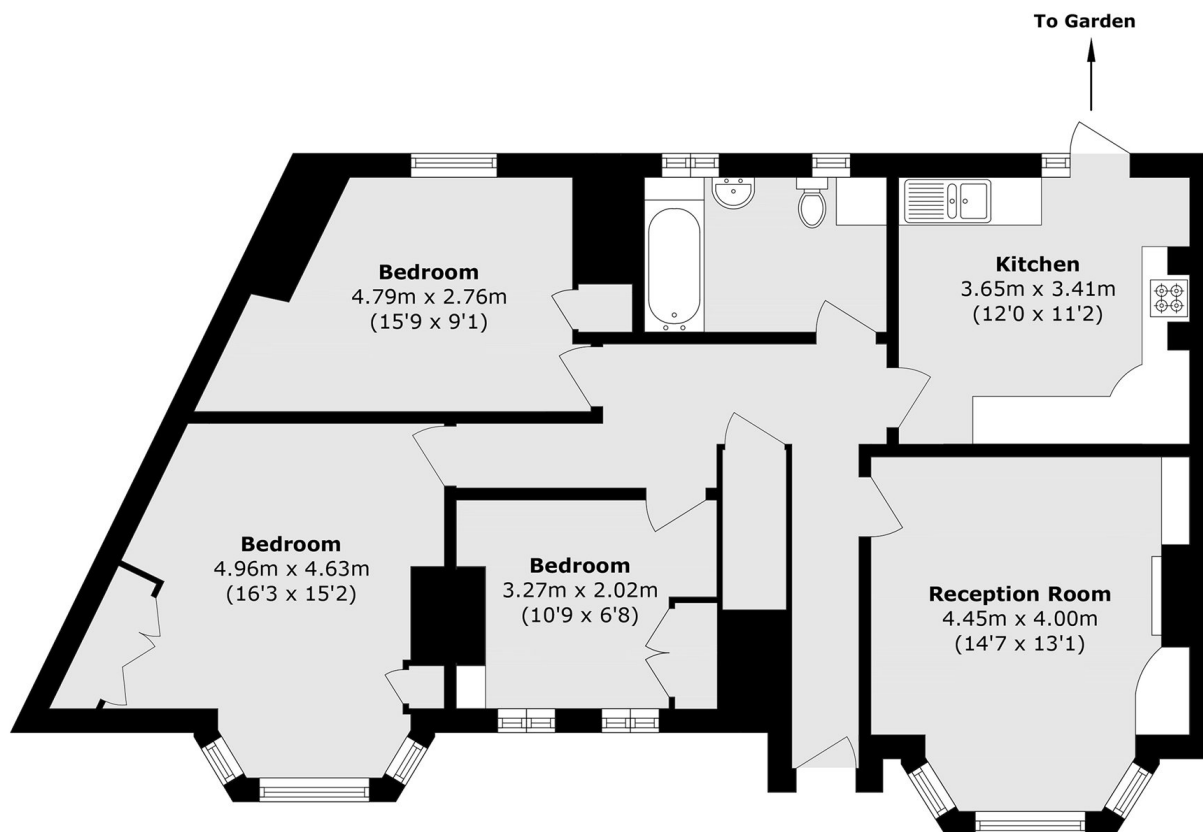

Total area (approx.): 87.7 sq. m (944.0 sq. ft)