



ESTATE AGENT



## Keedonwood Road

Bromley, BR1 4QW

Guide price £375,000

Guide Price £375,000 - £390,000.

Situated on a quiet residential road is this 2-bedroom mid-terrace house with private driveway and a well-maintained rear garden.

Entering the property, ground floor accommodation comprises entrance hall with storage space, reception to the front, and a separate modern kitchen to the rear, with access to garden. Upstairs consists of a master-bedroom with built-in wardrobes, additional double-bedroom, and a family bathroom.

Additional advantages include newly fitted double-glazed windows throughout, as well as front door and back door. The property also has a recently installed combi-boiler.

The property is conveniently located just 0.2 miles from the 'Ofsted Outstanding' Burnt Ash Primary School and only half a mile from the highly regarded Bonus Pastor Catholic College. Excellent transport links into Central London are available from Grove Park railway station (Zone 4), located just 0.8 miles away, with services to London Charring Cross, Cannon Street, and London Bridge in as little as 14 minutes. Also nearby is Bromley Town Centre, offering a wide range of bars, shops and restaurants.

### Viewing

Please contact our Bromley Office on 020 3633 8620 if you wish to arrange a viewing appointment for this property or require further information.

- Two Double Bedrooms
- Front Driveway and Rear Garden
- Residential Road
- Recently Fitted Double-Glazed Windows Throughout
- Recently Fitted Front Door and Back Door
- Recently Installed Combi-Boiler
- Close to Burnt Ash Primary School (Outstanding)
- Close to Local Amenities and Transport Links



2



1



1



D

## Floor Plan

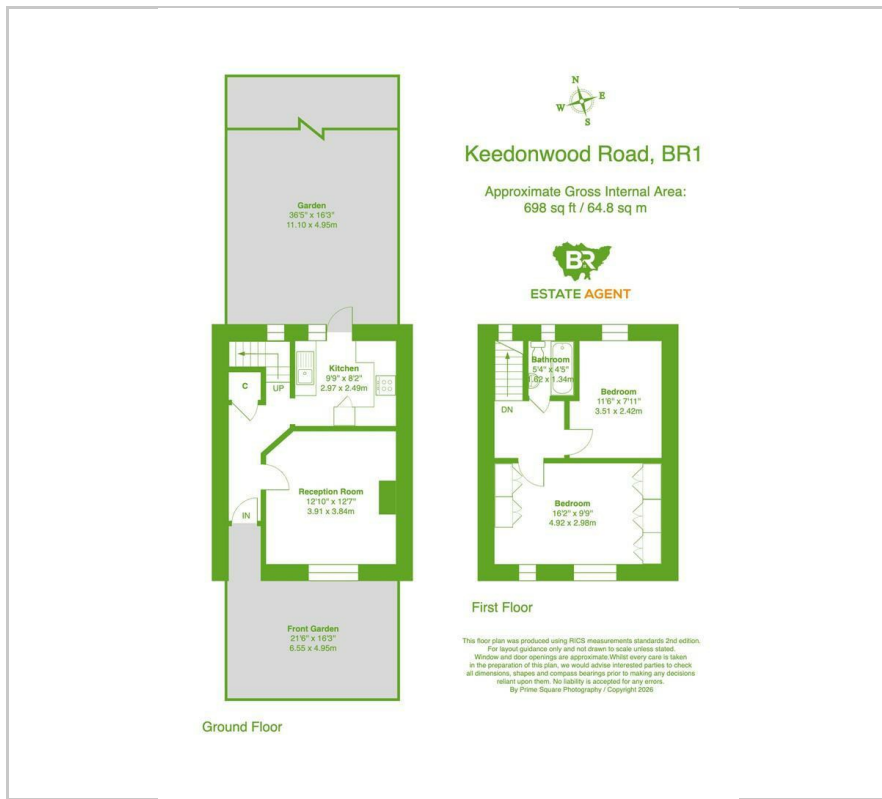

## Area Map

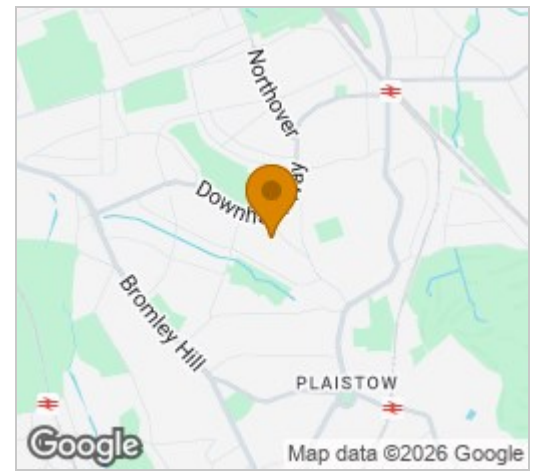

## Energy Efficiency Graph

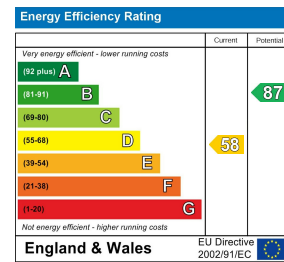

These particulars, whilst believed to be accurate are set out as a general outline only for guidance and do not constitute any part of an offer or contract. Intending purchasers should not rely on them as statements of representation of fact, but must satisfy themselves by inspection or otherwise as to their accuracy. No person in this firm's employment has the authority to make or give any representation or warranty in respect of the property.