

Marsham Street, SW1P

£495,000

This one bedroom apartment is excellently located in the heart of Westminster. The property is in wonderful condition throughout and benefits from an open plan kitchen/living room, ample storage and exclusive use of a patio garden. This apartment would make a wonderful home or investment.

Marsham Street is situated for the shops bars and restaurants that Westminster and Victoria have to offer. Transport links include St James's Park, Westminster and Victoria Station, all within easy reach.

Features

- One Bedroom
- One Bathroom
- Patio
- Open Plan
- Excellent Condition
- Westminster

Marsham Street, London, SW1P

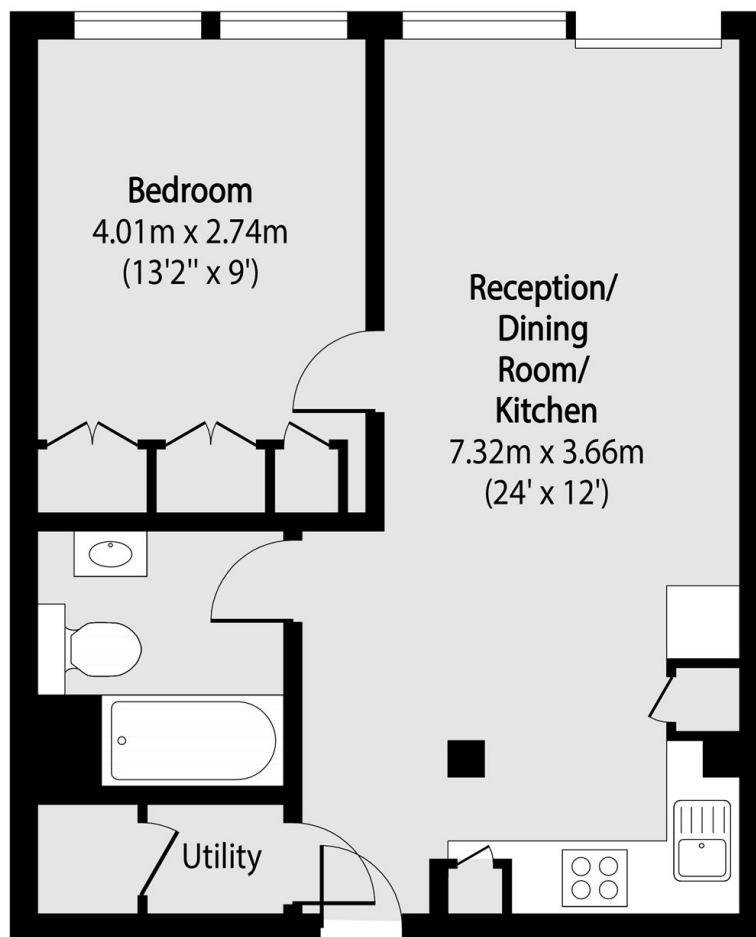

Total area (approx): 42.92 sq m (462 sq. ft)