



Hawden Road, Tonbridge - TN9 1JN

Guide Price £350,000 - £375,000

est. 1828
bracketts



- Two Bedrooms
- Two Reception Rooms
- Sought After Slade - Central Tonbridge Location, Close to High Street, Coveted Schools
- Period Terraced Family Home
- First Floor Bathroom
- Established Rear Garden
- Newly Installed Kitchen
- Garden Room
- No Onward Chain
- Viewing Highly Recommended

Offered for sale is this well presented two-bedroom terraced house situated in the popular and favored area of The Slade, tucked away in a quiet area of central Tonbridge. Internally, to the ground floor the property comprises newly installed kitchen, cloakroom WC, dining room, living room and garden room. To the first floor there are two double bedrooms and a family bathroom which is accessed off one of the bedrooms.

Externally there is an established rear garden to the rear with, mature borders and backing onto school playing fields and a large shed.

Tucked away from the Town Centre, the property is within easy reach for Tonbridge Mainline Station, coveted schools and High Street which offers a range of local shops, supermarkets, cafés, bars and restaurants. It is also in close proximity from the historic Tonbridge Castle with stunning river walks leading you through to the park and sportsground and onto the beautiful Haysden Country Park. The property is being sold with no onward chain and an internal viewing is highly recommended.



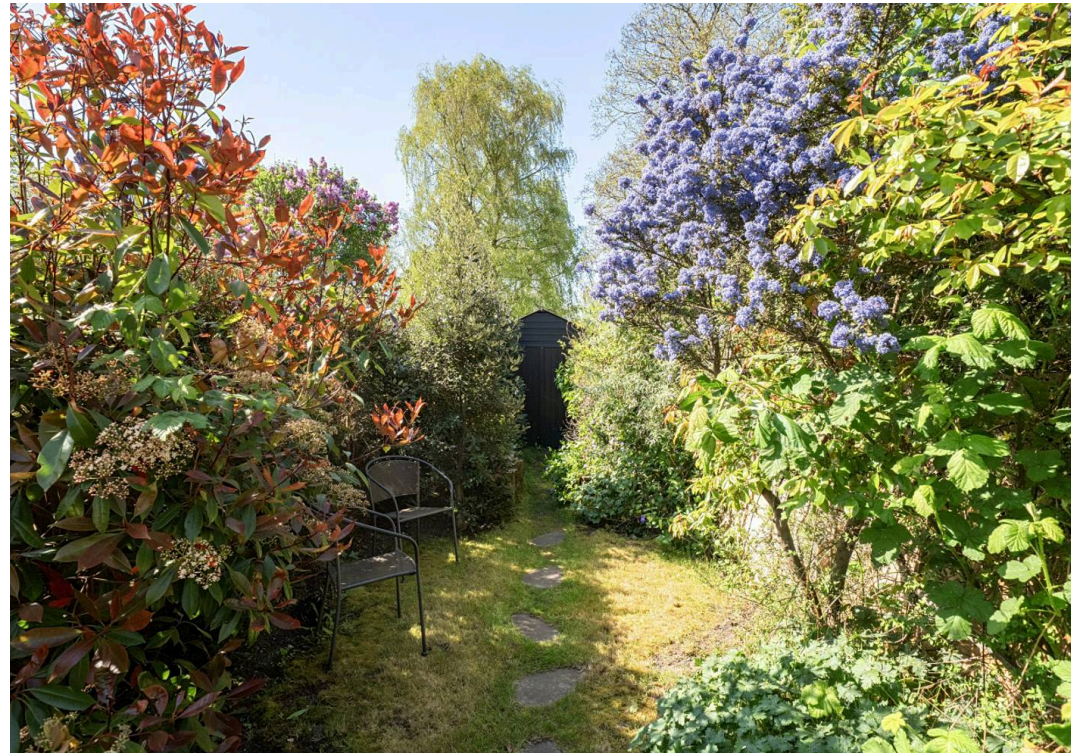

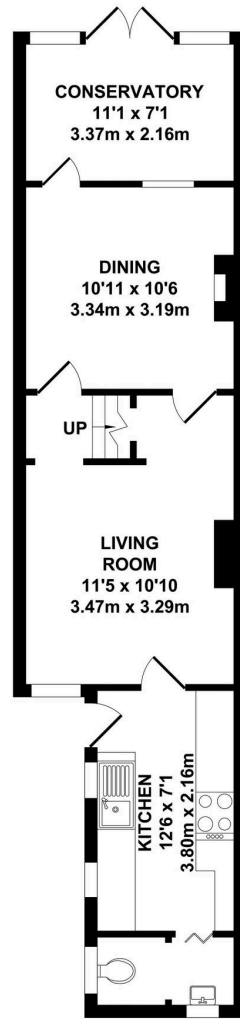

GROUND FLOOR
APPROX. FLOOR AREA
476 SQ.FT.
(44.25 SQ.M.)

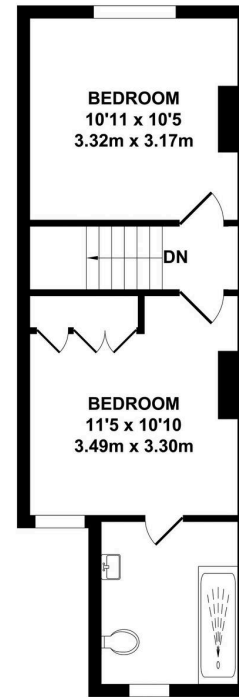

FIRST FLOOR
APPROX. FLOOR AREA
340 SQ.FT.
(31.63 SQ.M.)

TOTAL APPROX. FLOOR AREA 817 SQ.FT. (75.88 SQ.M.)

Whilst every attempt has been made to ensure the accuracy of the floor plan contained here, measurements of doors, windows, rooms and any other items are approximate and no responsibility is taken for any error, omission or mis-statement. This plan is for illustrative purposes only and should be used as such by any prospective purchaser. The services, systems and appliances shown have not been tested and no guarantee as to their operability or efficiency can be given.