



Rectory Square, E1 £850,000

Large three bedroom freehold house on the sought after Rectory Square. The entrance level has the properties spacious separate kitchen which is modernised and fully integrated and leads through to the adjoining, yet separate dining room and living room made possible by a single story extension to the rear, this floor also has a WC. The living room has bi-folding doors which follows into the large, partly decked, garden. The first floor has the three double bedrooms and family bathroom. The house has a driveway with potential space for two cars.

Ideally located for easy transport throughout the City and beyond via Stepney Green (District, Hammersmith&City) and Whitechapel (Elizabeth, Windrush), as well as multiple bus routes, and Limehouse for the DLR. Nearby Mile End Park and Stepney City Park Farm offer open green spaces.

Features

- Freehold house
- Driveway
- Three double bedrooms
- Large garden
- Bathroom + WC
- Modern interiors

Rectory Square, London, E1

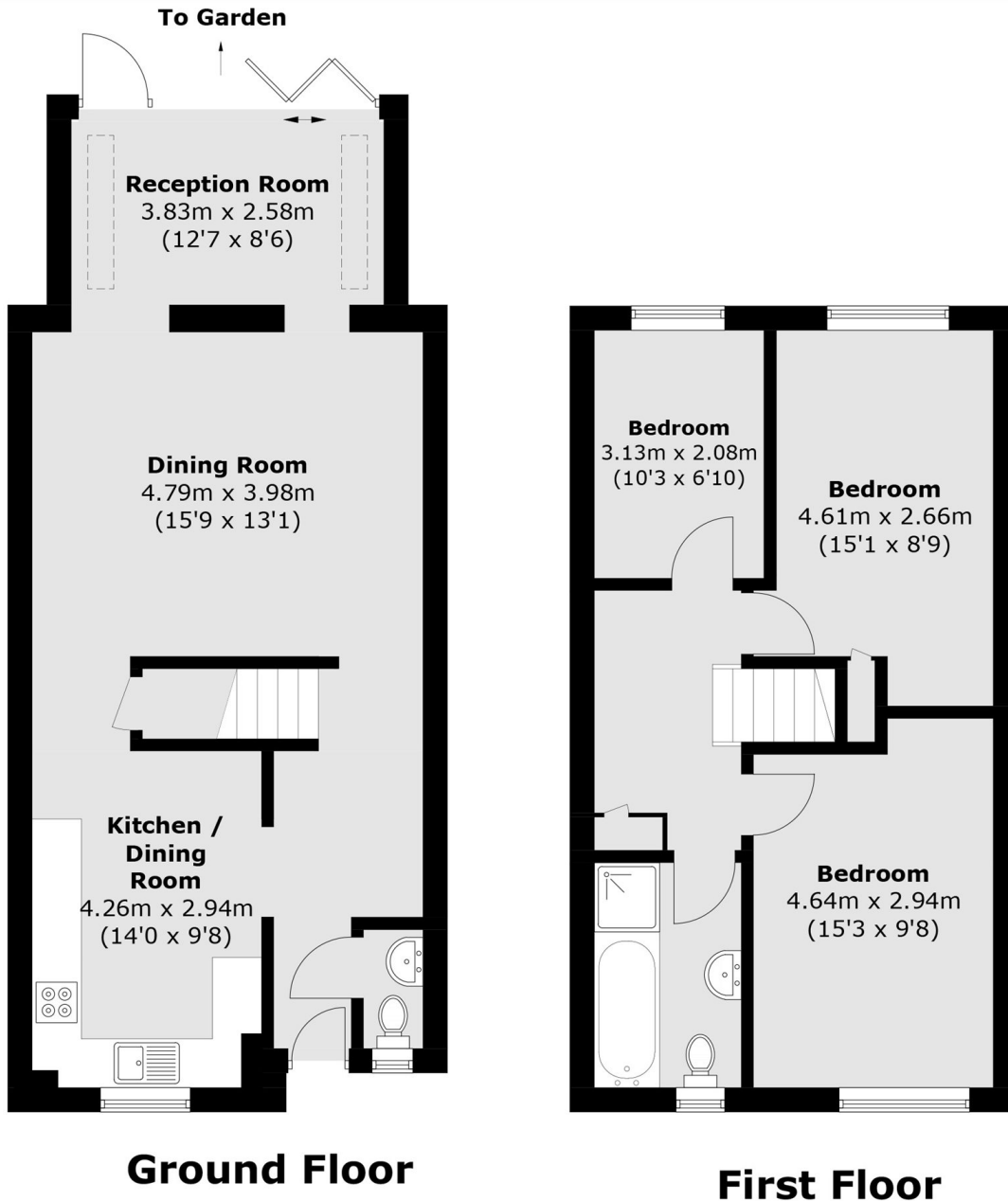

Total area (approx.): 99.5 sq. m (1070.9 sq. ft)