



Nightingale Grove, SE13

£800,000

A recently renovated end of terrace house well positioned moments from Hither Green station. With four bedrooms and three bathrooms and a low maintenance rear garden this recently refurbished house offers the potential to create a beautiful family home.

Nightingale Grove is a quiet residential road located in popular Hither Green and close by to all its local amenities. It is a short walk to Hither Green Station giving frequent services into London and the City.

Features

- Three Bedrooms
- Large Reception Room
- Extended Kitchen Diner
- Chain Free
- Close To Transport Links
- Close To Mountsfield Park

Nightingale Grove, London, SE13

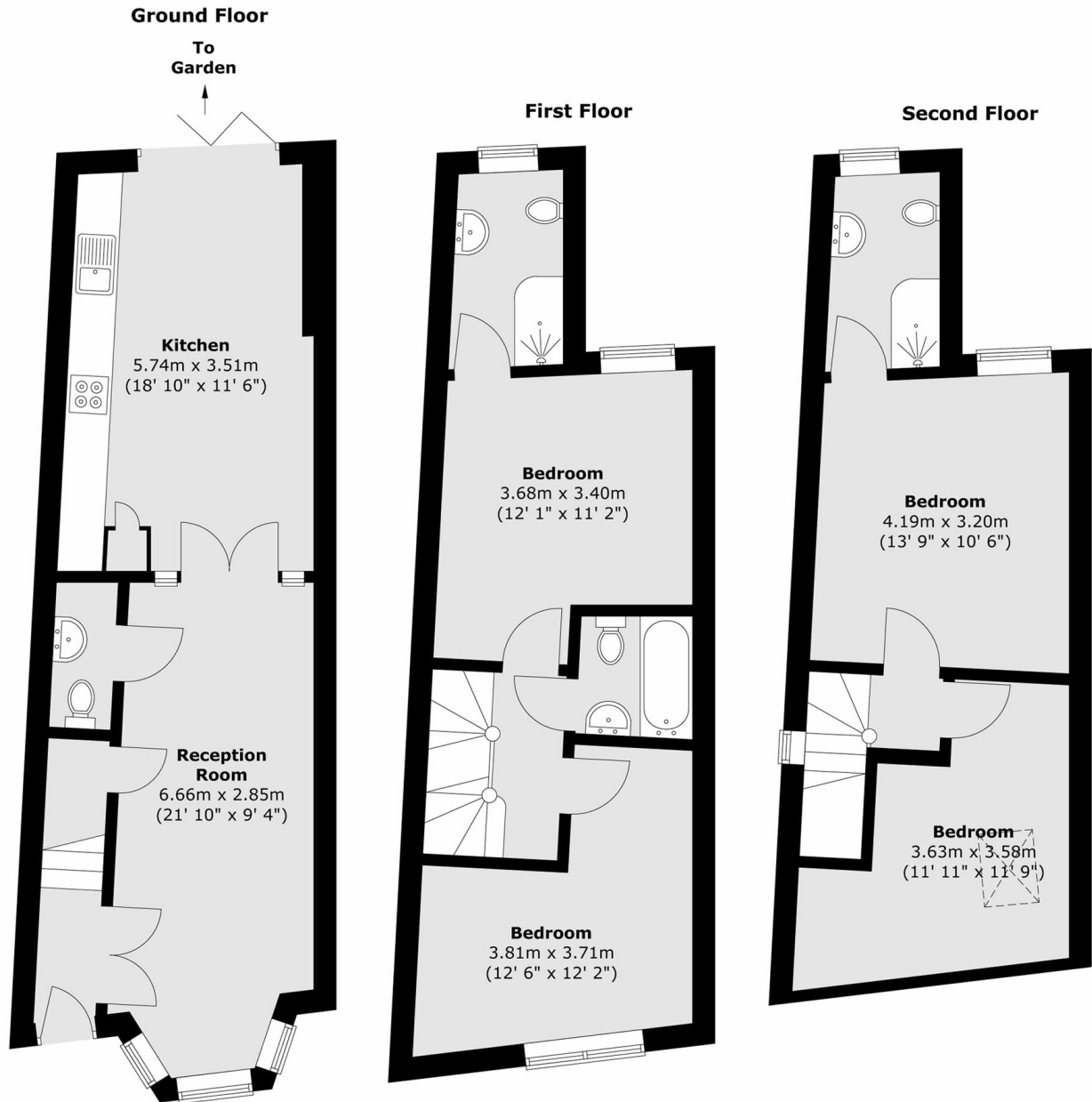

Total area (approx.) : 110.8 sq. m (1193 sq. ft)