



32 Rosetta Road

Southsea, Portsmouth, PO4 8JY

Offers in excess of £250,000



*****SOUGHT AFTER SOUTHSEA CUL-DE-SAC***TWO BEDROOM HOME***FIRST FLOOR BATHROOM***MODERNISED THROUGHOUT & READY TO MOVE INTO***WALKING DISTANCE TO LOCAL SHOPS, PARKS & THE BEACH*****



Welcome to Rosetta Road

Nestled within the quiet and highly desirable cul-de-sac of Rosetta Road, just off Locksway Road, this beautifully presented two-bedroom mid-terraced home is full of charm and character, offering the perfect opportunity for first-time buyers or those looking to downsize.

Ideally positioned within walking distance of the beach, local independent shops including a traditional bakery, butchers, greengrocers and sweet shop, as well as the popular Milton and Bransbury parks, this wonderful home also falls within the catchment for Meon Infant and Junior Academy.

The accommodation begins with a cosy front lounge, complete with an original fireplace creating a warm and inviting focal point. To the rear is a second reception room, currently arranged as a dining area, offering versatile living space alongside useful under-stairs storage. The modern fitted kitchen is well-presented and practical, with a regularly serviced and maintained boiler.

Upstairs, the property comprises two bedrooms and a tastefully modernised bathroom. The spacious main bedroom benefits from wall-to-wall modular wardrobes, providing excellent storage and creating a practical and well-organised space. The second bedroom is a small double, currently used as a study, with a built-in cupboard over the stairs. The stylish bathroom features a larger shower cubicle, WC and a unique contemporary sink unit.

Outside, the private west-facing rear garden has been thoughtfully landscaped with attractive flower beds and a patio seating area, enjoying sunshine throughout the day and into the evening to create the perfect space to relax and entertain. There is also the added benefit of an external storage cupboard.

Lovingly cared for by the current owners, this delightful home offers character, convenience and coastal living in one of the area's most popular locations.

Area Map



Floor Plans

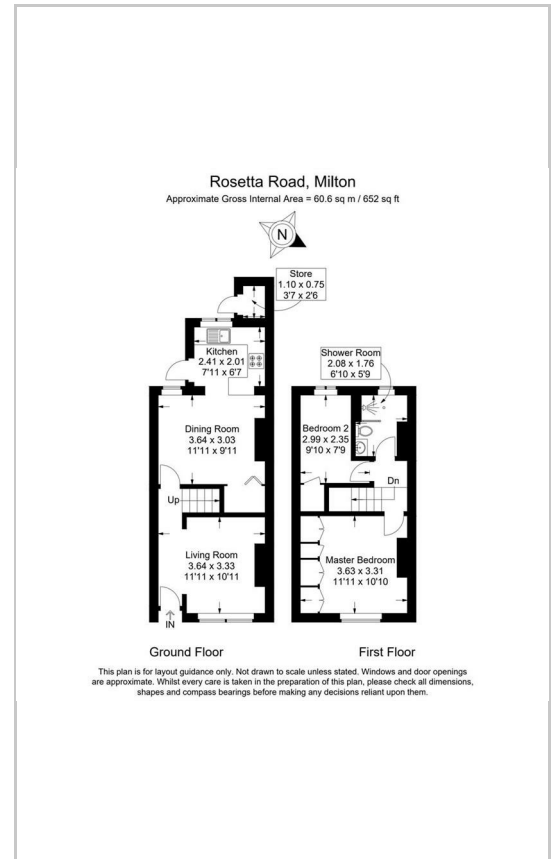

Energy Efficiency Graph

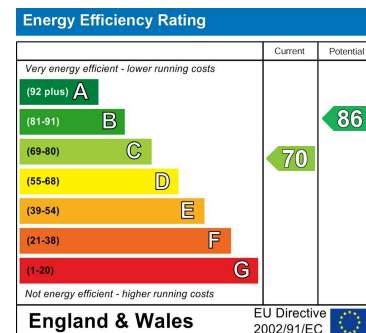

These particulars, whilst believed to be accurate are set out as a general outline only for guidance and do not constitute any part of an offer or contract. Intending purchasers should not rely on them as statements of representation of fact, but must satisfy themselves by inspection or otherwise as to their accuracy. No person in this firm's employment has the authority to make or give any representation or warranty in respect of the property.

Tangier Road, PO3 6PQ

Tel: 02394 217317 Email: sarah@soldby.uk www.soldby.uk