



## FULHAM PALACE ROAD, SW6

£750,000

This stylish two bedroom garden flat, offers excellent entertaining space and is only a short walk to Bishops Park and the Thames Path. The flat has been extended to create an superb open plan reception room, with a

Two double bedrooms  
Private garden  
Share of freehold

Bishop Park  
Two bathrooms  
Open plan kitchen/living room

# STEP INSIDE FULHAM PALACE ROAD

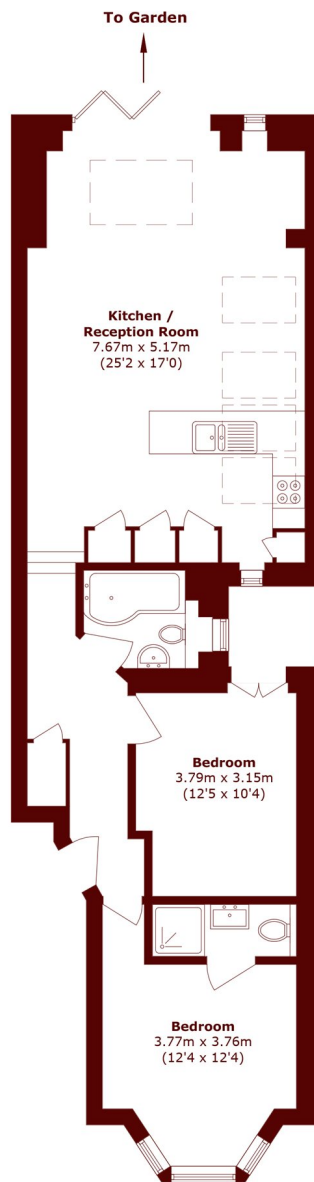

Total area (approx.): 85.4 sq. m (919.2 sq. ft)

**Bishops Park**  
020 7993 9888

Energy Rating: C We aim to make our particulars both accurate and reliable. However, they are not guaranteed; nor do they form part of an offer or contract. If you require clarification on any points then please contact us, especially if you're traveling some distance to view. Please note that appliances and heating systems have not been tested and therefore no warranties can be given as to their good working order

**MARSH &  
PARSONS**