

2a High Street - £1,215 PCM

Mildenhall Suffolk IP28 7EJ

shires

Estate & Letting Agents



"Consistently providing outstanding service to our clients"

£1,215 PCM

The Property

This newly refurbished property is located close to the town centre & RAF bases. The accommodation comprises of a modern kitchen with some built in appliances, lounge, 1 bedroom & a shower room. There is off road parking to the front of the property.

Features

- NEWLY REFURBISHED
- CLOSE TO THE TOWN CENTRE & RAF BASES
- 1 BEDROOM
- GAS HEATING & ENERGY RATING - C
- MODERN KITCHEN WITH SOME BUILT IN APPLIANCES
- APPROXIMATE SIZE - 486 SQ FT
- SHOWER ROOM
- COUNCIL TAX BAND - A
- OFF ROAD PARKING
- AVAILABLE NOW



These sales particulars have been produced as a general guide only and we would draw to your attention that we have not carried out a detailed Survey of the property nor have we tested services, appliances or specific fittings. Whilst measurements and statements given within the details are provided in good faith, their accuracy should not be relied upon. If there are any points about which you may be uncertain or would like further clarification, we would suggest that you telephone this office and speak to our staff who will endeavour to assist you.

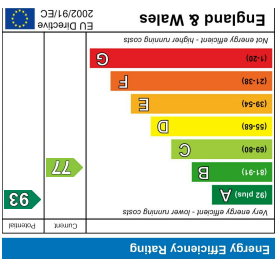

4 New Street, Mildenhall, Suffolk, IP28 7EN
 T: 01638 712132
 E: mildenhall@shiresestateagents.co.uk

Whilst every attempt has been made to ensure the accuracy of the floorplan contained here, measurements of doors, windows, rooms and any other items are approximate and no responsibility is taken for any error, omission or mis-statement. This plan is for illustrative purposes only and should be used as such by any prospective purchaser. The services, systems and appliances shown have not been tested and no guarantee as to their operability or efficiency can be given.
 Made with Metropix ©2023

TOTAL FLOOR AREA : 486 sq.ft. (45.2 sq.m.) approx.

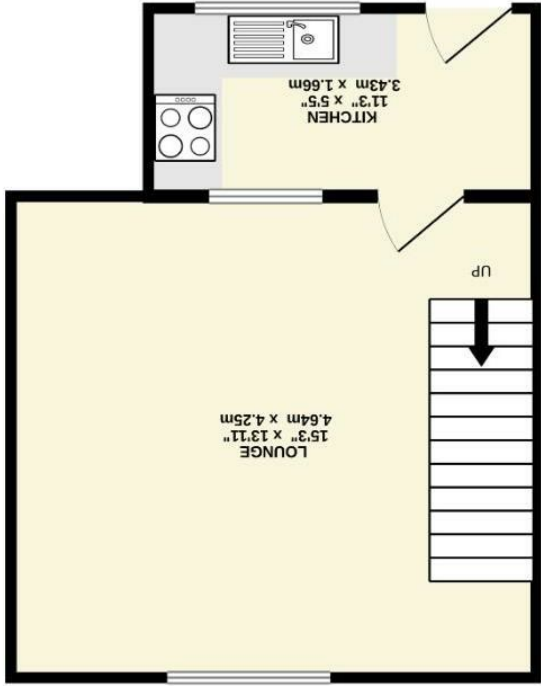

GROUND FLOOR
274 sq.ft. (25.4 sq.m.) approx.

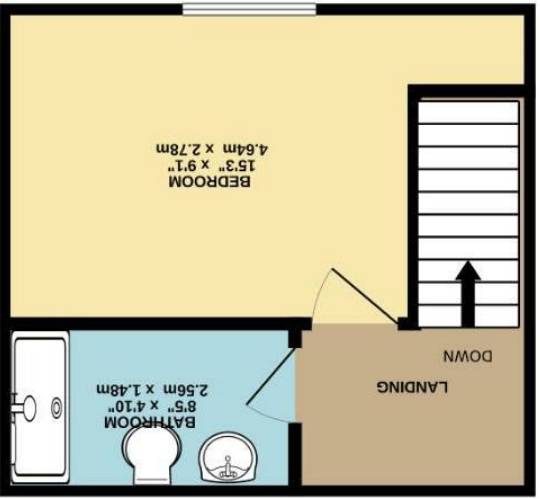

1ST FLOOR
212 sq.ft. (19.7 sq.m.) approx.