



Palace Place Mansions
Kensington Court, W8

CHESTERTONS





A beautifully presented first-floor apartment set within an attractive red-brick mansion block on one of Kensington's most desirable streets.

This impressive home offers two spacious double bedrooms and two contemporary bathrooms, including an en-suite to the principal bedroom. The apartment features a bright and elegant reception room with high ceilings, a fully fitted bespoke Urban Myth kitchen, and stylish modern interiors throughout.

The kitchen is finished with granite worktops and integrated Siemens appliances, while the reception room benefits from a 50" Smart TV and a sophisticated Hamilton lighting system, creating a comfortable and refined living space.

Both bathrooms are fitted with high-quality Porcelanosa ceramics, and underfloor heating runs throughout the apartment, adding to the sense of comfort and luxury.

Ideally located close to Hyde Park, the property is perfectly positioned for the excellent amenities, restaurants, and transport links of Kensington High Street and Kensington Park Gardens.

- Contemporary 2 double bedroom mansion flat
- Finished to high standard
- Eat in kitchen and two luxury bathrooms
- Just off Kensington High Street
- Bathrooms are fitted with Porcelanosa Ceramics

£5,950 pcm

Additional tenant charges apply (fees apply to non-AST tenancies only)

Tenancy Agreement Fee: £300

References per Tenant/Guarantor: £60

Inventory check (approx. £100 – £250 inc. VAT)

chestertons.co.uk/property-to-rent/applicable-fees

Energy Efficiency Rating		Current	Potential
95-100	A		
81-94	B		
69-80	C	72	75
55-68	D		
39-54	E		
21-38	F		
1-20	G		

Not energy efficient - higher running costs

England, Scotland & Wales EU Directive 2002/91/EC

Minimum Term: 6 months
Deposit Required: £6,865.38
Local Authority: Kensington and Chelsea
Council Tax Band: G
EPC Rating: C
Furnished

Chestertons Kensington Lettings

116 Kensington High Street
 Kensington
 London
 W8 7RW

kensingtonlettingsusers@chestertons.co.uk
 02079377260

Kensington Court, London, W8

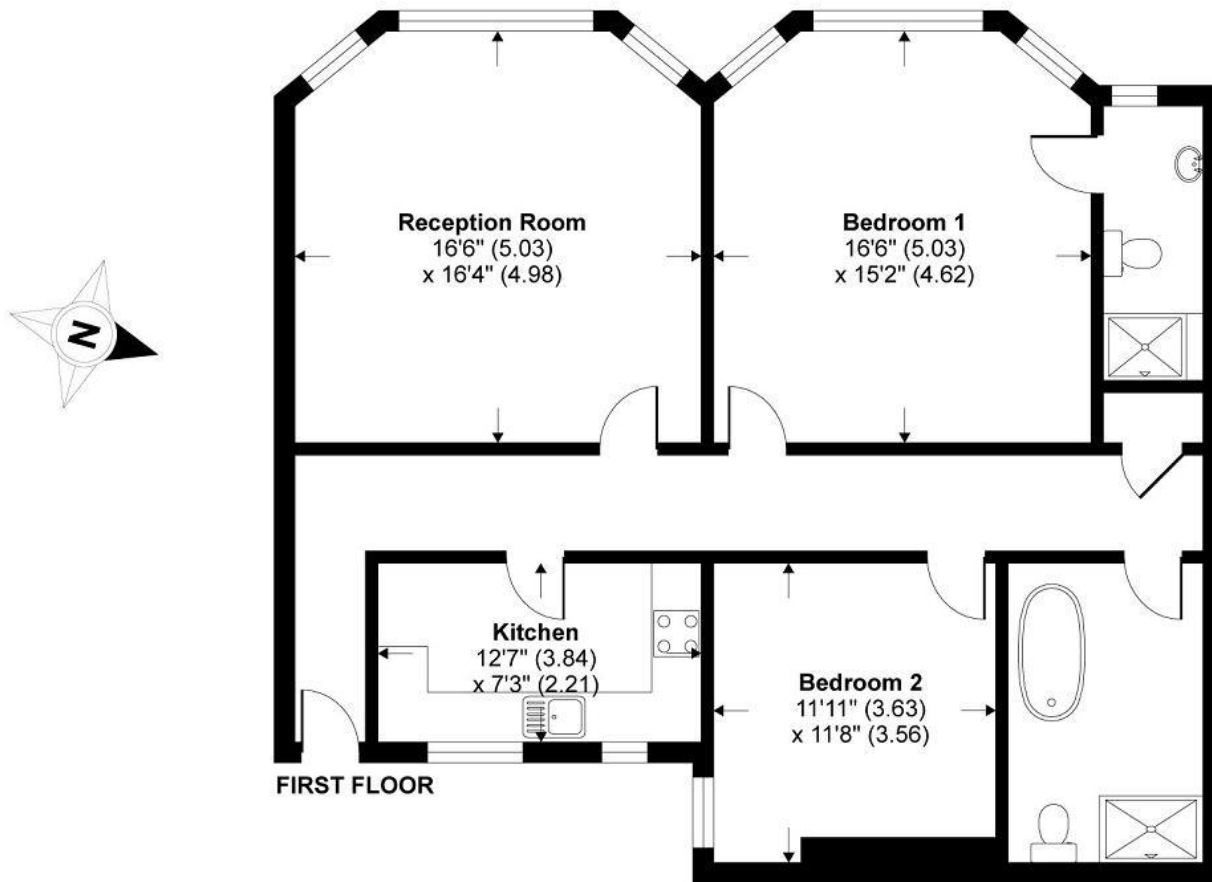

TOTAL GROSS INTERNAL FLOOR AREA 1098 SQ FT 102 SQ METRES

Whilst every attempt has been made to ensure the accuracy of the floor plan contained here, measurements of doors, windows and rooms are approximate and no responsibility is taken for any error, omission or misstatement. These plans are for representation purposes only as defined by RICS Code of Measuring Practice and should be used as such by any prospective purchaser. Specifically no guarantee is given on the total square footage of the property if quoted on this plan. Any figure given is for initial guidance only and should not be relied on as a basis of valuation.

Copyright nichecom.co.uk 2013 Produced for Chesterton Humberts REF : 407620

Chesterton UK Services Limited trading as Chestertons for themselves and for the vendor of this property whose agents they are, give notice that (i) these particulars do not constitute any part of an offer or contract, (ii) all statements contained within these particulars are made without responsibility on the part of Chestertons or the vendor, (iii) whilst made in good faith, none of the statements contained within these particulars are to be relied upon as a statement or representation of fact, (iv) any intending purchasers must satisfy themselves by inspection or otherwise as to the correctness of each of the statements contained within these particulars, (v) the vendor does not make or give either Chestertons or any person in their employment any authority to make or give representation or warranty whatsoever in relation to this property. Wide angle lenses may be used. ©Copyright Chestertons | Chesterton Global Ltd | Registered Office 5th Floor, The Lantern, 75 Hampstead Road, London, NW1 2PL Registered Company Number 05334580.



This paper is
100% recyclable