

# Towers Wills

Town & Country

📞 01935 577 032 | 01460 298 530 | ✉ info@towerswills.co.uk



16, Shearstone, Yetminster, Sherborne, Dorset DT9  
6NW

Guide Price **£385,000**

Towers Wills welcome to the market this beautifully presented detached bungalow situated in a quiet cul de sac position within this sought after village. Offering x3 double bedrooms, master en-suite, open plan kitchen/ diner, living room, bathroom, driveway, garage, front and rear gardens.

## Accommodation:

Nestled in a quiet and desirable cul-de-sac within the highly sought-after village of Yetminster, this beautifully presented three-bedroom detached bungalow offers spacious and versatile accommodation ideal for modern family living.

Upon entering, a welcoming porch leads into a generous reception hallway, setting the tone for the well-maintained and thoughtfully arranged interior. To the front of the property, a separate living room provides a cosy yet elegant space for relaxation.

At the heart of the home lies a stunning open-plan kitchen/diner, perfectly designed for both everyday living and entertaining. The kitchen is fitted with an attractive range of wall, base, and drawer units complemented by quality work surfaces, a Belfast sink, and space for a range cooker with a cooker hood above. A doorway leads through to a practical utility room which benefits from an additional sink and drainer, further worktop space, and plumbing for a washing machine, tumble dryer, and dishwasher. Doors from the utility room provide sheltered access to both the front and rear, as well as to the garage.

The bungalow boasts three double bedrooms, with the master bedroom enjoying the added benefit of a modern en-suite shower room. A stylish family bathroom completes the internal accommodation, offering comfort and functionality in equal measure.

Externally, the property is equally impressive. To the front, a driveway provides off-road parking alongside a neat lawned garden. To the rear, a substantial and well-maintained garden stretches out, mostly laid to lawn and bordered by mature shrubs and fencing, creating a private and peaceful outdoor space. A decked seating area at the far end and a large patio terrace adjoining the house offer ideal spots for al fresco dining and entertaining.

## Yetminster

The charming village of Yetminster, located in the beautiful Dorset countryside, is renowned for its picturesque streets, historic architecture, and strong sense of community. With its traditional stone cottages and period buildings, Yetminster offers a quintessential English village lifestyle while providing excellent amenities including a village store, pub, church, primary school, and a train station with regular links to both Dorchester and Yeovil.

Surrounded by rolling countryside, Yetminster is perfect for those who enjoy outdoor pursuits, with a wealth of walking and cycling routes on the doorstep. The village also boasts a vibrant calendar of local events and a friendly community spirit, making it an ideal setting for families, retirees, or anyone seeking a peaceful yet well-connected rural retreat.

## Key Features

- Beautifully Presented Throughout
- Sought-after Village
- Detached Bungalow
- Three Bedrooms
- Master En-suite
- Gardens
- Driveway & Garage

## Contact Us

### Towers Wills Estate Agents - Yeovil

114, Hendford Hill

Yeovil

Somerset

BA202RF

T: 01935 577032

E: [info@towerswills.co.uk](mailto:info@towerswills.co.uk)

## Energy Efficiency

Score	Energy rating	Current	Potential
92+	A		
81-91	B		
69-80	C		
55-68	D	56 D	67 D
39-54	E		
21-38	F		
1-20	G		

For more information or to arrange a viewing, contact us today –  
properties of this calibre in Yetminster rarely stay on the market for long!



# Floor Plan

## GROUND FLOOR

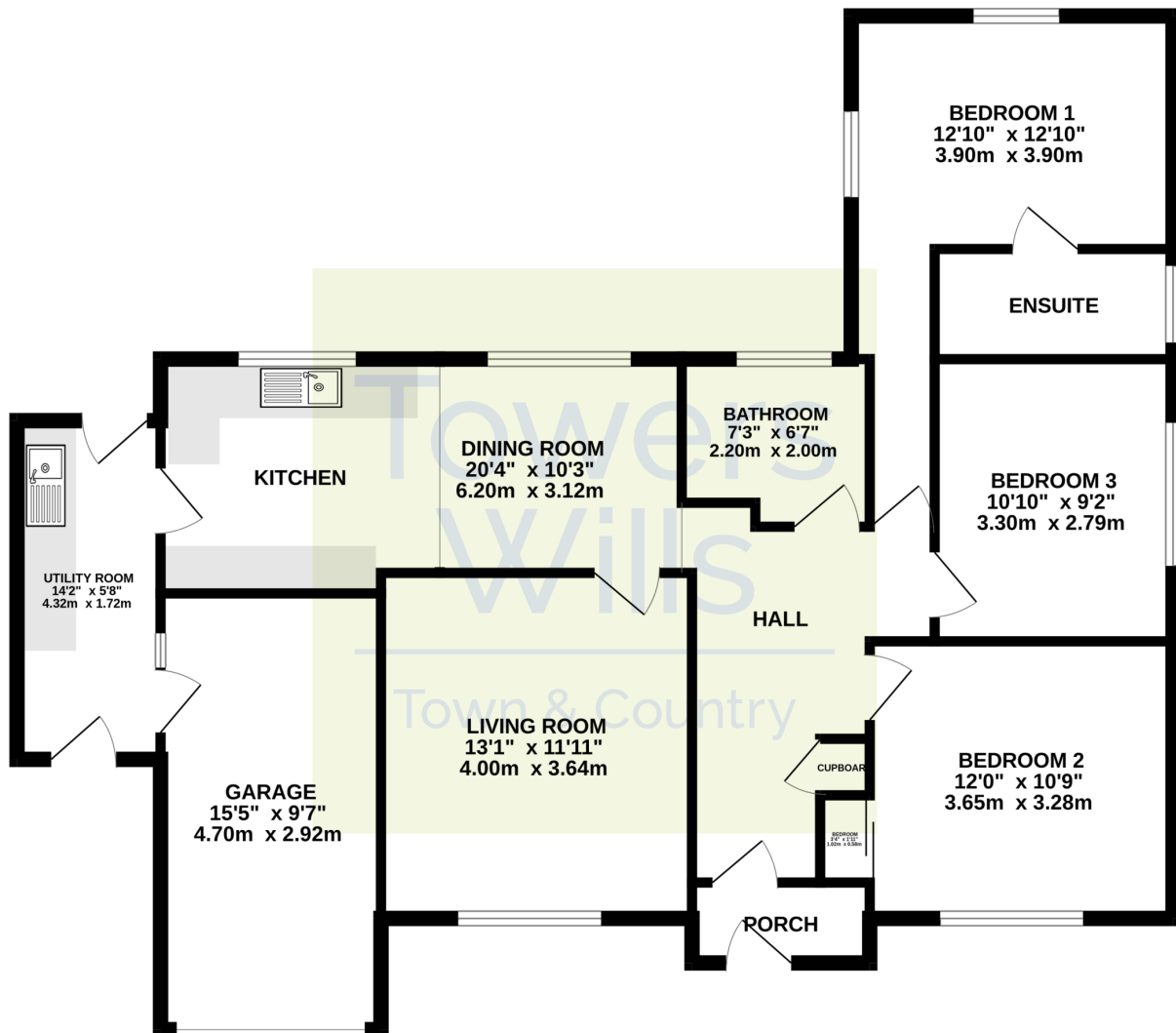

Whilst every attempt has been made to ensure the accuracy of the floorplan contained here, measurements of doors, windows, rooms and any other items are approximate and no responsibility is taken for any error, omission or mis-statement. This plan is for illustrative purposes only and should be used as such by any prospective purchaser. The services, systems and appliances shown have not been tested and no guarantee as to their operability or efficiency can be given.  
Made with Metropix ©2025

Please Note No tests have been undertaken of any of the services and any intending purchasers should satisfy themselves in this regard. Towers Wills Ltd for themselves and for the vendor of this property whose agents they are, give notice that, (i) these particulars do not constitute any part of an offer or contract, (ii) all statements contained within these particulars are made without responsibility on the part of Towers Wills or the vendor, (iii) whilst made in good faith, none of the statements contained within these particulars are to be relied upon as a statement of representation or fact, (iv) any intending purchaser must satisfy him/herself by inspection or otherwise as to the correctness of each of the statements contained within these particulars, (v) the vendor does not make or give either Towers Wills or any person in their employment any authority to make or give representation or warranty whatsoever in relation to this property.

Photographs / Floor Plans Photographs are reproduced for general information and it must not be inferred that any item is included for sale with this property. Please note floor plans are not to scale and are for identification purposes only. The photographs used in these particulars may have been taken with the use of a wide angle lens. If you have any queries as to the size of the accommodation or plot, please address these with the agent prior to making an appointment to view

**Towers Wills**

The White House, 114 Hendford Hill, Yeovil BA20 2RF

Yeovil 01935 577032 / South Petherton 01460 298530

[info@towerswills.co.uk](mailto:info@towerswills.co.uk) | [www.towerswills.co.uk](http://www.towerswills.co.uk)