

# Colne Road, Bluntisham, Huntingdon, PE28 3LU

Offers Over £650,000

5 3 3

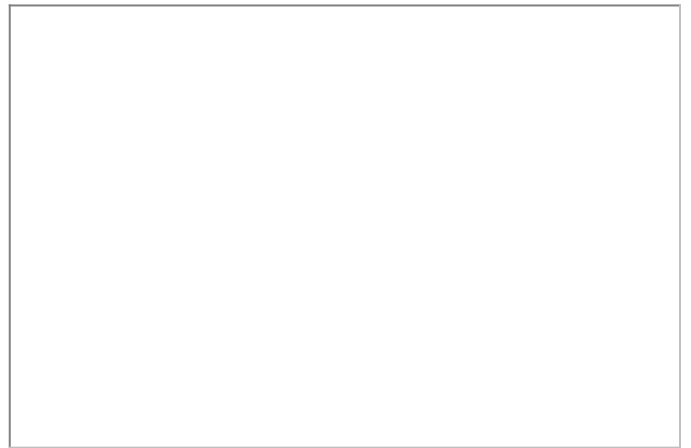

- Over 2,200 sq ft of beautifully updated family living
- Five generous bedrooms across the first floor
- Refitted kitchen/breakfast room with garden room extension
- Double garage and large driveway for four vehicles
- Virtual tour available upon request
- Two reception rooms – perfect for entertaining or relaxing
- Two stylish ensuite shower rooms & modern family bathroom
- Stunning bifold doors, skylights & feature garden views
- Set in a peaceful private development in Bluntisham
- EPC Rating: C/73

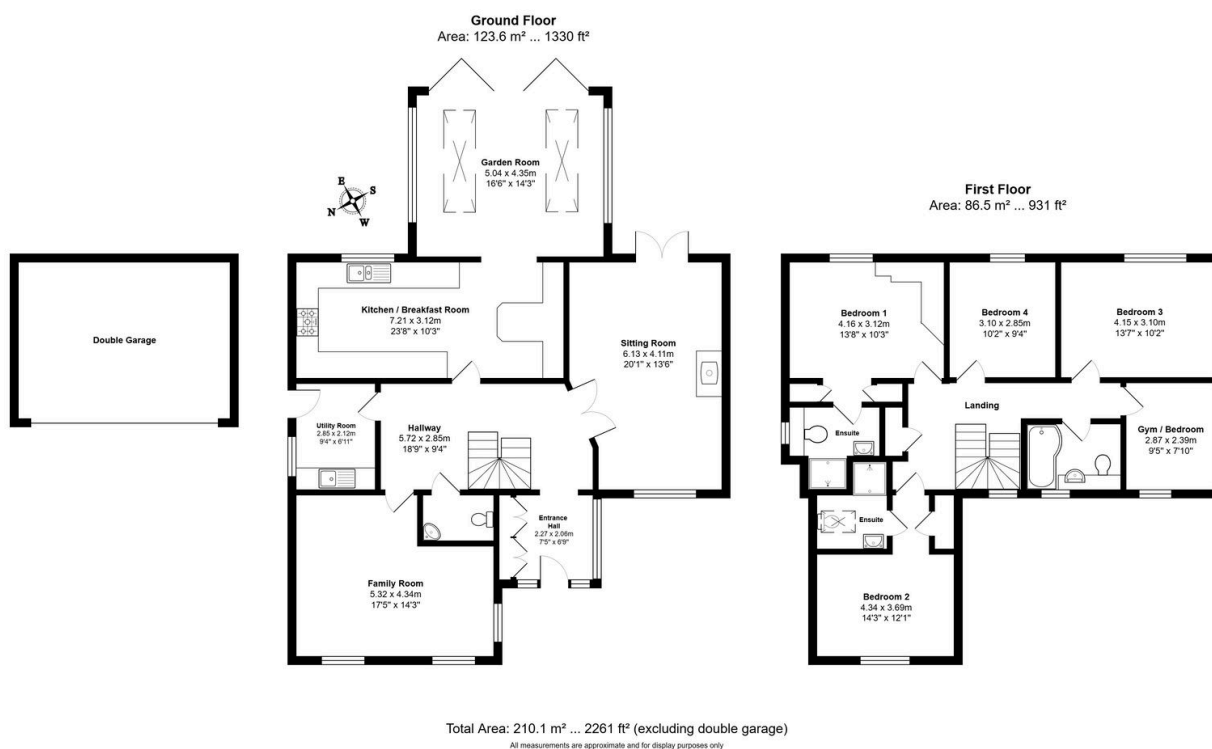

**\*\*If Calling to Enquire - Quote ref KP0855 - Colne Road\*\*** A beautifully extended and reimagined five-bed executive home in a sought-after private development in Bluntisham, offering over 2,200sqft of stylish family living, landscaped gardens and superb entertaining space.