



27 Merchant Square, Portishead, BS20 7PD

£950 PCM

GOODMAN
& LILLEY



THE INDEPENDENT SALES, LETTINGS & LAND AGENTS

27 Merchant Square, Portishead, BS20 7PD

Goodman and Lilley are delighted to offer to the market this well presented one bedroom top floor apartment located in the heart of Portishead marina. The flat comprises of an open-plan lounge/diner with balcony offering views over the Marina, a modern fitted kitchen with white goods included, one spacious double bedroom and family sized bathroom with shower over the bath. The flat further benefits from one allocated parking space and access to the communal bike store.

EPC: B

Council Tax Band: B

A one week holding deposit is required to reserve this property.

Damages deposit: £1096.15

- Lower Portishead
- Unfurnished Property
- Sorry, No Smokers
- 1 Bedroom
- Flat
- Allocated Parking Available
- No Garden
- 1 Bathroom

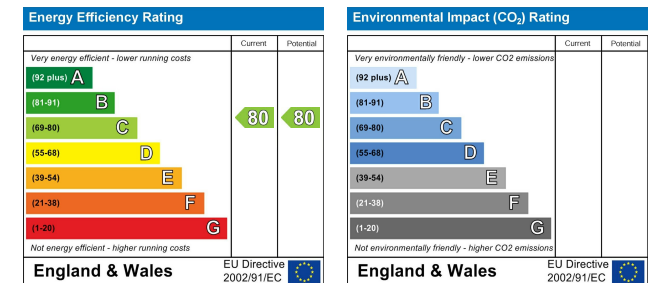

Bristol

9 High Street, Shirehampton

Bristol BS11 0DT

01172 130333

www.goodmanlilley.co.uk



Second Floor

Approx. 47.1 sq. metres (507.5 sq. feet)

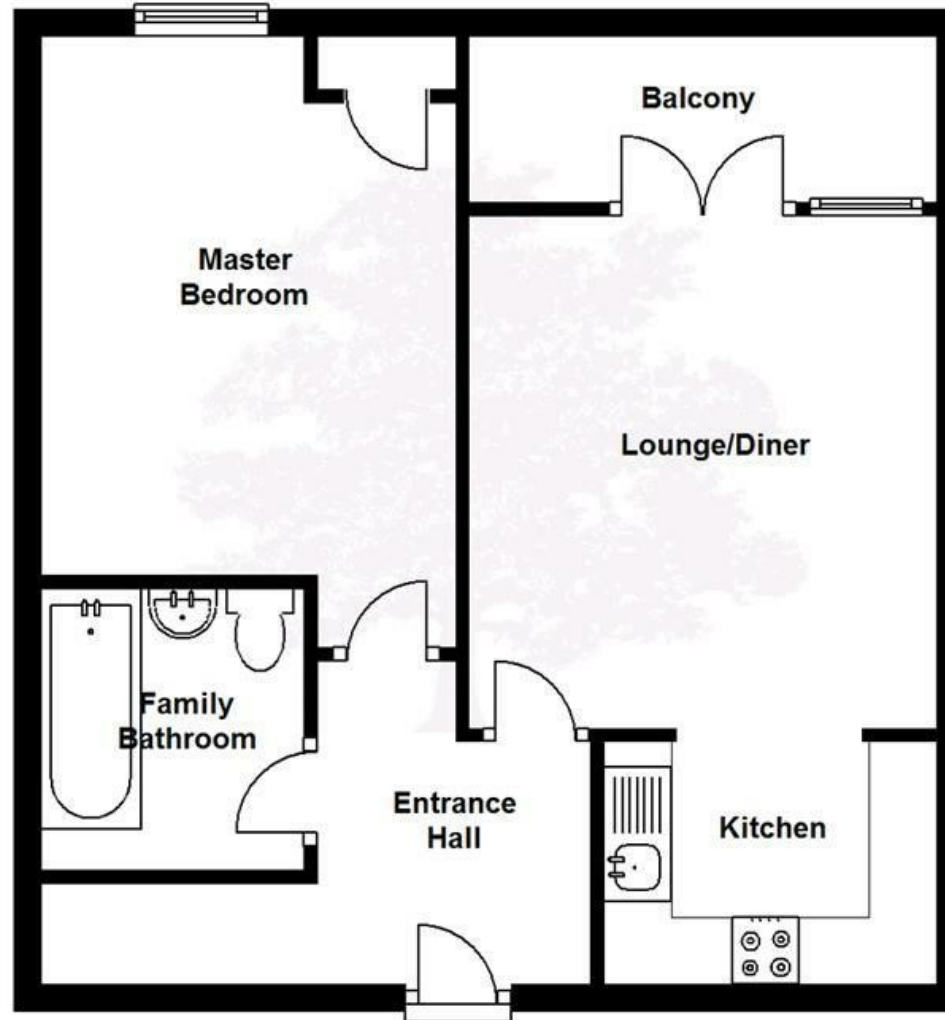

Total area: approx. 47.1 sq. metres (507.5 sq. feet)



These particulars are for general guidance only. They do not form or constitute any part of an offer or contract. Goodman & Lilley has not carried out structural surveys of the property. The services, appliances or specific fittings mentioned in these details have not been tested. Every attempt is made to ensure accuracy, however all photographs, measurements, floor plans and distances are for illustrative purposes only. They must not be relied upon when purchasing carpets and or other fixtures and fittings. Lease details, service charges and ground rents are given as a guide only. They should be checked and confirmed by a licensed solicitor prior to exchange of contracts. The copyright of all details, photographs and floor plans remain exclusive to Goodman & Lilley.