



St Mary Abbots Court | Holland Park | London | W14

Asking Price - £2,250,000



- Four bedrooms
- Double reception room
- Portered building
- Four bathrooms
- Located in Warwick Gardens
- Period building

Located within the highly regarded St Mary Abbots Court on Warwick Gardens, this substantial four bedroom lateral apartment occupies the sixth floor of a well maintained portered block with lift access.

The apartment extends to approximately 2,488 sq ft and benefits from a flexible layout and excellent natural light throughout. A generous entrance hall with bay window and guest WC leads to a large west facing double reception, ideal for both entertaining and day to day living.

The kitchen and breakfast room includes a useful utility cupboard, while a separate study area provides dedicated space for home working. There are four well-proportioned bedrooms, two with ensuite bathrooms, in addition to two further bathrooms.





St Mary Abbots Court is positioned at the corner of Warwick Gardens and Kensington High Street, moments from a wide range of shops, restaurants and transport links, including Kensington High Street (Piccadilly Line), West Kensington (District Line) and Kensington Olympia (Overground). Holland Park is also within easy walking distance.

*Please note, CGI furniture has been digitally added



*Please note, CGI furniture has been digitally added

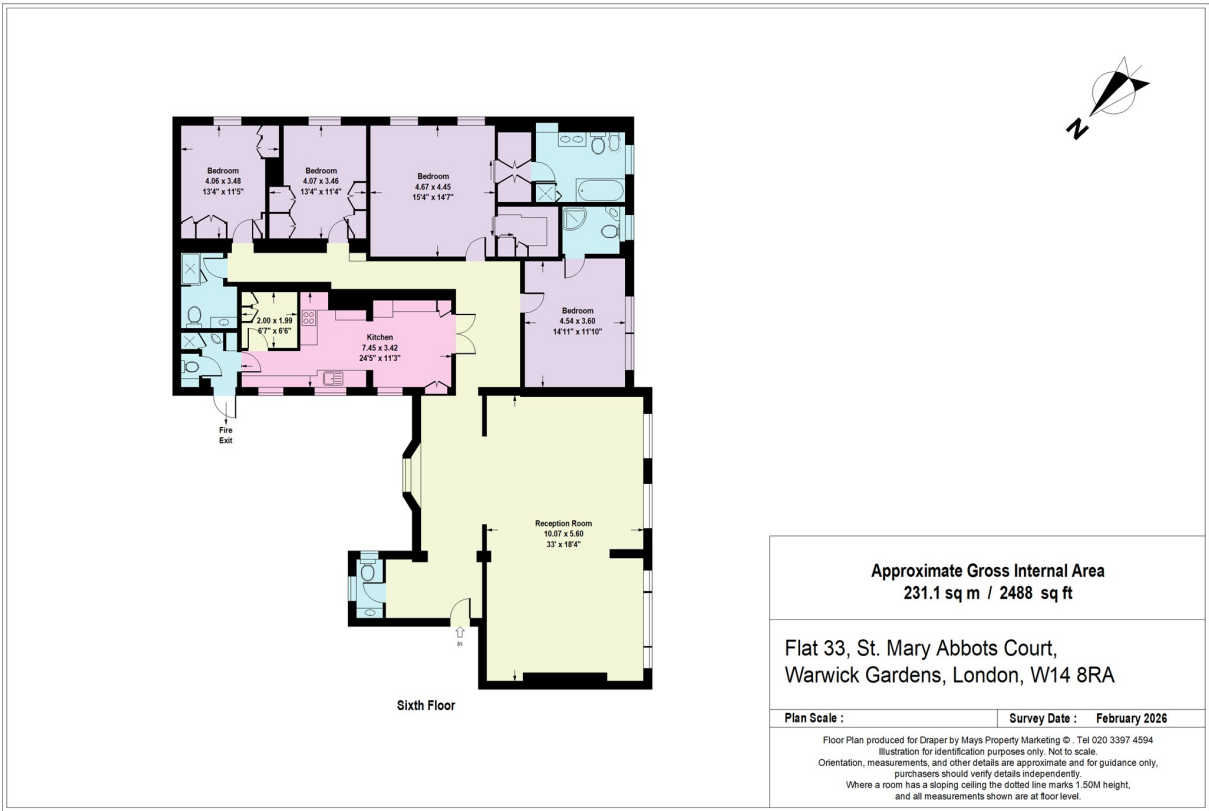

Council Tax Band H EPC Rating C

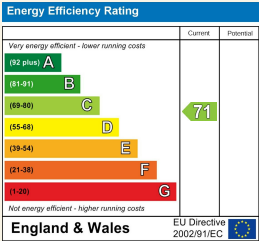

24 Bristol Gardens
London
W9 2JQ
hello@draperlondon.com
0203 143 1900