



## CREEK ROAD, SE10

£495,000

Victorian conversion flat  
Two bedrooms  
High ceilings  
Private roof terrace  
Located in the town centre  
Energy rating: d

@marshandparsons  
marshandparsons.co.uk

MARSH &  
PARSONS



# ABOUT THE PROPERTY

First floor Victorian conversion flat located in the heart of the town centre, featuring a private roof garden and it's own private entrance. The interior has been tastefully refurbished and designed including a new roof, brick exposed walls and has high ceilings. Accommodation comprises a spacious lounge/diner, open plan kitchen, two double bedrooms and a modern bathroom suite.

Situated in the heart of central Greenwich, moments away from the covered market, Cutty Sark DLR station, Greenwich pier and a wide range of shops, riverside pubs, restaurants, gyms and supermarkets. Greenwich's royal park is a very short walk away, as well as Greenwich train station.



# STEP INSIDE CREEK ROAD

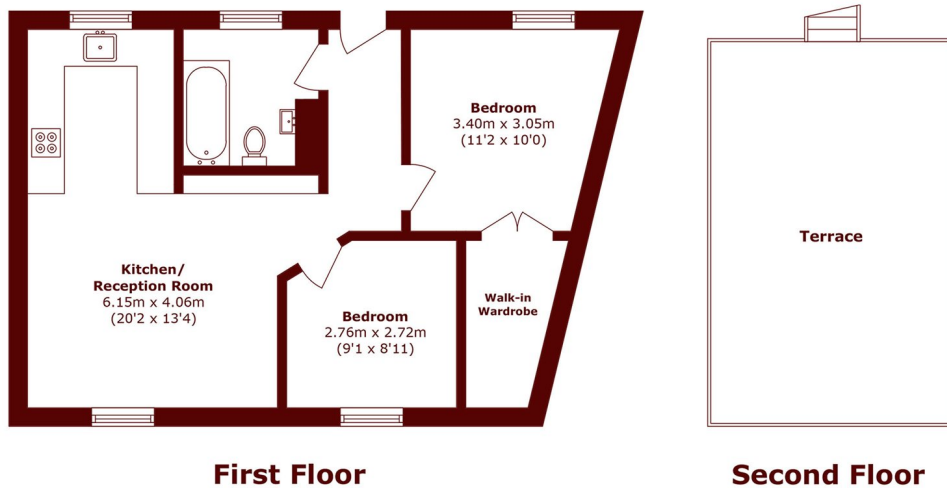

**First Floor**

**Second Floor**

Total area (approx.): 54.5 sq. m (586.6 sq. ft)

Terrace area (approx.): 25.5 sq. m (274.4 sq. ft)

**Greenwich**  
020 8312 8312

Energy Rating: D We aim to make our particulars both accurate and reliable. However, they are not guaranteed; nor do they form part of an offer or contract. If you require clarification on any points then please contact us, especially if you're traveling some distance to view. Please note that appliances and heating systems have not been tested and therefore no warranties can be given as to their good working order

**MARSH &  
PARSONS**