



Pool Close
Pinxton Nottingham



Property Description

Situated in a village location is this well maintained and presented home having under gone a slight refurbishment. The accommodation comprises of; reception lounge and kitchen diner with integrated oven and hob. Ground floor cloakroom with two piece suite. To the first floor are two double bedrooms and bathroom with three piece suite. Outside are gardens to the front and rear, the rear garden being laid to lawn with fence surround and vehicle standing space. The property has double glazed windows and a gas heating system.

Ground Floor

Reception Lounge

Having wall mounted electric fire, ceiling coving, radiator and double glazed window to the front.

Kitchen/Diner

Fitted with a range of wall and base units with complementary work surfaces over incorporating a single drainer sink unit. Integrated four ring electric hob and oven with extractor hood over. Recess lighting, plumbing for the automatic washing machine and wall mounted gas heating boiler. Double glazed window to the rear and french style door to the rear.

Cloakroom

Two piece suite comprising of wash hand basin and low flush W/C. Tiled splashbacks, double glazed window to the side and cupboard providing storage.

First Floor

Landing

With access to;

Bedroom One

Double glazed window to the front and radiator.

Bedroom Two

Double glazed window to the rear and radiator.

Bathroom

Three piece suite comprising of panel bath, low flush W/C and wash hand basin. Heated towel rail and double glazed window to the rear.

Outside

The front of the property has a walled frontage and an area of lawn. The rear garden is enclosed by fencing, has a paved patio area and is laid to lawn. Gated access

to the rear leads to an area of hardstanding providing vehicle standing space.







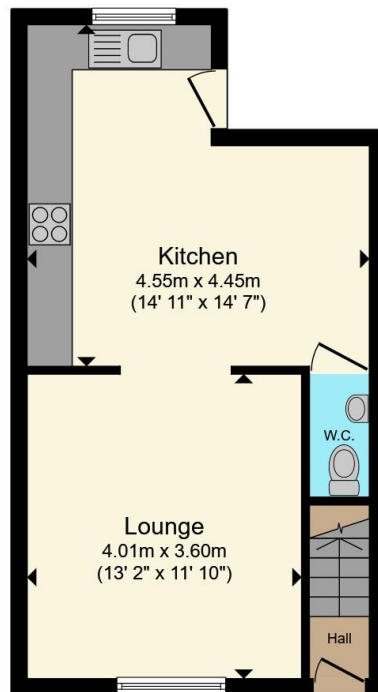

Ground Floor

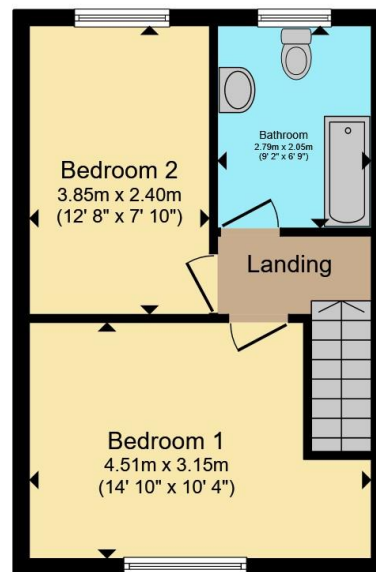

First Floor

Total floor area 68.6 m² (738 sq.ft.) approx

This floor plan is for illustrative purposes only. It is not drawn to scale. Any measurements, floor areas (including any total floor area), openings and orientation are approximate. No details are guaranteed, they cannot be relied upon for any purpose and they do not form part of any agreement. No liability is taken for any error, omission or misstatement. A party must rely upon its own inspection(s). Powered by www.propertybox.io



To view this property please contact Hall & Benson on

T 01773 521771
E alfreton@hallandbenson.co.uk

22A High Street
ALFRETON DE55 7BN

EPC Rating: D Council Tax
Band: A

view this property online hallandbenson.co.uk/Property/ALF104307

Tenure: Freehold



1. MONEY LAUNDERING REGULATIONS Intending purchasers will be asked to produce identification documentation at a later stage and we would ask for your co-operation in order that there will be no delay in agreeing the sale. 2. These particulars do not constitute part or all of an offer or contract. 3. The measurements indicated are supplied for guidance only and as such must be considered incorrect. Potential buyers are advised to recheck measurements before committing to any expense. 4. We have not tested any apparatus, equipment, fixtures, fittings or services and it is in the buyers interest to check the working condition of any appliances.

Hall & Benson is a trading name of Connells Residential which is registered in England and Wales under company number 1489613, Registered Office is Cumbria House, 16-20 Hockliffe Street, Leighton Buzzard, Bedfordshire, LU7 1GN. VAT Registration Number is 500 2481 05.

See all our properties at www.hallandbenson.co.uk | www.rightmove.co.uk | www.zoopla.co.uk

Property Ref: ALF104307 - 0004