



# TO LET

**Jessop Avenue, Southall, UB2 5UY**  
**£2,400 Per Calendar Month**

**DBK**  
ESTATE AGENTS

- Available to Rent Immediately!
- Semi-Detached Property
- Newly Refurbished
- Modern Kitchen
- Family Bathroom W/C
- Off Street Parking
- Fitted Wardrobes
- Four Sizeable Bedrooms
- Southall Station 0.7 miles
- Norwood Green Junior School 0.2 miles

## THE PROPERTY

Available To Rent Immediately!

This newly refurbished semi-detached property offers spacious and modern family living in a highly convenient location. Finished to a high standard throughout, the home features a stylish modern kitchen with ample storage and workspace, along with a well presented family bathroom with W/C. Bright and airy interiors create a welcoming atmosphere, ideal for comfortable day to day living.

The property comprises four sizeable bedrooms, all benefiting from fitted wardrobes that provide excellent built in storage. Outside, there is the added advantage of off street parking for convenience. Ideally situated, the home is just 0.7 miles from Southall Station and 0.2 miles from Norwood Green Junior School, making it particularly appealing for both commuters and families.

The surrounding area offers a range of local amenities including shops, parks, and everyday conveniences, all within easy reach. With its combination of generous living space, modern finishes, and an excellent location, this property is perfectly suited to families seeking a comfortable and well-connected home.

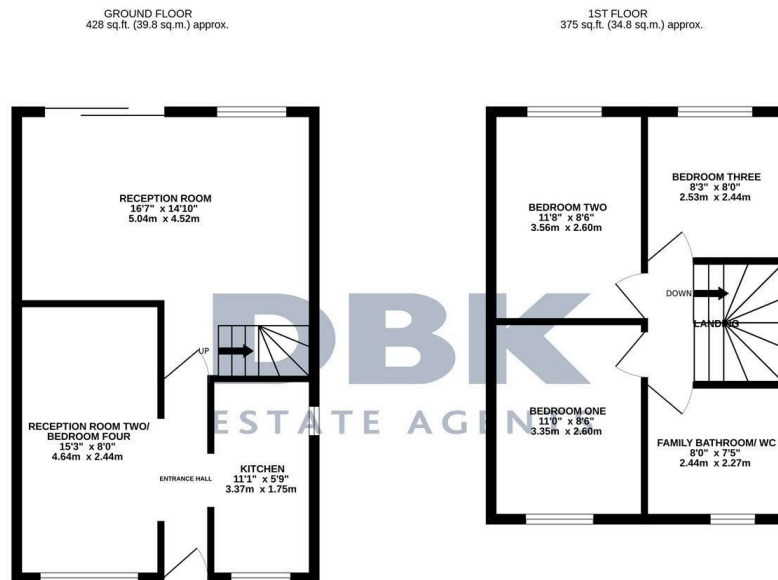

TOTAL FLOOR AREA: 803 sq.ft. (74.6 sq.m.) approx.

Whilst every attempt has been made to ensure the accuracy of the floorplan contained here, measurements of doors, windows, rooms and any other items are approximate and no responsibility is taken for any error, omission or mis-statement. This plan is for illustrative purposes only and should be used as such by any prospective purchaser. The services, systems and appliances shown have not been tested and no guarantee as to their operability or efficiency can be given.

Made with Metropix C2028