



## 12 Bramley Gardens

Ashford, TN23 6GY

Price £260,000

A delightful semi detached bungalow in a peaceful cul de sac position, offered for sale with no onward chain. Built specifically for the over 49's, the property comprises an entrance hall, sitting/dining room, kitchen, two bedrooms and bathroom/WC. Allocated parking is conveniently available whilst the the property also benefits from gas central heating and double glazing.

- SEMI DETACHED BUNGALOW
- FOR OVER 49's
- TWO BEDROOMS
- ENCLOSED REAR GARDEN
- GAS CENTRAL HEATING
- DOUBLE GLAZING
- ALLOCATED PARKING
- QUIET CUL DE SAC LOCATION
- NO ONWARD CHAIN

### Viewing

Please contact our Ashford Office on 01233 646411 if you wish to arrange a viewing appointment for this property or require further information.



# Floor Plan

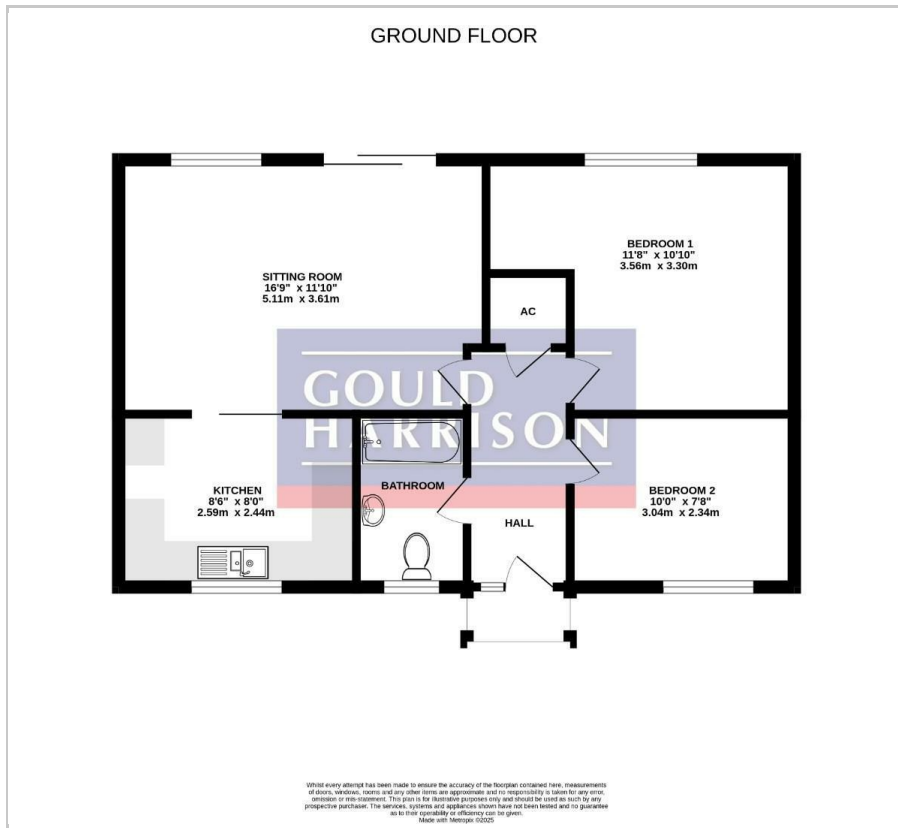

# Area Map

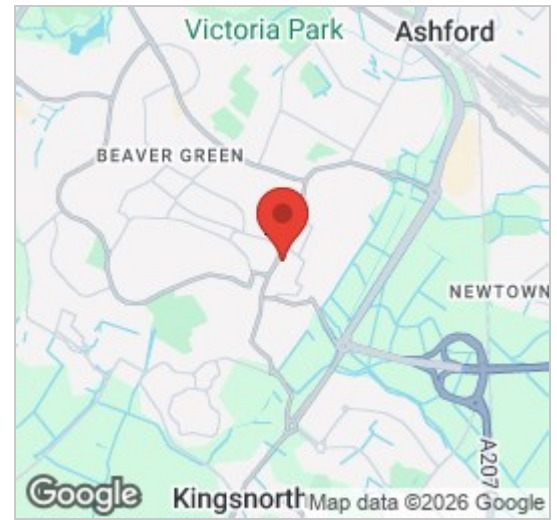

# Energy Efficiency Graph

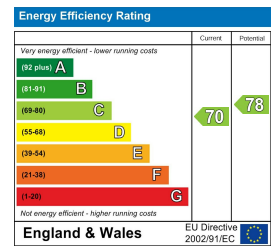

These particulars, whilst believed to be accurate are set out as a general outline only for guidance and do not constitute any part of an offer or contract. Intending purchasers should not rely on them as statements of representation of fact, but must satisfy themselves by inspection or otherwise as to their accuracy. No person in this firm's employment has the authority to make or give any representation or warranty in respect of the property.