



Connells

Spitfire Road
Upper Cambourne



Immaculately presented throughout, this modern semi-detached home features open plan living downstairs with a well appointed kitchen and living/dining room opening onto the rear garden. Three well proportioned bedrooms and a family bathroom complete upstairs with driveway parking for two cars.

Entrance Hall

Door to front, stairs to first floor accommodation, radiator.

Cloakroom

Window to front, wash hand basin, WC, tiled splash back, extractor fan, radiator.

Lounge

Two windows to rear, window to side, under stairs cupboard, telephone point, television point, three radiators, door to rear.

Kitchen

Window to front, wall and base units with complementary work surface and splash back, stainless steel sink with one and a half bowl and drainer, electric oven, four burner gas hob, cooker hood, integrated dishwasher, fridge/freezer and washing machine, integrated recycling bin, boiler.

Landing

Stairs from first accommodation.



Bedroom One

Two windows to front, airing cupboard, television point, radiator.

Bedroom Two

Window to rear, telephone point, television point, radiator.

Bedroom Three

Window to rear, loft access, radiator.

Bathroom

Window to side, bath with mixer taps and shower over, wash hand basin, WC, vanity light with shaver point, part tiled, extractor fan, radiator.

Rear Garden

Fence enclosed , planted borders, laid to lawn gated access to driveway, path to shed, shed, outside light.

Parking

Driveway parking for two cars.

Agent Notes

Please ask regarding charges, Currently leasehold but will become freehold on purchase.







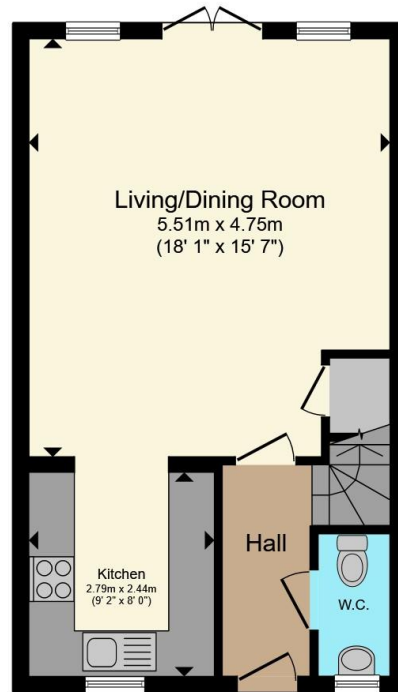

Ground Floor

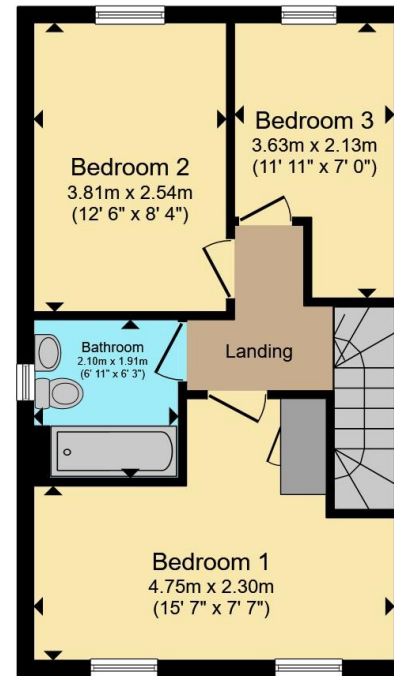

First Floor

Total floor area 79.8 m² (859 sq.ft.) approx

This floor plan is for illustrative purposes only. It is not drawn to scale. Any measurements, floor areas (including any total floor area), openings and orientation are approximate. No details are guaranteed, they cannot be relied upon for any purpose and they do not form part of any agreement. No liability is taken for any error, omission or misstatement. A party must rely upon its own inspection(s). Powered by www.propertybox.io



To view this property please contact Connells on

T 01954 714900
E cambourne@connells.co.uk

Unit 2 Caxton House Broad Street Great Cambourne
 CAMBRIDGE CB23 6JN

EPC Rating: C Council Tax Band: C

Service Charge: 240.00 Ground Rent: Ask Agent

Tenure: Leasehold

view this property online connells.co.uk/Property/CBN306738

This is a Leasehold property with details as follows; Term of Lease 125 years from 01 Sep 2013. Should you require further information please contact the branch. Please Note additional fees could be incurred for items such as

1. MONEY LAUNDERING REGULATIONS Intending purchasers will be asked to produce identification documentation at a later stage and we would ask for your co-operation in order that there will be no delay in agreeing the sale. 2. These particulars do not constitute part or all of an offer or contract. 3. The measurements indicated are supplied for guidance only and as such must be considered incorrect. Potential buyers are advised to recheck measurements before committing to any expense. 4. We have not tested any apparatus, equipment, fixtures, fittings or services and it is in the buyers interest to check the working condition of any appliances.

Connells Residential is registered in England and Wales under company number 1489613, Registered Office is Cumbria House, 16-20 Hockliffe Street, Leighton Buzzard, Bedfordshire, LU7 1GN. VAT Registration Number is 500 2481 05.



See all our properties at www.connells.co.uk | www.rightmove.co.uk | www.zoopla.co.uk

Property Ref: CBN306738 - 0006