



## SIDMOUTH ROAD, NW2

£575,000

This bright, three/four-bedroom property is situated on the third floor of a charming mansion block with lift access, arranged over 1,310sqft comprising a spacious reception room, separate eat-in kitchen, four

Three/Four Bedrooms  
Arranged over 1,310sqft  
Share Of Freehold

Garage Included In Purchase  
Communal Gardens  
Third Floor With Lift

# STEP INSIDE SIDMOUTH ROAD

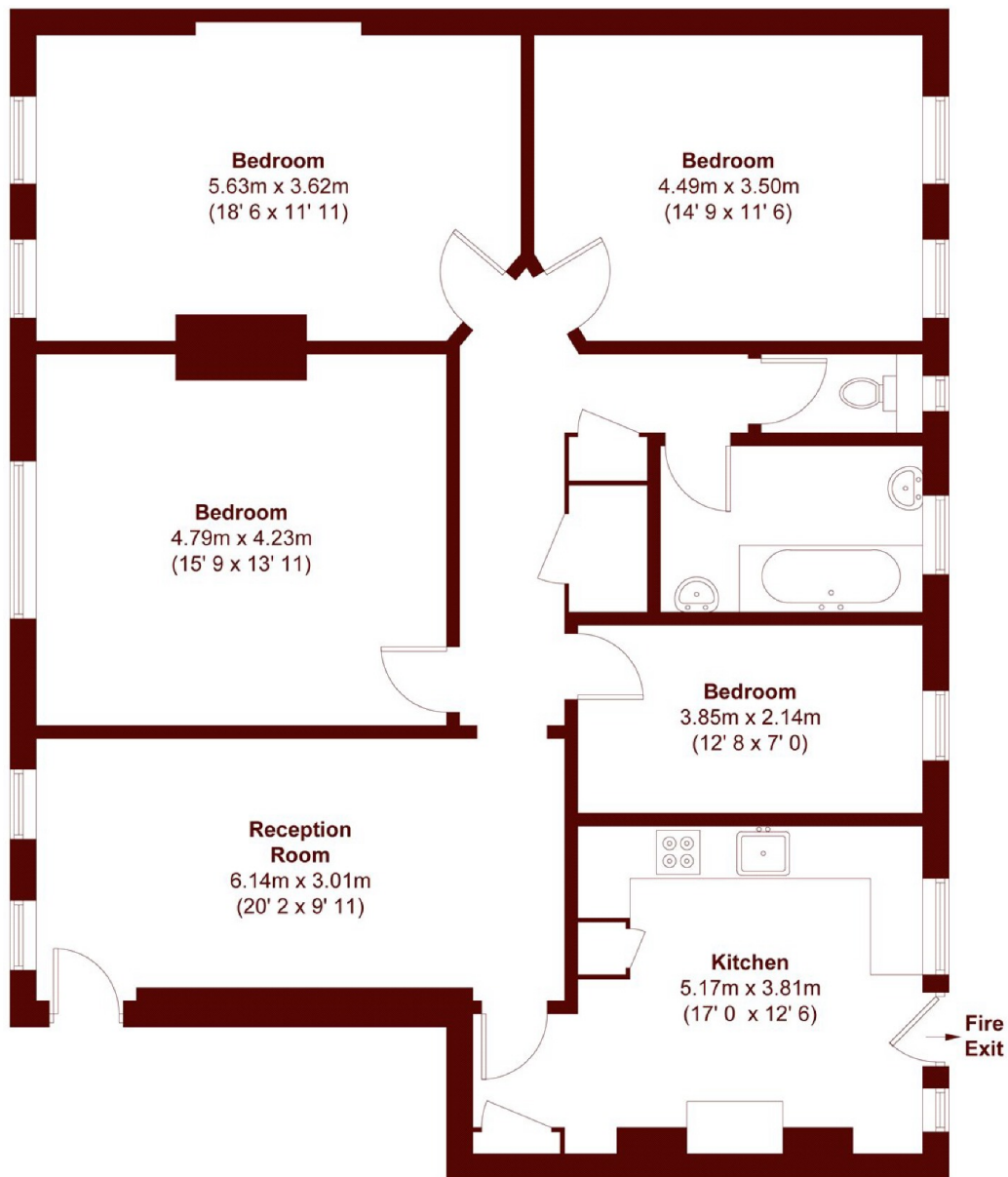

APPROX. GROSS INTERNAL FLOOR AREA  
1310 SQFT / 121.7 SQM

Willesden Green  
020 8451 0420

Energy Rating: D We aim to make our particulars both accurate and reliable. However, they are not guaranteed; nor do they form part of an offer or contract. If you require clarification on any points then please contact us, especially if you're traveling some distance to view. Please note that appliances and heating systems have not been tested and therefore no warranties can be given as to their good working order

MARSH &  
PARSONS