



Turnberry Close, Ilkeston, Derbyshire **Offers Over £145,000**







Turnberry Close, Ilkeston, Derbyshire

Offers Over £145,000

Property Description

A family home situated in a discrete cul de sac location on the popular Shipleby View estate. Tucked away with a driveway and garage, an open aspect to the side, this home must be viewed to be appreciated. The accommodation comprises in brief of an entrance hall, lounge open through to a modern fitted dining kitchen with Oak flooring, there is a conservatory and to the first floor two double bedrooms, master with an en-suite shower area and a family bathroom. We strongly recommend an internal inspection. A copy of the EPC will be available on request. EPC grade C.

Our View

Good size semi detached in sought after location having been improved by the current owners and tastefully decorated. Open plan dining kitchen with integrated appliances, sliding doors to conservatory with view of the garden, kitchen is open plan to lounge, solid Oak flooring to both. First floor three bedrooms, master with en-suite shower area and family bathroom. Rear low maintenance garden, patio, drive and detached garage.

Location

Situated on Shipleby View estate the property sides onto woodland, access to the 26 mile Nutbrook trail, five minutes walk away. Local amenities include a co-op store, bus routes to Ilkeston Nottingham and Derby. Commuter access to junction 26 of the M1.



EPC Grade C

For full EPC please contact the branch

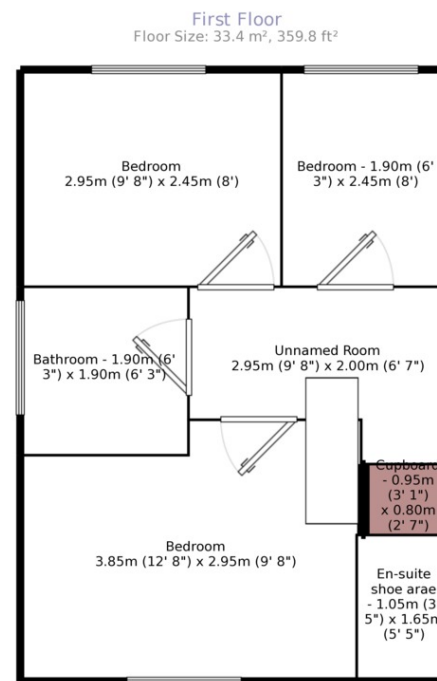
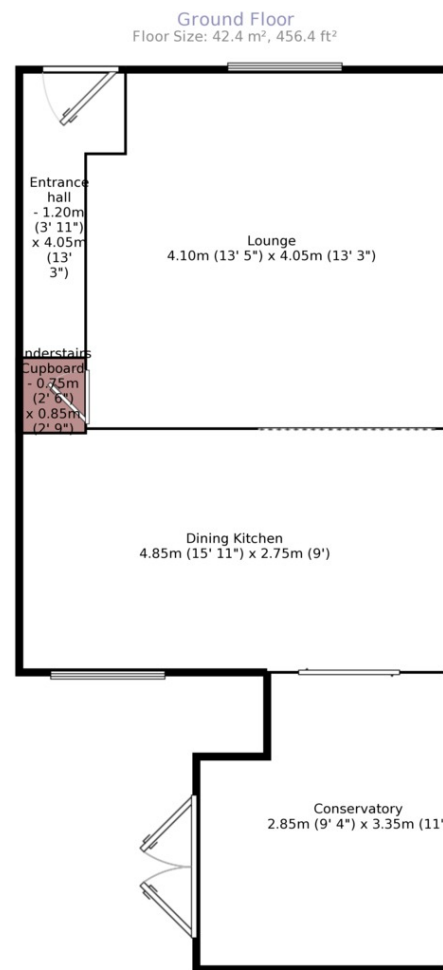

Measurements are approximate. Not to scale. For illustrative purposes only.

IMPORTANT NOTE TO PURCHASERS: We endeavour to make our sales particulars accurate and reliable, however, they do not constitute or form part of an offer or any contract and none is to be relied upon as statements of representation or fact. The services, systems and appliances listed in this specification have not been tested by us and no guarantee as to their operating ability or efficiency is given. All measurements have been taken as guide to prospective buyers only, and are not precise. Floor plans where included are not to scale and accuracy is not guaranteed. If you require clarification or further information on any points, please contact us, especially if you are travelling some distance to view. Fixtures and fittings other than those mentioned are to be agreed with the seller.

Your Move is a trading name of your-move.co.uk, registered in England at Newcastle House, Albany Court, Newcastle Business Park, Newcastle upon Tyne NE4 7YB (number 01864469).

45 Bath Street, Ilkeston, Derbyshire, DE7 8AH

0115 930 3813 * Ilkeston@your-move.co.uk

*Calls may be recorded and/or monitored for training and/or security purposes.

