



Redesmere Drive, Cheadle Hulme, SK8 5JY

£425,000

SNAPES
SALES & LETTINGS AGENTS





Redesmere Drive

Cheadle Hulme, Cheadle

Council Tax band: D

Tenure: Freehold

- Well Presented Three Bedroom Detached Bungalow
- No Onward Chain
- Modern Open Plan Kitchen Diner
- Good Sized Living Room
- Three Bedrooms & Bathroom
- Private Rear Garden
- Ample Driveway Parking & Garage
- Catchment For Oak Tree Primary & Cheadle Hulme High School
- Short Distance From Laurus
- Freehold





SNAPES

Living Room

19' 0" x 12' 2" (5.78m x 3.72m)

Kitchen Diner

18' 3" x 9' 5" (5.56m x 2.86m)

Master Bedroom

13' 0" x 10' 8" (3.96m x 3.26m)

Bedroom Two

11' 1" x 9' 9" (3.38m x 2.98m)

Bedroom Three

8' 7" x 8' 0" (2.62m x 2.44m)

Bathroom

9' 5" x 5' 5" (2.86m x 1.64m)

Garage



SNAPES
SALES & LETTINGS AGENTS



SNAPES
SALES & LETTINGS AGENTS

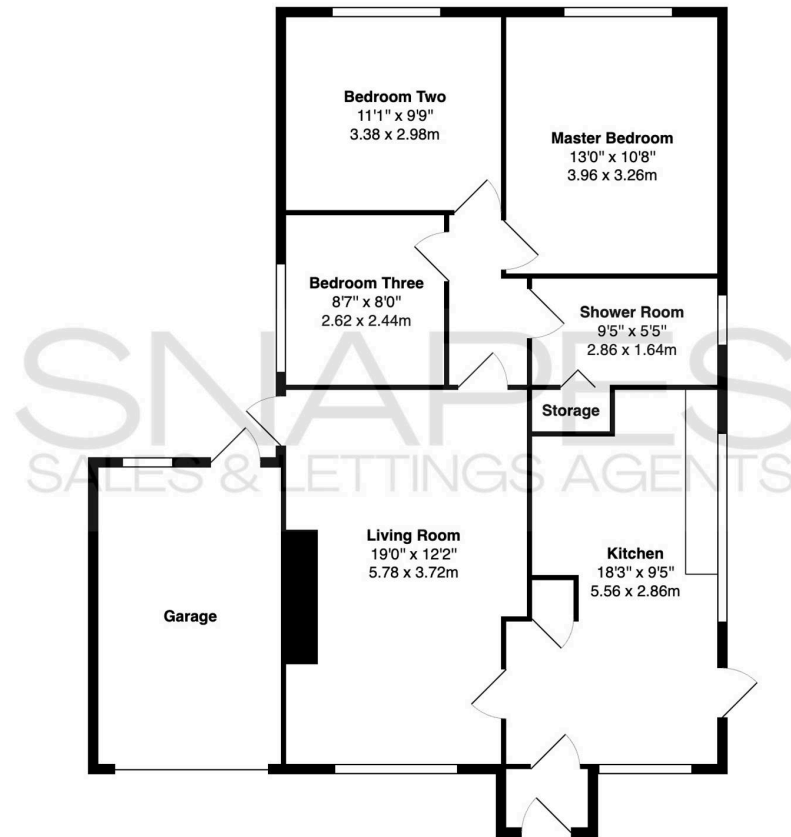

Approximate Total Area: 984 ft² ... 91.4 m²

All measurements are approximate.
The floorplan may not include chimney breasts or support nibs and/or very small recess areas.
If a total floor area is quoted, this will include ALL areas shown on the plan, inc garages.
The area is calculated by the software and is approximate.

Cheadle Hulme Office

Andrew Snape Estate Agents, 31 Station Road – SK8 5AF

0161 485 2244 • cheadlehulme@snapes.co.uk • www.snapes.co.uk/