



APARTMENT 21, MASTER WILLIAMS PLACE FOLKESTONE, CT20 1FF

£975 PER MONTH

Welcome to this exquisite one-bedroom apartment located in the heart of Master William's Place, Folkestone. This new build property, completed in 2025, offers a modern living experience with a generous space of 554 square feet.

As you enter, you will be greeted by a stylish reception room that provides a perfect setting for relaxation or entertaining guests. The apartment features a sleek German kitchen, equipped with high-quality Bosch appliances, ensuring that your culinary adventures are both enjoyable and efficient. The inclusion of a washer dryer and fridge freezer adds to the convenience of modern living, making this apartment an ideal choice for professionals or couples.

The bedroom is thoughtfully designed to provide a peaceful retreat, while the bathroom boasts contemporary fittings that enhance the overall appeal of the property.

**WEST END
ESTATES**
LETTINGS AND PROPERTY MANAGEMENT

Ground Floor

Approx. 51.5 sq. metres (554.9 sq. feet)

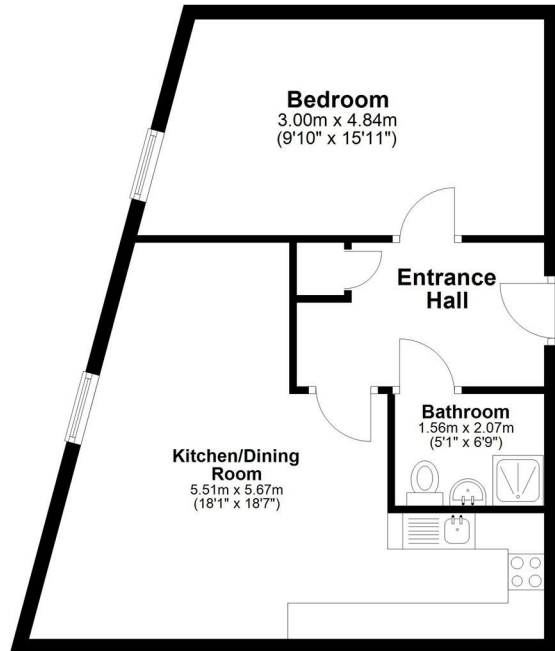

Total area: approx. 51.5 sq. metres (554.9 sq. feet)

Whilst every attempt has been made to ensure the accuracy of the floorplan contained here, measurements of doors, windows, rooms and any other items are approximate and no responsibility is taken for any error, omission or mis-statement. This plan is for illustrative purposes only and should be used as such by any prospective purchaser. The services, systems and appliances shown have not been tested and no guarantee as to their operability or efficiency can be given.
Plan produced using PlanUp.



Energy Efficiency Rating		
	Current	Potential
Very energy efficient - lower running costs		
(92 plus) A		
(81-91) B	83	
(69-80) C		
(55-68) D		
(39-54) E		
(21-38) F		
(1-20) G		
Not energy efficient - higher running costs		
England & Wales	EU Directive 2002/91/EC	

EPC Rating: B Council Tax Band: A

Agents Note: Whilst every care has been taken to prepare these particulars, they are for guidance purposes only. All measurements are approximate and are for general guidance purposes only and whilst every care has been taken to ensure their accuracy, they should not be relied upon and potential buyers/tenants are advised to recheck the measurements

West End Estates Folkestone
7 Sapper Row
Folkestone
Kent
CT20 3WT

01303 478777
office@westend-estates.co.uk

**WEST END
ESTATES**
LETTINGS AND PROPERTY MANAGEMENT